

# 56106

TOYOTA SIENNA

## WIRING LOCATION GUIDE GUÍA DE UBICACIÓN DEL CABLEADO IDE D'EMPLACEMENT DES FILS



### MUST READ FIRST!

All steps must be followed to ensure correct function of the T-Connector. To verify proper installation once installed, test by connecting a test light or properly wired trailer.

### ¡DEBE LEERSE PRIMERO!

Debe seguirse todos los pasos para asegurar el correcto funcionamiento del Conector-T. Para verificar la correcta instalación, pruebe conectando una luz de prueba o un remolque debidamente cableado.

### À LIRE D'ABORD!

Pour assurer le bon fonctionnement du T-Connector, il faut suivre toutes les étapes. Pour vérifier que l'installation a été bien effectuée, branchez un feu de test ou une remorque correctement filéée.

06/17/10

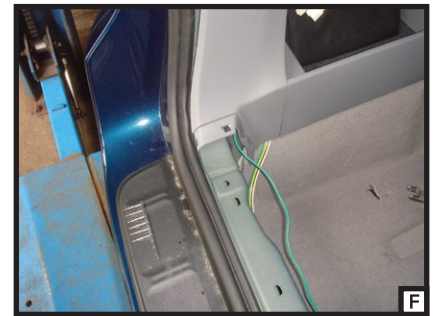
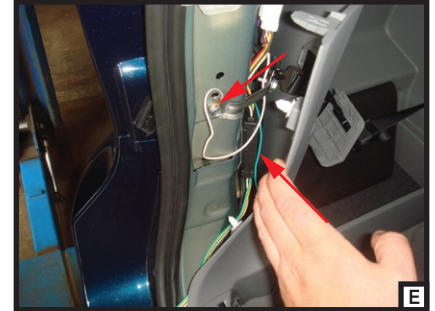
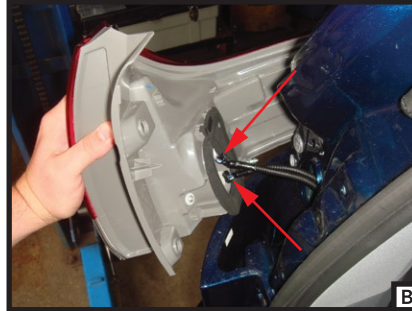

## English

1. Open the rear hatch. Remove both taillight assemblies by removing two 10mm bolts holding each in place.(A) Behind the taillights locate the vehicles taillight connectors.(B) The connectors will be similar to those on the T-connector harness. Separate the connectors being sure not to damage the locking tabs. Set taillight housings aside.

2. Inside the vehicle remove the vehicles rear scuff panel by removing the three tow hooks holding it in place and pulling up.(C) On both sides of the vehicle pull back on the rear trim panels.(D) Locate the opening that the wires go thru to the taillight.

3. Route the T-connector ends with the yellow and red wire out thru the opening and insert in between the separated connectors. Make sure the connectors are fully inserted with the locking tabs in place.

**WARNING!**  
Verify miscellaneous items that may be hidden behind or under any surface before drilling to avoid damage and/or personal injury.

4. Locate a suitable grounding point near the connector such as an existing screw with nut in the vehicle's frame or drill a 3/32" hole and secure white ground wire using eyelet and screw provided.(E)

5. Adhere the black converter box to the frame of the car using the double-sided tape provided.(E) Secure any loose parts of the T-connector with the cable ties provided.

6. Route the black power wire from the battery as shown on the CME-PCL-INS sheet included. In the rear of the vehicle route the black wire up thru the opening under the drivers side taillight.

7. Route the T-connector end with the green wire and the 4-flat out from under the rear trim panel.(F) Route the green wire across to the passenger side under the removed rear scuff panel. On the passengers side route the T-connector end with the green wire out the thru the opening. Repeat Step 3 on the passenger side using the green wire.

8. Route the 4-flat wire to the center of the vehicle and out the trunk when in use. When not in use roll up and store in an out of the way location in the rear cargo area.



56106