



# 13117 INSTALLATION INSTRUCTIONS



Safety glasses should be worn at all times while installing this product.

YEARS: 2012-PRESENT

MAKE: MERCEDES-BENZ

MODEL: ML350 including BLUETEC

STYLE: SUV

**WARNING: NEVER EXCEED YOUR VEHICLE MANUFACTURER'S RECOMMENDED TOWING CAPACITY**

## WEIGHT CARRYING:

TRAILER WEIGHT: 5,000 LBS.  
TONGUE WEIGHT: 600 LBS.

## WEIGHT DISTRIBUTION:

TRAILER WEIGHT: 6,000 LBS.  
TONGUE WEIGHT: 600 LBS.

INSTALLATION TIME: **40 MIN.**

THE INSTALL TIME LISTED IS FOR PROFESSIONAL INSTALLERS. IF YOU ARE HESITANT TO UNDERTAKE THIS TASK ON YOUR OWN, CONTACT AN AUTHORIZED CURT INSTALLER FOR ADDITIONAL ASSISTANCE.

## INSTALLATION TIPS:

1. BEFORE YOU BEGIN INSTALLATION, READ ALL INSTRUCTIONS THOROUGHLY.
2. TO EASE INSTALLATION, 2 PEOPLE MAY BE REQUIRED.
3. USING PROPER TOOLS WILL GREATLY IMPROVE THE QUALITY OF THE INSTALL AND REDUCE THE TIME REQUIRED.
4. NEED HELP OR HAVE SOME QUESTIONS? CALL TECHNICAL SUPPORT AT 800.798.0813

LEVEL OF DIFFICULTY: **MODERATE**

EASY

MODERATE

CHALLENGING



- NO DRILLING REQUIRED



- LOWER EXHAUST



- TRIM HEAT SHIELD









- PART REMOVAL

## VEHICLE PHOTO:



REPRESENTATIVE PHOTO

## INSTALLATION REQUIRES:

 RATCHET	 TORQUE WRENCH	 6" SOCKET EXTENSION
 8mm 10mm 13mm 16mm SOCKET	 3/4" SOCKET	 ROTARY TOOL

## HITCH ILLUSTRATION:

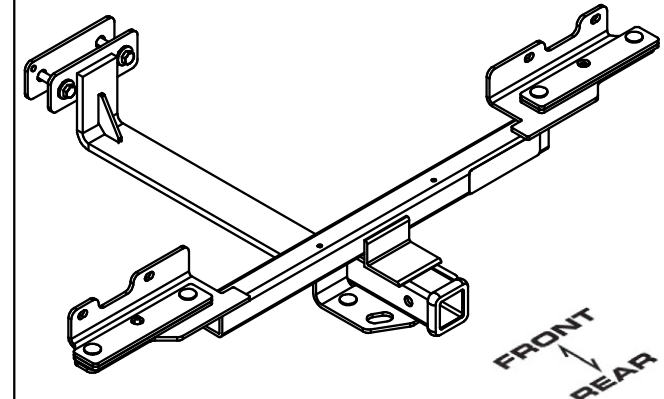

MAKE SURE YOUR HITCH MATCHES

**PERIODICALLY CHECK THIS RECEIVER HITCH TO ENSURE ALL FASTENERS ARE TIGHT AND ALL STRUCTURAL COMPONENTS ARE SOUND**

CURT Manufacturing LLC. warrants this product to be free of defects in material and/or workmanship at the time of retail purchase by the original purchaser. If the product is found to be defective, Curt Manufacturing LLC. may repair or replace the product at their option, when the product is returned, prepaid, with proof of purchase. Alteration to, misuse of, or improper installation of this product voids the warranty. Curt Manufacturing LLC.'s liability is limited to repair or replacement of products found to be defective, and specifically excludes liability for incidental or consequential loss or damage.

For more information log onto [www.curtmfg.com](http://www.curtmfg.com), & for helpful towing tips log onto [www.hitchinfo.com](http://www.hitchinfo.com)

3/29/2013

## INSTALLATION WALKTHROUGH:

Parts List			
ITEM	QTY	PART NUMBER	DESCRIPTION
1	2	1/2	CONICAL TOOTHED WASHER
2	2	1/2-13 x 1	CARRIAGE BOLT
3	4	1/2-13 x 1 1/2	CARRIAGE BOLT
4	2	1/2-13 x 3	HEX BOLT
5	2	11120497	.344" X .813" BLACK NYLON TRIM PANEL RETAINER
6	2	3/8"	CONICAL TOOTHED WASHER
7	6	HFN 1213	HEX FLANGE NUT
8	2	M8 - 1.25 x 30 HEX BOLT	HEX HEAD BOLT
9	1	M8-1.25 x 40	HEX BOLT

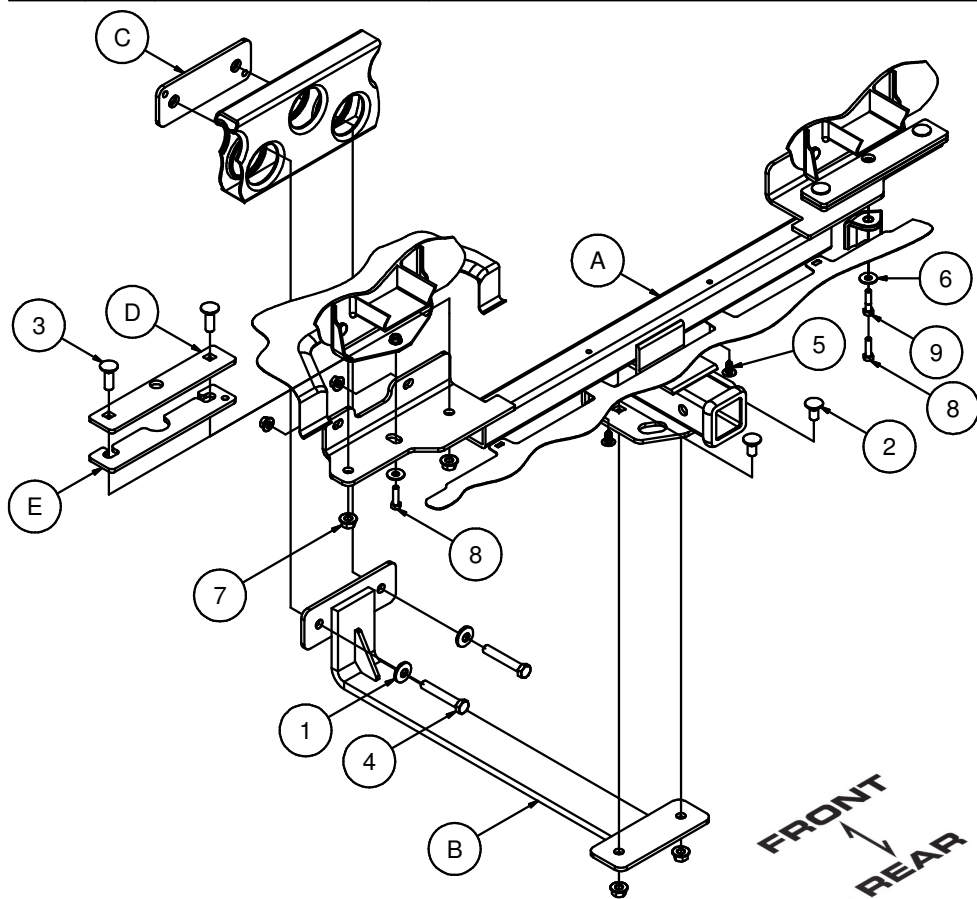

Parts List			
ITEM	QTY	PART NUMBER	DESCRIPTION
A	1	13117-WA	HITCH WELDMENT ASSEMBLY
B	1	13117-MSWA	MOUNTING STRAP WELDMENT ASSEMBLY
C	1	13117-NPA	NUT PLATE ASSEMBLY
D	2	13117-BP	.250" BOLT PLATE
E	2	13117-SP	.250" SPACER PLATE

### CONICAL TOOTHED WASHER ORIENTATION DIAGRAM

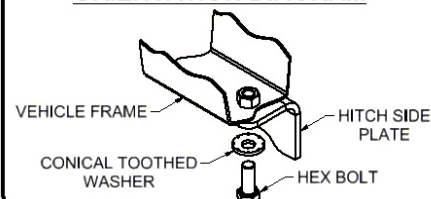

### RUBBER ISOLATOR REMOVAL DIAGRAM

This technique can be used if an Exhaust Hanger Removal Pliers is not available.

Using a 5/8" open end wrench, slide the wrench up to the rubber isolator, cradling the hanger rod as shown. Next place the flat edge of a pry bar between the wrench and the hanger stop or hanger rod. Then simply rotate the pry bar toward the wrench to remove the rubber isolator.

Note: Using a spray lubricant or soapy water on the hanger rod and the rubber isolator helps removal.

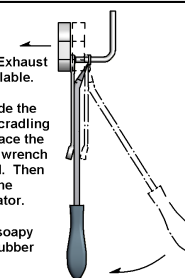

1. Locate and remove DEF tank shield by removing (6) 10mm plastic flange nuts. (BlueTEC Models Only)

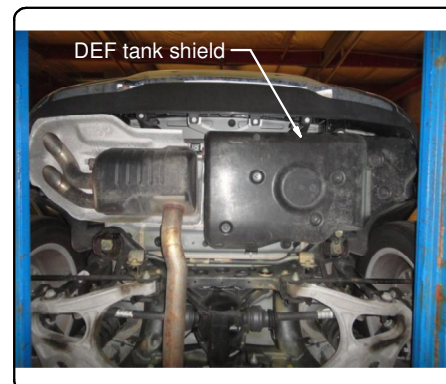

## INSTALLATION WALKTHROUGH:

2. Remove the (3) bumper fascia tab brackets by removing the (4) 10mm screws in the lower bumper fascia tabs and the (5) 10mm washer nuts. Return brackets and hardware to owner.

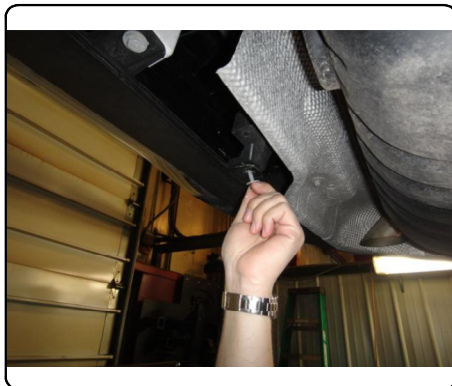

- ↓
3. Lower the driver side exhaust by removing the rubber isolator from the hanger attached to the vehicle and unbolting the exhaust hanger bracket. Repeat on passenger side if present. Support exhaust to prevent damage. (See Rubber Isolator Removal Diagram)

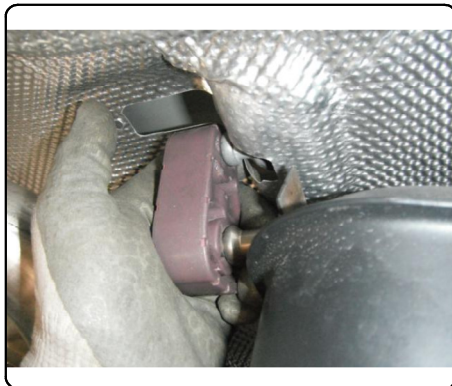

- 
4. Remove the driver side heat shield by removing the (3) 8mm formed nuts and (1) 8mm bolt. Repeat on passenger side if present.



- ↓
5. If present, remove the rear most 13mm bolt holding DEF tank and the rear most 13mm nut securing the strap. Support DEF tank to prevent damage.





## INSTALLATION WALKTHROUGH:

6. Remove the lower (2) M10 nuts securing the bumper beam to the vehicle, both sides.



7. Trim and reinstall heat shield(s). (See Trim Diagram)  
**Note:** Dimensions are approximate, confirm fit prior to trimming. Use rib in panel as a cutting guide.

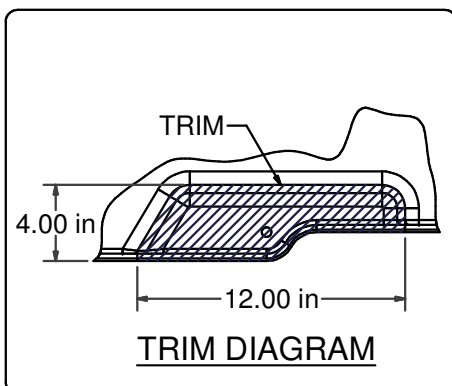

8. Raise hitch (A) into position and secure to the bumper beam studs using M10 nuts removed in Step (6).



9. Stack bolt plate (D) on spacer plate (E) and run 1/2-13 x 1 1/2" carriage bolts through plate holes. Place plate assembly over the bumper beam tab and align with the holes in the hitch. Secure using 1/2-13 flange nuts, as shown.

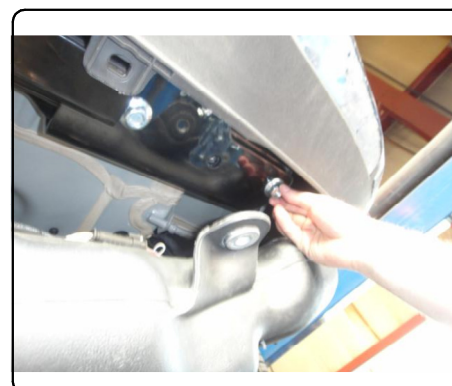
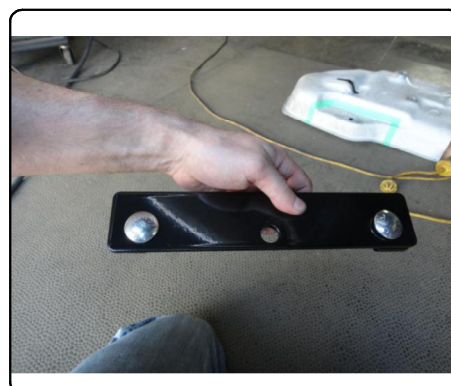

## INSTALLATION WALKTHROUGH:

10. Center the holes of the hitch with the bumper beam tab weldnuts. Torque all M10 fasteners to 48 ft-lbs. Torque all installed 1/2" fasteners to 110 ft-lbs.



11. If present, raise DEF tank and secure the mounting strap using hardware removed in Step (5). Secure DEF tank mounting tab using M8-1.25 x 40mm hex bolt and 3/8" conical toothed washer. Secure driver side using M8-1.25 x 30mm hex bolt and 3/8" conical toothed washer. Torque M8 hardware to 23 ft-lbs.



12. Raise and secure the exhaust lowered in Step (3). Reinstall DEF tank shield removed in Step (1).



13. Raise mounting strap (B) into position and loosely secure to hitch 1/2-13 x 1" carriage bolts and 1/2-13 hex flange nuts. Raise nut plate (C) into position and secure mounting strap to the cross member using 1/2-13 x 3" hex bolts and 1/2" conical toothed washers.

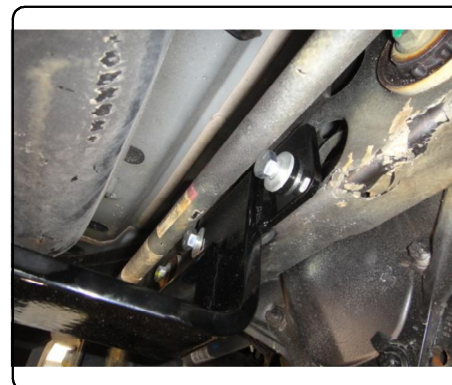
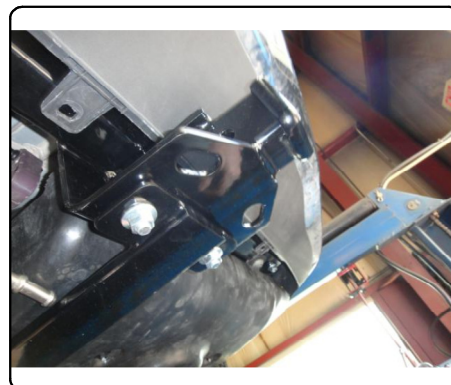



## INSTALLATION WALKTHROUGH:

14. Torque all remaining 1/2" hardware to 110 ft-lbs.

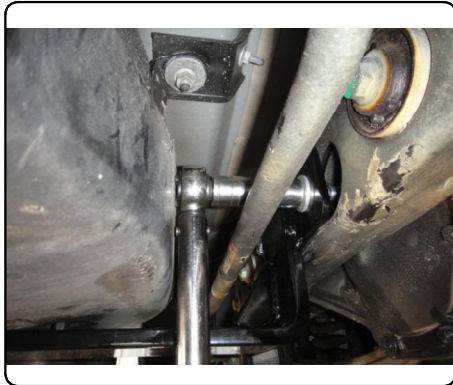
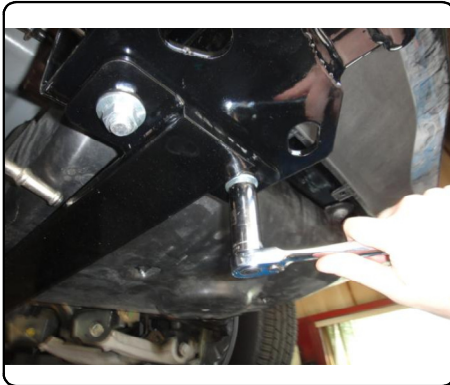

15. Secure the (2) center fascia tabs by pushing the nylon retainer clips into the holes in hitch tube.



INSTALLATION COMPLETE

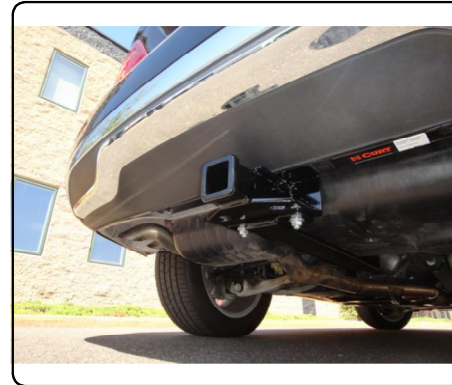

For more information log onto [www.curtmfg.com](http://www.curtmfg.com), & for helpful towing tips log onto [www.hitchinfo.com](http://www.hitchinfo.com)

13117

## MERCEDES-BENZ ML350 including BLUETEC

3/29/2013

GROSS LOAD CAPACITY WHEN USED AS A WEIGHT CARRYING HITCH: 5,000 LBS. TRAILER WEIGHT & 600 LBS. TONGUE WEIGHT.  
GROSS LOAD CAPACITY WHEN USED AS A WEIGHT DISTRIBUTION HITCH: 6,000 LBS. TRAILER WEIGHT & 600 LBS. TONGUE WEIGHT

\*\*\*DO NOT EXCEED VEHICLE MANUFACTURER'S RECOMMENDED TOWING CAPACITY.\*\*\*

HAVING INSTALLATION QUESTIONS? CALL TECHNICAL SUPPORT AT 1-800-798-0813

Hardware List			
ITEM	QTY	PART NUMBER	DESCRIPTION
1	2	1/2	CONICAL TOOTHED WASHER
2	2	1/2-13 x 1	CARRIAGE BOLT
3	4	1/2-13 x 1 1/2	CARRIAGE BOLT
4	2	1/2-13 x 3	HEX BOLT
5	2	11120497	.344" X .813" BLACK NYLON TRIM PANEL RETAINER
6	2	3/8"	CONICAL TOOTHED WASHER
7	6	HFN 1213	HEX FLANGE NUT
8	2	M8 - 1.25 x 30	HEX HEAD BOLT
9	1	M8-1.25 x 40	HEX BOLT

Parts List			
ITEM	QTY	PART NUMBER	DESCRIPTION
A	1	13117-WA	HITCH WELDMENT ASSEMBLY
B	1	13117-MSWA	MOUNTING STRAP WELDMENT ASSEMBLY
C	1	13117-NPA	NUT PLATE ASSEMBLY
D	2	13117-BP	.250" BOLT PLATE
E	2	13117-SP	.250" SPACER PLATE

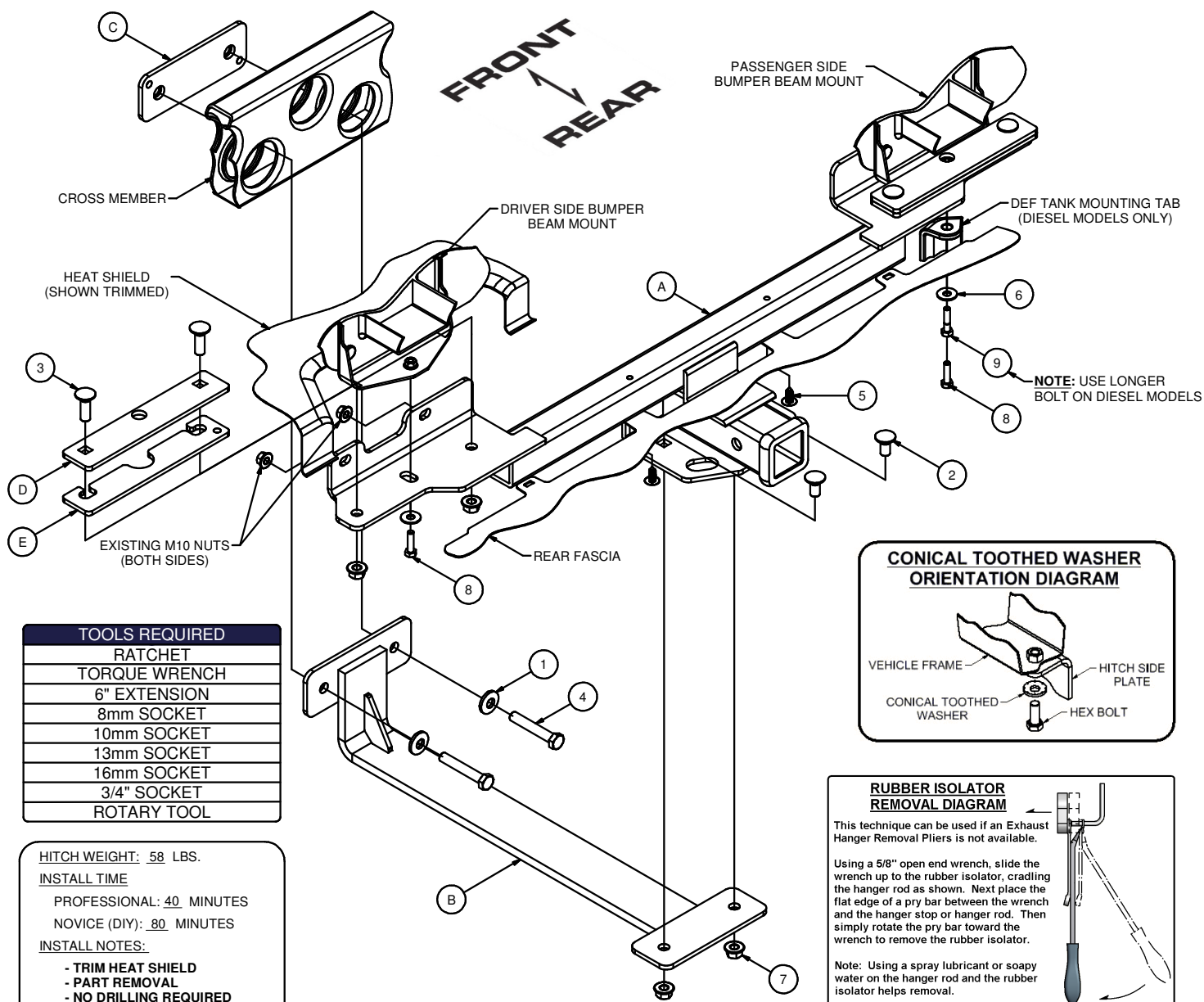

## TOOLS REQUIRED

RATCHET  
TORQUE WRENCH  
6" EXTENSION  
8mm SOCKET  
10mm SOCKET  
13mm SOCKET  
16mm SOCKET  
3/4" SOCKET  
ROTARY TOOL

HITCH WEIGHT: 58 LBS.

## INSTALL TIME

PROFESSIONAL: 40 MINUTES

NOVICE (DIY): 80 MINUTES

## INSTALL NOTES:

- TRIM HEAT SHIELD
- PART REMOVAL
- NO DRILLING REQUIRED
- LOWER EXHAUST

**PERIODICALLY CHECK THIS RECEIVER HITCH TO ENSURE THAT ALL FASTENERS ARE TIGHT AND THAT ALL STRUCTURAL COMPONENTS ARE SOUND.**

Curt Manufacturing LLC., warrants this product to be free of defects in material and/or workmanship at the time of retail purchase by the original purchaser. If the product is found to be defective, Curt Manufacturing LLC., may repair or replace the product, at their option, when the product is returned, prepaid, with proof of purchase. Alteration to, misuse of, or improper installation of this product voids the warranty. Curt Manufacturing LLC.'s liability is limited to repair or replacement of products found to be defective, and specifically excludes liability for incidental or consequential loss or damage.

GROSS LOAD CAPACITY WHEN USED AS A WEIGHT CARRYING HITCH: 5,000 LBS. TRAILER WEIGHT & 600 LBS. TONGUE WEIGHT.  
GROSS LOAD CAPACITY WHEN USED AS A WEIGHT DISTRIBUTION HITCH: 6,000 LBS. TRAILER WEIGHT & 600 LBS. TONGUE WEIGHT

**\*\*\*DO NOT EXCEED VEHICLE MANUFACTURER'S RECOMMENDED TOWING CAPACITY.\*\*\***

HAVING INSTALLATION QUESTIONS? CALL TECHNICAL SUPPORT AT 1-800-798-0813

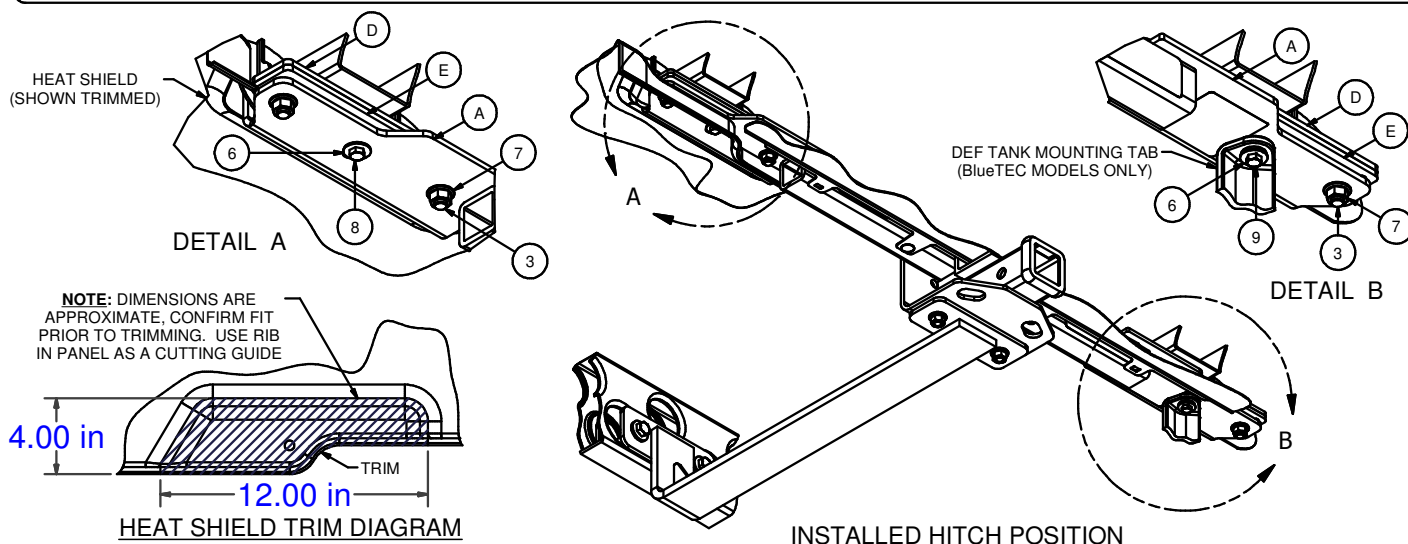

## INSTALLATION STEPS

1. Locate and remove DEF tank shield by removing (6) 10mm plastic flange nuts. (BlueTEC Models Only)
2. Remove the (3) bumper fascia tab brackets by removing the (4) 10mm screws in the lower bumper fascia tabs and the (5) 10mm washer nuts. Return brackets and hardware to owner.
3. Lower the driver side exhaust by removing the rubber isolator from the hanger attached to the vehicle and unbolting the exhaust hanger bracket. Repeat on passenger side if present. Support exhaust to prevent damage. (See Rubber Isolator Removal Diagram)
4. Remove the driver side heat shield by removing the (3) 8mm formed nuts and (1) 8mm bolt. Repeat on passenger side if present.
5. If present, remove the rear most 13mm bolt holding DEF tank and the rear most 13mm nut securing strap. Support DEF tank to prevent damage.
6. Remove the lower (2) M10 nuts securing the bumper beam to the vehicle, both sides.
7. Trim and reinstall heat shield(s). (See Trim Diagram) **Note:** Dimensions are approximate, confirm fit prior to trimming.
8. Raise hitch (A) into position and secure to the bumper beam studs using M10 nuts removed in Step (6).
9. Stack bolt plate (D) on spacer plate (E) and run 1/2-13 x 1 1/2" carriage bolts through plate holes. Place plate assembly over the bumper beam tab and align with the holes in the hitch. Secure using 1/2-13 flange nuts, as shown.
10. Center the holes of the hitch with the bumper beam tab weldnuts. Torque all M10 fasteners to 48 ft-lbs. Torque all installed 1/2" fasteners to 110 ft-lbs.
11. If present, raise DEF tank and secure the mounting strap using hardware removed in Step (5). Secure DEF tank mounting tab using M8-1.25 x 40mm hex bolt and 3/8" conical toothed washer. Secure driver side using M8-1.25 x 30mm hex bolt and 3/8" conical toothed washer. Torque M8 hardware to 23 ft-lbs.
12. Raise and secure the exhaust lowered in Step (3).
13. Reinstall DEF tank shield removed in Step (1).
14. Raise mounting strap (B) into position and loosely secure to hitch 1/2-13 x 1" carriage bolts and 1/2-13 hex flange nuts.
15. Raise nut plate (C) into position and secure mounting strap to the cross member using 1/2-13 x 3" hex bolts and 1/2" conical toothed washers.
16. Torque all remaining 1/2" hardware to 110 ft-lbs.
17. Secure the (2) center fascia tabs by pushing the nylon retainer clips into the holes in hitch tube.

**PERIODICALLY CHECK THIS RECEIVER HITCH TO ENSURE THAT ALL FASTENERS ARE TIGHT AND THAT ALL STRUCTURAL COMPONENTS ARE SOUND.**