

11154

02-04 ACURA RSX

8/17/2009

GROSS LOAD CAPACITY WHEN USED AS A WEIGHT CARRYING HITCH: 2,000 LBS. TRAILER WEIGHT & 200 LBS. TONGUE WEIGHT.

*****DO NOT EXCEED VEHICLE MANUFACTURER'S RECOMMENDED TOWING CAPACITY.*****

WARNING: ALL NON-TRAILER LOADS APPLIED TO THIS PRODUCT MUST BE SUPPORTED BY AUXILIARY STABILIZING STRAPS.

**** FAILURE TO PROPERLY SUPPORT NON-TRAILER LOADS WILL VOID PRODUCT WARRANTY****

HAVING INSTALLATION QUESTIONS? CALL TECHNICAL SUPPORT AT 1-800-798-0813

Parts List			
ITEM	QTY	PART NUMBER	DESCRIPTION
1	1	CM-438-FW	7/16" FISHWIRE TOOL
2	2	7_16 - 14 x 1 1_2	ELBOW HEX
3	2	7/16-14	HEX NUT
4	2	7/16	HELICAL LOCK WASHER
5	2	7/16	WASHER
6	1	1/2-13 x 2"	HEX BOLT
7	1	1_2 - 13	NYLOCK HEX NUT
8	2	CM-SP120	.188 x 1.00 SPACER
9	1	CM-SP128	.375 x 1.50" SPACER

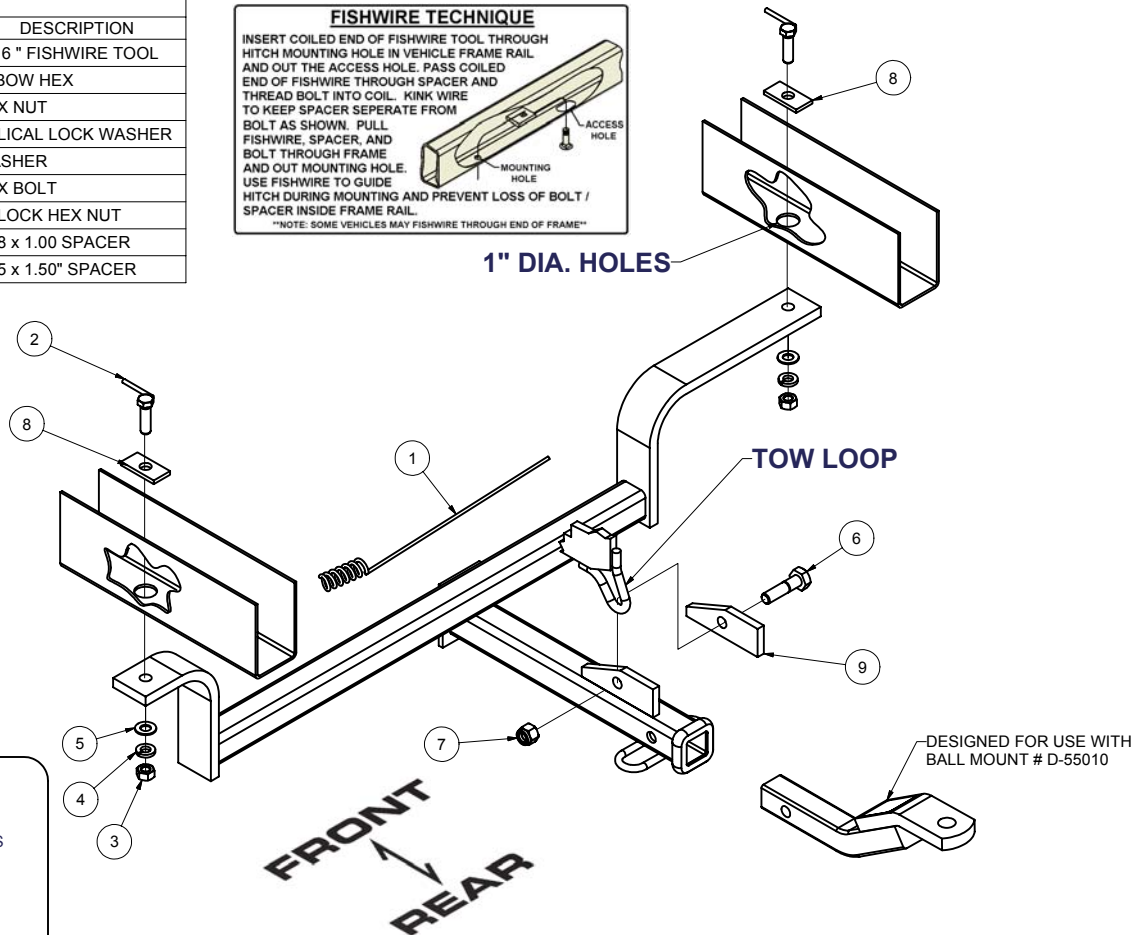
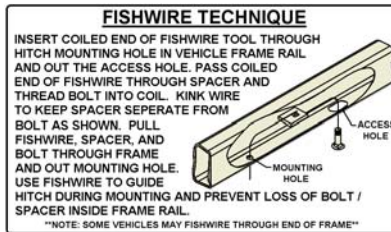

HITCH WEIGHT: 26.5 LBS.

INSTALL TIME

PROFESSIONAL: 20 MINUTES

NOVICE (DIY): 40 MINUTES

INSTALL NOTES:

- NO DRILLING REQUIRED
- LOWER EXHAUST
- FISHWIRE HARDWARE

INSTALLATION STEPS

- 1) Temporarily lower the muffler \ tail pipe by disconnecting the two (2) rear most hangers
- 2) Using the fish wire, place the 7/16 elbow bolts into the 1" holes in the frame. While the fish wire is still holding the bolt slide the spacer plate (#12) over the handle of the fish wire and through the 1" hole in the frame. Then pull the 7/16 bolts back through the spacer plate. (Spacer and bolt need to go in separately and be lined up while inside the frame rail.)
- 3) Being careful not to push the bolts back into the frame, carefully raise the hitch into position. Install the remaining 7/16 hardware as shown. Do NOT tighten at this time.
- 4) Insert 1/2 bolt through "separate" tow loop plate (#11), raise the hitch to the level position and slide bolt through the tow loop and the attached tow loop plate. Fasten into position with remaining 1/2" hardware.
- 5) In the reverse of these instructions, tighten all hardware to the following specifications and reattach muffler.
 - 7/16 = 50 ft-lbs
 - 1/2 = 75 ft-lbs

PERIODICALLY CHECK THIS RECEIVER HITCH TO ENSURE THAT ALL FASTENERS ARE TIGHT AND THAT ALL STRUCTURAL COMPONENTS ARE SOUND.

Curt Manufacturing Inc., warrants this product to be free of defects in material and/or workmanship at the time of retail purchase by the original purchaser. If the product is found to be defective, Curt Manufacturing Inc., may repair or replace the product, at their option, when the product is returned, prepaid, with proof of purchase. Alteration to, misuse of, or improper installation of this product voids the warranty. Curt Manufacturing Inc.'s liability is limited to repair or replacement of products found to be defective, and specifically excludes liability for incidental or consequential loss or damage.

249413 / 247413