



BX2523 2007-09 Mazda 3 Installation Instructions

Serial Number

Please read BOTH these Installation Instructions and the General Towing Instructions before attempting to install or operate this equipment.

- Blue Ox® towing products and accessories are intended to be installed by Blue Ox® Dealers who are familiar with our products and have the equipment and knowledge to do “fit work”. When necessary, Blue Ox® Dealers can be found at www.blueox.com or by contacting our Customer Care Department at (402) 385-3051.
- Many Blue Ox® Baseplates are designed to use existing holes and hardware to mount the baseplate to the towed vehicle. Even though bolts are there, do not assume they are adequate for baseplate mounting. Always use hardware supplied in the hardware kit or existing hardware specified in the Baseplate Installation Instructions.

Attachment Tab Height: 12 1/2”

Attachment Tab Width: 24”

Bolt Torque Specifications
Torque in Foot-Pounds for Metric Bolts

Bolt Size	Grade 8.8	Grade 10.9
6MM	6	8
8MM	16	22
10MM	31	40
12MM	54	70
14MM	89	117

Confirm the towability and pre-towing procedures for your vehicle with the owner’s manual or contact the vehicle’s manufacturer for specific towing procedures.

Bolt Torque Specifications
Torque in Foot-Pounds for Inch Bolts

Bolt Size	Grade 5	Grade 8
1/4”	10	14
5/16”	19	29
3/8”	33	47
7/16”	54	78
1/2”	78	119
5/8”	154	230



If the front of your vehicle looks different than this, call us at (402) 385-3051.

! WARNING

Failure to read and follow these instructions could result in separation of the towed vehicle from the tow bar, causing property damage, loss of towed vehicle, personal injury or death.

BX2523
2007-09 Mazda 3
Installation Instructions

Parts List

Ref. No.	Qty.	Part #	Description
1	1	61-6335	Weldment, Baseplate, BX2523
2	7	61-5208	3/8" Nut Plate, with Wire
3	7	201-0368	3/8-16 x 1 1/4" Hex Bolts, Grd. 5, ZP
4	7	203-0010	3/8" Lock Washer, ZP
5	1	201-0378	8mm-1..25 x 25mm Hex Bolt, ZP
6	2	201-0979	#12-14 x 1" Self Drilling Screw, ZP
7	2	201-0192	#10-32 x 1/2 Slot, Rd. Hd. Screw
8	2	203-0054	#10 Lock Washer
9	2	202-0047	#10-32 Hex Nut
10	2	101-5822	Adapter, 4 Way Connector
11	2	62-3469	Attachment, Assembly, SF/LB (R)
	2	290-0437	Cap Plug, Black (Not Shown)
	2	226-0046	Permanent Baseplate Sfty Cbls (Not Shown)
	2	229-0359	Quick Link, ZP (Not Shown)

Tools Required

Loctite® RED
 8mm Socket
 10mm Socket
 12mm Socket
 9/16" Socket
 13/32" Drill Bit
 Phillips Screwdriver
 Flat Screwdriver
 Utility Knife
 Tape Measure
 1-1/4" Hole Saw
 Hammer

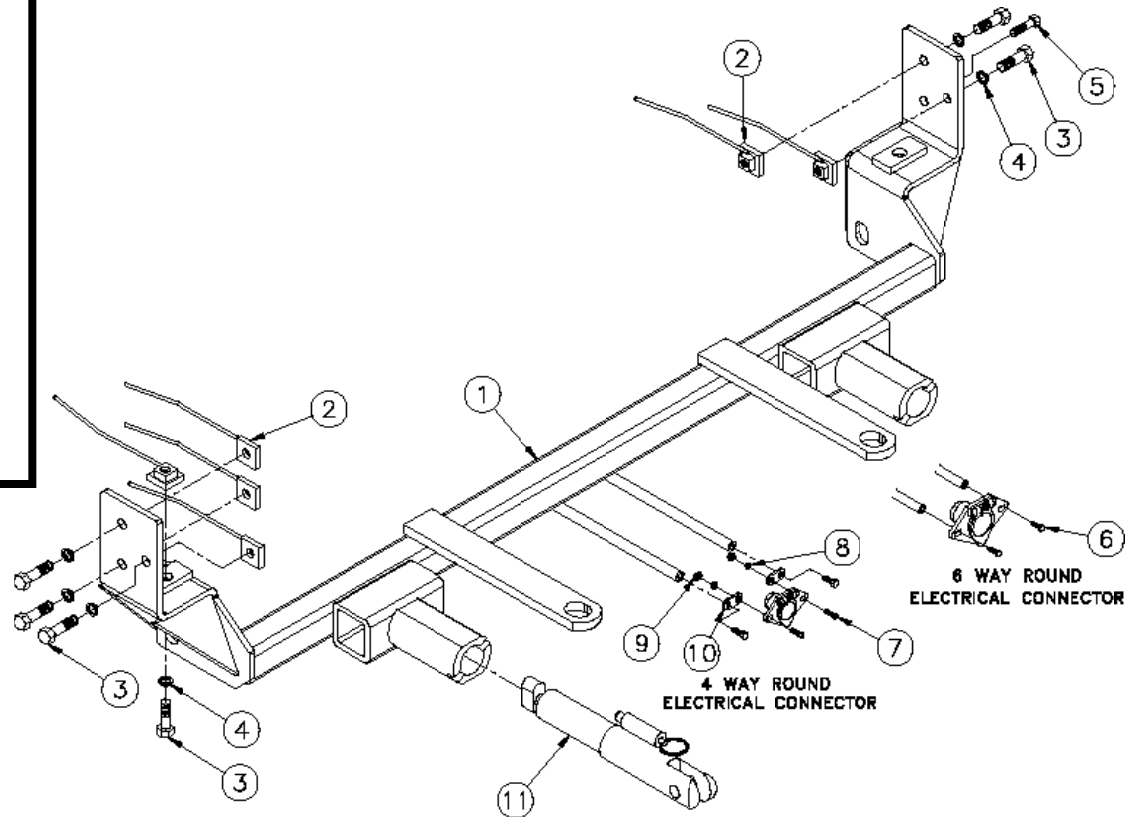

Important:

Use only genuine factory replacement parts on your baseplate. Do **NOT** substitute homemade or non-typical parts. If a bolt is lost or in need of replacement, for your safety and the preservation of your baseplate, be sure to use a replacement bolt of the same grade (In most cases it will be Grade 5, please reference the parts list above). Replacement parts may be ordered through your nearest Blue Ox® Dealer or Distributor. Failing to follow and/or altering these installation instructions in either installation or required equipment will void the manufacturer's warranty.

BX2523
2007-09 Mazda 3
Installation Instructions

Attachment Tabs:

Due to the design of the removable tabs, the RangeFinderII tow bar can not be used. Adapters, except the BX8833 and BX88151, can not be used with this baseplate.

Installation Notes: The fascia, foglights, air dams, horn bracket, windshield washer reservoir and temperature sensor are removed for baseplate installation. Trimming of the air dams and grille is required. Drilling is required.

The dimensional variations between otherwise identical vehicles can be considerable. While the baseplate was designed for easy installation, it may be necessary to tailor the baseplate slightly to compensate for auto manufacturer's tolerances. These minor adjustments may include filing a hole slightly, bending electrical rods, and/or bending end plates.

The BX8848 4-Diode Wiring Kit is recommended for this vehicle.

Handling of some cosmetic parts when installing this product may require the use of protective covers, rags, specialty tools, etc. to prevent damage.

Installation Instructions:



1. Remove two phillips screws from the top of the fascia (see white arrows). Using the flat screwdriver, pry up the pushpin tabs on top of the fascia to release and remove them (see grey arrows). Set screws and pushpins aside to be reinstalled later.



2. Remove one phillips pushpin (see white arrow) and one phillips screw (see grey arrow) from inside the wheel well, just forward of the front tire. Repeat for both sides of the vehicle. Set pushpin and screw aside to be reinstalled later.

BX2523
2007-09 Mazda 3
Installation Instructions



3. Pull wheel well cover aside to remove one metric bolt from fascia using the 8mm socket. Repeat for both sides of the vehicle. Set metric bolts aside to be reinstalled later.



4. Using the 8mm socket, remove eleven metric bolts from the underside of fascia (four each side and three from the center). Lift up on tabs behind the top edge of fascia, pull fascia corners out to release clips and then forward to remove fascia. Disconnect foglights (if applicable). Set metric bolts and fascia aside to be reinstalled later.



5. On the driver's side, remove one metric bolt from the horn bracket using the 12mm socket. Disconnect electrical. Set horn bracket and metric bolt aside to be reinstalled later.



6. Using the vice grips, bend the bracket on the back side of the bumper out toward the front of the vehicle. Repeat for both sides of the vehicle.

BX2523
2007-09 Mazda 3
Installation Instructions



7. On the passenger's side, remove one metric bolt from the washer reservoir using the 10mm socket. Set metric bolt aside to be reinstalled later.



8. On the passenger's side washer reservoir, mark 1/4" in on the reservoir tab and trim away with the utility knife. Reinstall the washer reservoir to its original location.



9. On the driver's side air dam, measure and mark 3 1/4" down from the top edge of the air dam and 2 1/2" in from the outside edge. Trim away the area with the utility knife. Repeat for both sides of the vehicle (NOTE: Cut all the way back to the webbing on the passenger's side air dam).

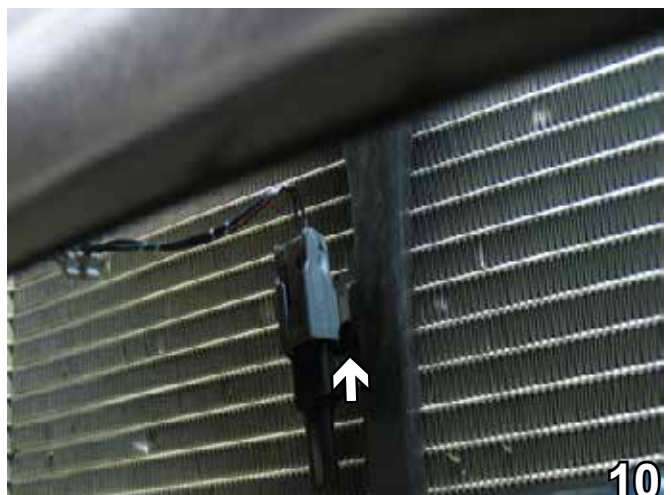

10. Just in front of the radiator, release the clips and disconnect the temperature sensor. Reinstall to existing hole just above original location.

BX2523
2007-09 Mazda 3
Installation Instructions



11. Using the hammer, flatten back the webbing along the lower edge of the frame rail. Repeat for both sides of the vehicle.



12. Using the 1 1/4" hole saw, drill an opening into the side of the frame rail. Repeat for both sides of the vehicle.

BE SURE TO USE LOCTITE® RED ON ALL BOLTS BEFORE TIGHTENING. TIGHTEN ALL BOLTS ACCORDING TO THE TORQUE CHART ON THE FRONT PAGE OF THESE INSTRUCTIONS OR ON PAGE 3 OF THE BASEPLATE TOWING GENERAL INSTRUCTIONS.

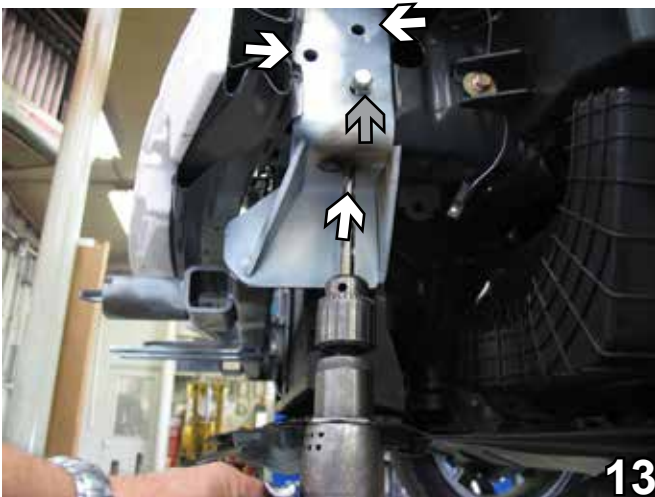

13. Slide the baseplate onto the frame rails and align lower endplate hole with existing hole for horn bracket on the driver's side and clamp in place. Using the baseplate as a template, drill holes into the frame rail (see white arrows) with the 13/32" drill bit. Repeat for both sides of the vehicle (NOTE: All three endplate holes must be drilled in the passenger side).

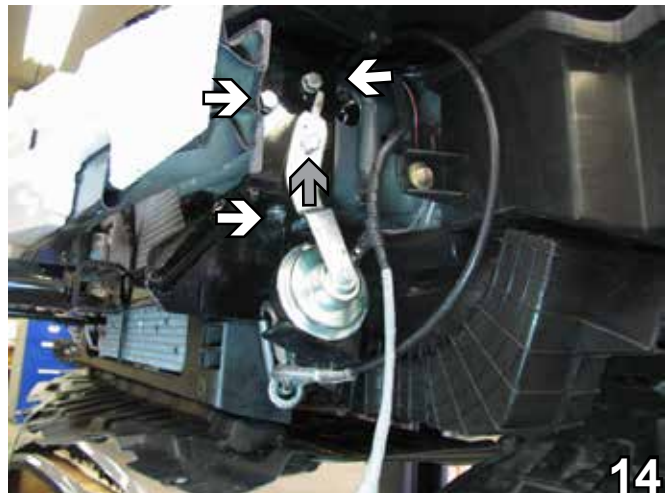

14. Insert the 3/8" nut plates into the frame rail to align with baseplate holes (see white arrows). Starting with the hole on the bottom of the frame, install 3/8-16 x 1 1/4" hex bolts and 3/8" lock washers and tighten to nut plates. Repeat for both sides of the vehicle. On the driver's side, reattach the horn bracket to its original location using the 8mm x 1.25 x 25mm hex bolt (see grey arrow).

BX2523
2007-09 Mazda 3
Installation Instructions



15. Attach the permanent baseplate safety cables to the provided convenience link on the baseplate (see white arrow). The photo above shows the recommended installation of the permanent baseplate safety cables to frame of the vehicle (see grey arrow). If the vehicle has additional options, not shown above, which interfere with mounting the permanent baseplate safety cables, secure the cable to a solid piece of the vehicle's frame as described in the instructions included with the permanent baseplate safety cables.



16. Hold the fascia up to its original position, mark and trim the grille to allow the attachment tabs and convenience links to come through.

17. Reinstall the foglights, fascia, pushpins, screws and bolts.

Install the tow bar and safety cables according to the instructions provided in their packages. When demonstrating this to the customer, be sure to include all the contents and packages.

Do **NOT** substitute other devices if the tow bar pins and clips are misplaced.

Be sure that **ALL** electrical connections are plugged in properly and functioning **BEFORE** installing the fascia.

DEALER or INSTALLER:
Be certain the user receives the instruction sheets for their products.

BX2523
2007-09 Mazda 3
Installation Instructions



Shown without removable tabs installed.

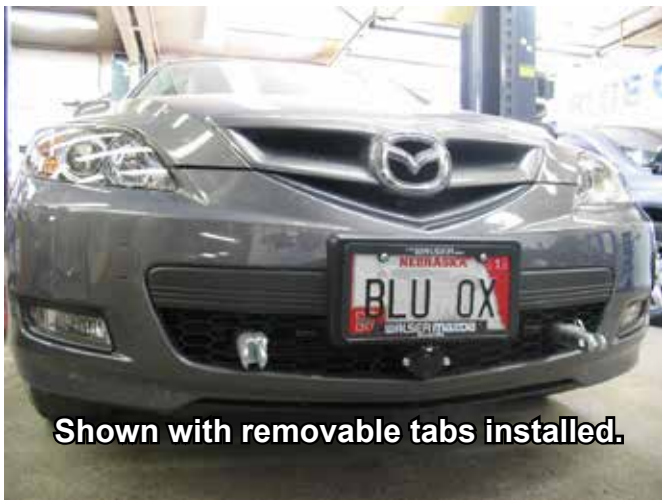

Shown with removable tabs installed.

If the baseplate is in an accident, it must be replaced. DO NOT use it again! An accident can cause unseen damage and using it again could result in more damage or serious injury. DO NOT use the baseplate if it is damaged or missing parts.

CUSTOMER SERVICE COMMITMENT

Blue Ox is committed to providing you with exceptional customer care throughout your lifetime with our products. Our team is here to assist you with any questions you may have regarding the performance of your product. Simply call 1-800-228-9289 and you can speak with our customer care team.

Additionally, please visit our website to see which rallies our Destination America team will be attending. For a nominal fee, our service technician will service your towing system to ensure it's in proper working condition. Also as a commitment to our customers, should you visit our factory you can stay at our full service Blue Ox campground at no charge along with enjoying a factory tour.

Again thank you for being our customer and for the confidence you have shown in the performance of our products. It is because of customers like you we enjoy the success we have today.



General Information

1. Ensure that your product(s) are registered online at www.blueox.com. It is crucial to register your product(s) so that you may be alerted of product offerings, updates, upgrades, maintenance and safety bulletins, and/or recalls.
2. **It is the owner's responsibility to inspect all towing equipment for cracked welds, missing or worn parts and loose bolts before each towing trip.** Be sure to use Loctite® Red on all bolts and tighten to the recommended specifications.
3. **It is the owner's responsibility to hook up all towing equipment per manufacturer's instructions/recommendations.**
4. Remove the attachment tabs when not in use (if applicable).

Notice To Baseplate Installer

1. It is YOUR responsibility to watch for:

- Oil cooler and air conditioner lines
- Electrical wires and hoses
- Missing parts or attaching points on the frame

** If the baseplate is improperly installed and is against a wire or hose, it could cause fluid leaks or electrical shorts some time after the actual baseplate installation.

Permanent Baseplate Safety Cable Installation

Permanent baseplate safety cables are strongly recommended when towing a vehicle with a tow bar. The principle function of the permanent baseplate safety cables is to prevent the towed vehicle from breaking loose in the event the connection between the frame of the towed vehicle and the baseplate fails or becomes disconnected. The cables must be connected from the baseplate to the frame rail or cross member of the vehicle's frame. The illustrations below show the possible arrangements recommended by Blue Ox®. Each permanent baseplate safety cable must have an adequate weight rating for the towing system. The weight rating of the two (2) cables together will not qualify.

Do not mount the permanent baseplate safety cables against wires, hoses or brake lines.

These permanent baseplate safety cables should remain installed as long as the baseplate is installed on the vehicle. Permanent baseplate safety cables are to be used in conjunction with, and NOT a replacement for legally required safety cables attaching the towed vehicle to the towing vehicle.

OPTION #1

Permanent Baseplate Safety Cables to Cross Member or Frame of Towed Vehicle.

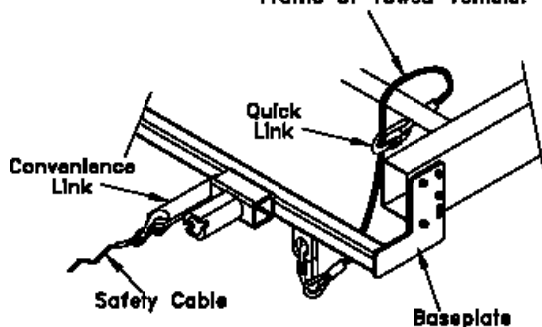

OPTION #2

Permanent Baseplate Safety Cables to Cross Member or Frame of Towed Vehicle.

