

GROSS LOAD CAPACITY WHEN USED AS A WEIGHT CARRYING HITCH: 2,000 LBS. TRAILER WEIGHT & 200 LBS. TONGUE WEIGHT.
*****DO NOT EXCEED VEHICLE MANUFACTURER'S RECOMMENDED TOWING CAPACITY.*****

Parts List			
ITEM	QTY	PART NUMBER	DESCRIPTION
1	1	D-55001	1 1/4" CURT BALL MOUNT
2	1	F-4 PIN	HITCH PIN
3	1	F-4 CLIP	HITCH PIN CLIP
12	1	CM-11003-WA	WELDMENT ASSEMBLY
13	1	CM-11003-BK	HITCH BOLT KIT

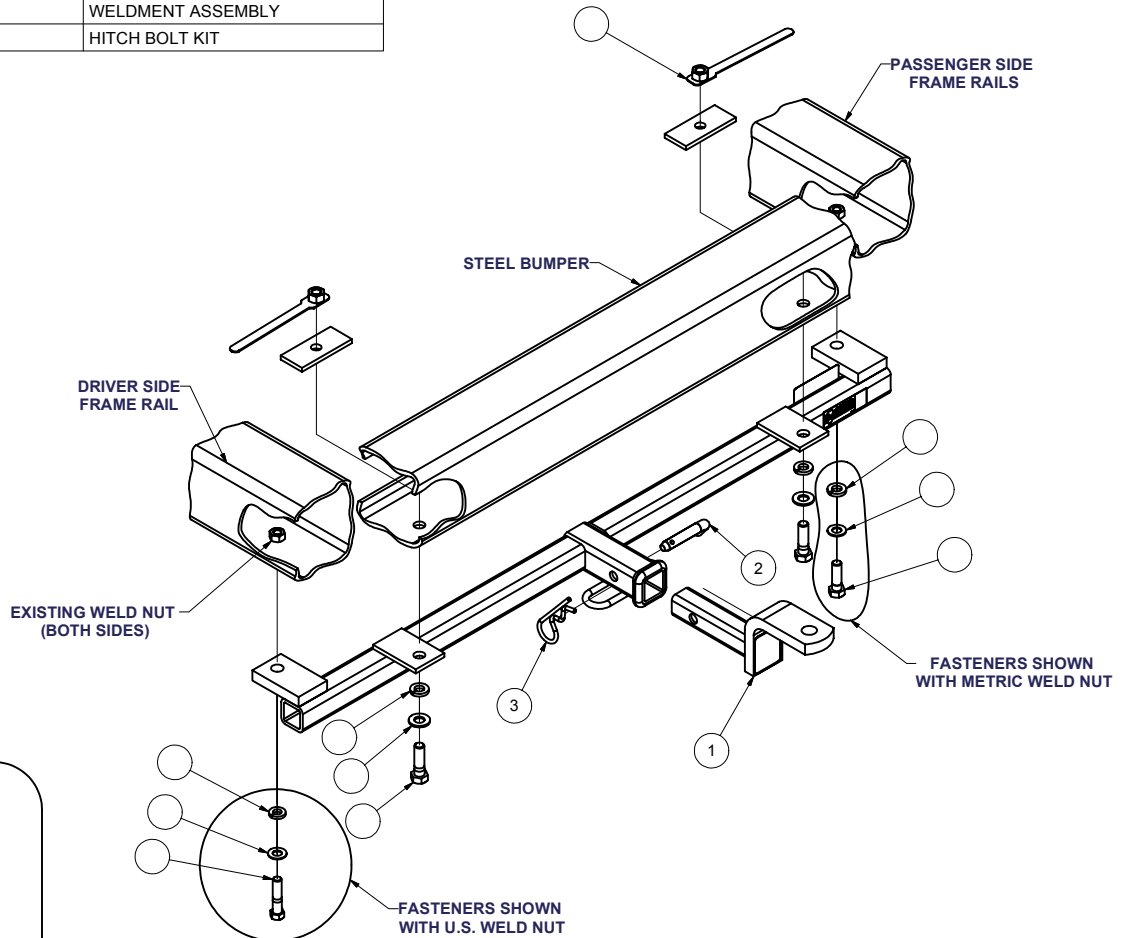

HITCH WEIGHT: 20 LBS.
 INSTALL TIME: 45 MINUTES
 INSTALL NOTES:
NO DRILLING REQUIRED

INSTALLATION STEPS

- 1) This hitch mounts to existing weld nuts accessible in the bottom of the frame, and at existing 1/2" diameter holes in the bottom of the standard bumper.
- 2) Remove the bolts attaching the bumper bracket to the underside of frame rails, on the left and right sides of the vehicle.
- 3) If vehicle is equipped with tow loops, remove them and return them to the customer.
- 4) Bolts removed from the frame may be 7/16" (US) or 12mm (metric). Select matching bolts provided with the hitch.
- 5) Fasten the hitch at the underside of the bumper as shown. Be certain to use the backing plates provided under the handle nuts inside the bumper.
- 6) Torque all 7/16" fasteners to 50 lb-ft, and all 12mm fasteners to 60 lb-ft.

PERIODICALLY CHECK THIS RECEIVER HITCH TO INSURE THAT ALL FASTENERS ARE TIGHT AND THAT ALL STRUCTURAL COMPONENTS ARE SOUND.

Curt Manufacturing Inc., warrants this product to be free of defects in material and/or workmanship at the time of retail purchase by the original purchaser. If the product is found to be defective, Curt Manufacturing Inc., may repair or replace the product, at their option, when the product is returned, prepaid, with proof of purchase. Alteration to, misuse of, or improper installation of this product voids the warranty. Curt Manufacturing Inc.'s liability is limited to repair or replacement of products found to be defective, and specifically excludes liability for incidental or consequential loss or damage.