



BX3832

2011 Volkswagen Tiguan Installation Instructions

Serial Number

Please read BOTH these Installation Instructions and the General Towing Instructions before attempting to install or operate this equipment.

- Blue Ox® towing products and accessories are intended to be installed by Blue Ox® Dealers who are familiar with our products and have the equipment and knowledge to do “fit work”. When necessary, Blue Ox® Dealers can be found at www.blueox.com or by contacting our 24/7 Customer Care Department at (402) 385-3051.
- Many Blue Ox® Baseplates are designed to use existing holes and hardware to mount the baseplate to the towed vehicle. Even though bolts are there, do not assume they are adequate for baseplate mounting. Always use hardware supplied in the hardware kit or existing hardware specified in the Baseplate Installation Instructions.

Attachment Tab Height: 17-1/2”
Attachment Tab Width: 18-1/2”

Bolt Torque Specifications
Torque in Foot-Pounds per Metric Bolts

Bolt Size	Grade 8.8	Grade 10.9
6MM	6	8
8MM	16	22
10MM	31	40
12MM	54	70
14MM	89	117

Confirm the towability and pre-towing procedures for your vehicle with the owner’s manual or contact the vehicle’s manufacturer for specific towing procedures.

Bolt Torque Specifications
Torque in Foot-Pounds per Inch Bolts

Bolt Size	Grade 5	Grade 8
1/4”	10	14
5/16”	19	29
3/8”	33	47
7/16”	54	78
1/2”	78	119
5/8”	154	230



⚠ WARNING

Failure to read and follow these instructions could result in separation of the towed vehicle from the tow bar, causing property damage, loss of towed vehicle, personal injury or death.

BX3832
2011 Volkswagen Tiguan
Installation Instructions

Parts List

Ref. No.	Qty.	Part #	Description
1	1	61-6925	WLDM/T, BP, BX3832
2	3	201-0050	1/4-20 X 3/4" HEX BOLT, GRD. 5, ZP
3	8	201-0368	3/8-16 X 1 1/4" HEX HEAD BOLT, GRD. 5
4	3	202-0102	1/4-20 HEX NYL NUT, ZP
5	8	203-0010	3/8" LOCK WASHER, ZP
6	8	61-5208	WLD, NUTPLATE, 1/4 X 1 X 1 (3/8" W/14" WIRE)
7	2	62-3468	ATT TAB ASSY, REM, SF/SB, 1 HOLE
8	2	101-5822	ADAPTER, 4 WAY CONNECTOR
9	2	201-0192	#10-32-1/2" SLOT, ROUND HEAD SCREW
10	2	201-0979	#12-14 X 1" SELF DRILLING SCREW, ZP
11	2	202-0047	#10-32 HEX NUT
12	2	203-0054	#10-32 LOCK WASHER
13	1	203-0001	1/4" FLAT WASHER, ZP
14	1	102-7238	BREAKAWAY BRKT, BX3832
	2	290-0437	RECEIVER, CAP PLUG (BLK) (not shown)
	2	226-0046	BASEPLATE SAFETY CABLE, 36" CLASS III (not shown)
	2	229-0359	QUICKLINK, 3/8", ZP (not shown)
	2	203-0008	1/4" LOCK WASHER, ZP (not shown)

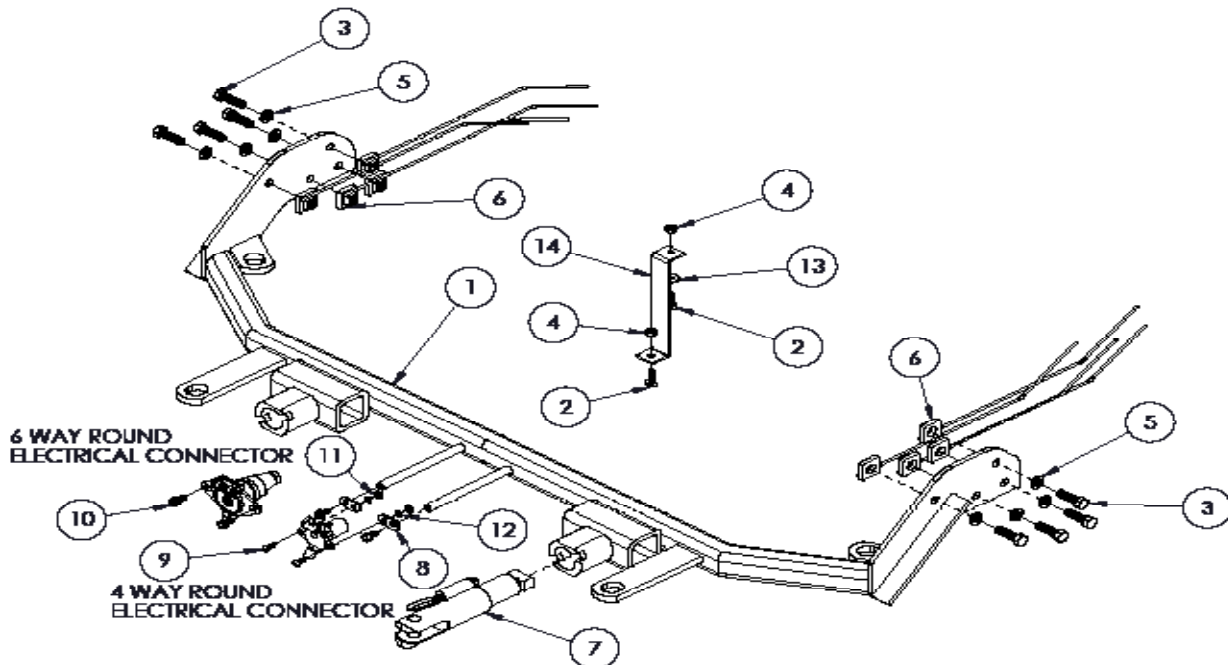

Tools Required

13MM Socket	15 MM Socket	9/16" Socket
T25 Torx	T30 Torx	Large Vise Grip
Diagonal Cutters	Reciprocating Saw	Utility Knife
Torque Wrench	Drill	1-1/4" Hole Saw
13/32" Drill Bit	Tape Measure	Loctite® RED

Important:

Use only genuine factory replacement parts on your baseplate. Do **NOT** substitute homemade or non-typical parts. If a bolt is lost or in need of replacement, for your safety and the preservation of your baseplate, be sure to use a replacement bolt of the same grade (In most cases it will be Grade 5, please reference the parts list above). Replacement parts may be ordered through your nearest Blue Ox® Dealer or Distributor.

BX3832
2011 Volkswagen Tiguan
Installation Instructions

Attachment Tabs:

Due to the design of the removable tabs, the RangeFinderII, Acclaim and Ambassador tow bars can not be used. Adapters, except the BX8833, BX88262 and BX88151, can not be used with this baseplate.

Installation Notes: The fascia and front bumper will be removed for installation. Trimming of the fascia, frame webbing, and front bumper is required. Some drilling is required.

The dimensional variations between otherwise identical vehicles can be considerable. While the baseplate was designed for easy installation, it may be necessary to tailor the baseplate slightly to compensate for auto manufacturer's tolerances. These minor adjustments may include filing a hole slightly, bending electrical rods, and/ or bending end plates.

The BX8869 Wiring Kit is recommended for this vehicle.



**Possible location of the BX8869
Bulb & Socket Wiring Kit**

Installation Instructions



1. Using a T30 Torx, remove the a bolt from each side of the top of the fascia, near each headlight (white arrows). Use a T25 Torx to remove the bolt from the top of the center of the fascia (gray arrow). Set bolts aside to be reinstalled later.



2. In front of the driver's side front tire, use a T30 Torx and remove two (2) bolts from the wheel well. Do this on both sides of the car. Set bolts aside to be reinstalled later.

BX3832
 2011 Volkswagen Tiguan
 Installation Instructions



3. Remove the wheel well trim from the driver's side front wheel. To do this, pinch the trim clips from the inside of the wheel well, after pulling back the wheel well. Do this on both sides. Set all parts aside to be reinstalled later.

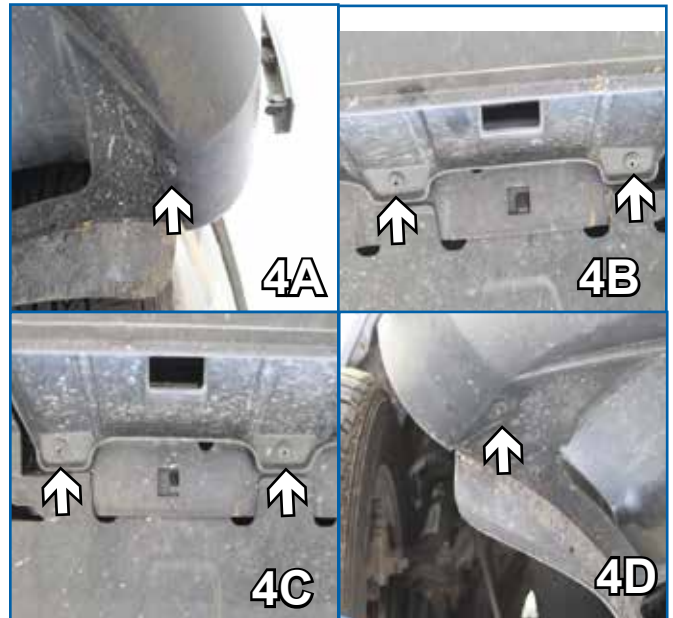

4. Use a T25 Torx wrench and remove the six (6) bolts from the fascia-belly pan seam underneath the car. Set all bolts aside to be reinstalled later.



5. To remove the fascia, carefully lift up and out from the vehicle on the edge near the driver's side front wheel. Do this on both sides. Set the fascia aside to be reinstalled later.

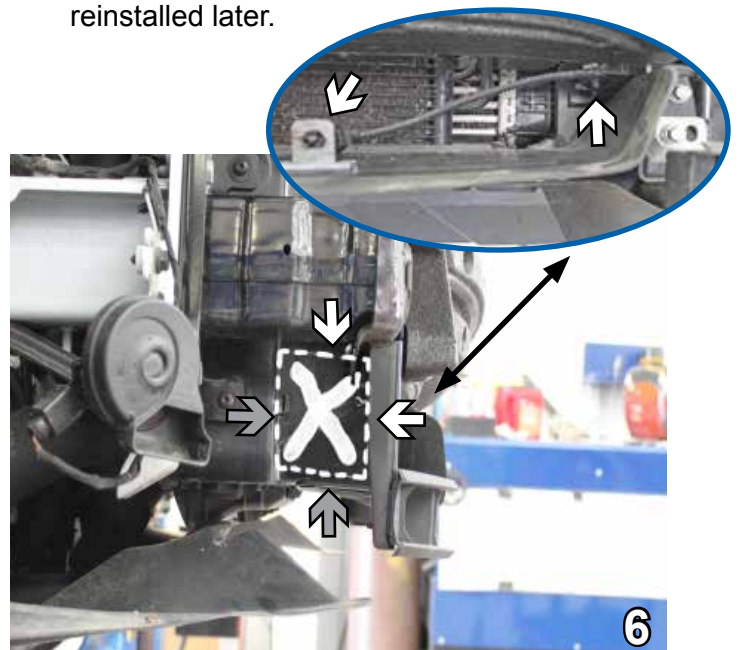

6. Using a utility knife, cut a square from the black plastic radiator cover. Trace the bottom edge and the back edge of the bumper for two (2) sides of the cut (white arrows), and to the back and bottom of the plastic for the other two (2) sides (gray arrows). Do this on both sides of the vehicle. On the driver's side, unplug electrical connection.

BX3832
2011 Volkswagen Tiguan
Installation Instructions

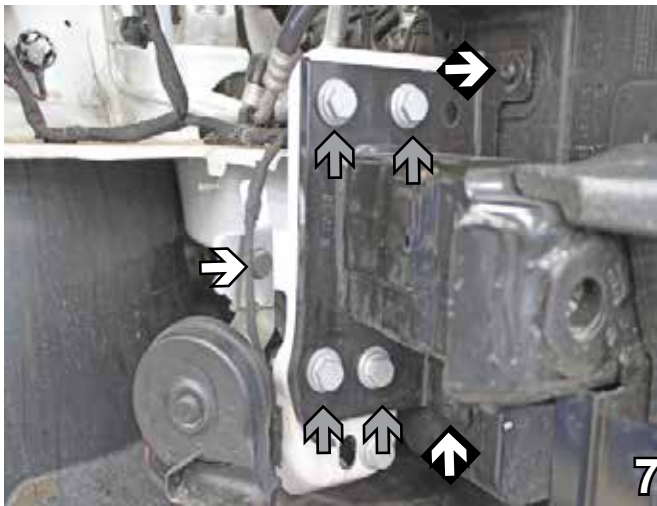

7. Remove the horn brackets using a 13MM socket (white arrows). Then to remove the front bumper, use a 15MM socket and remove the four (4) mounting bolts from each side (gray arrows). Then use a T30 Torx, and remove the last bolt holding the bumper on. Do this on both sides of the vehicle. Set all bolts aside to be reinstalled later.



8. Use a T30 Torx to remove the two (2) bolts from the middle of the bumper. Remove the bumper and set bolts and bumper aside to be reinstalled later.

Using a good quality paint, spray cut edges of frame to prevent rusting.



9. Use a reciprocating saw and cut a slot out of the outside of the gray frame webbing on the driver's side. Starting 2-1/4" down from the top of the frame, but in 1-1/4" and down 4-1/2" to allow the baseplate to fit. Do this on both sides.

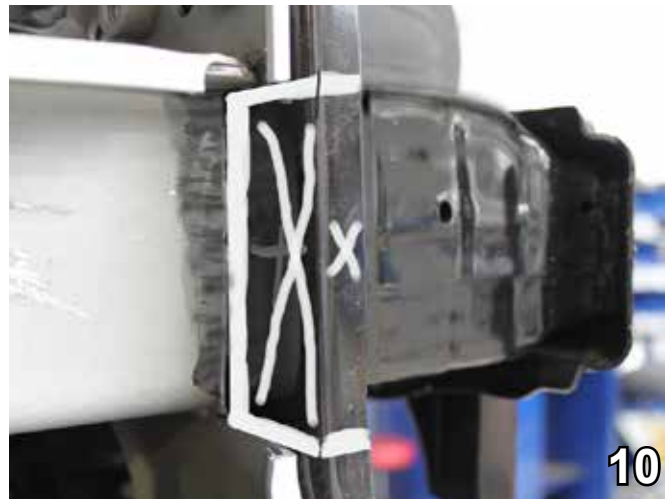

10. Reinstall the front bumper using the existing hardware. Then, use the cut you just made as a template and outline the cut on the back of the front bumper. Use a reciprocating saw and cut this outline out on both sides of the bumper. Reinstall bumper. The radiator crossmember will need to be lifted slightly to align holes for bumper reinstallation

BX3832
2011 Volkswagen Tiguan
Installation Instructions



11. Using a 1-1/4" hole saw and a drill, cut downward into the top of the bumper. This hole is to allow nut plates to be placed in later steps. Cut the hole on both sides of the vehicle.

When using power drills be aware of the dangers of torque and drill bit length.

BE SURE TO USE LOCTITE® RED ON ALL BOLTS BEFORE TIGHTENING. TIGHTEN ALL BOLTS ACCORDING TO THE TORQUE CHART ON THE FRONT PAGE OF THESE INSTRUCTIONS OR ON PAGE 3 OF THE BASEPLATE TOWING GENERAL INSTRUCTIONS.

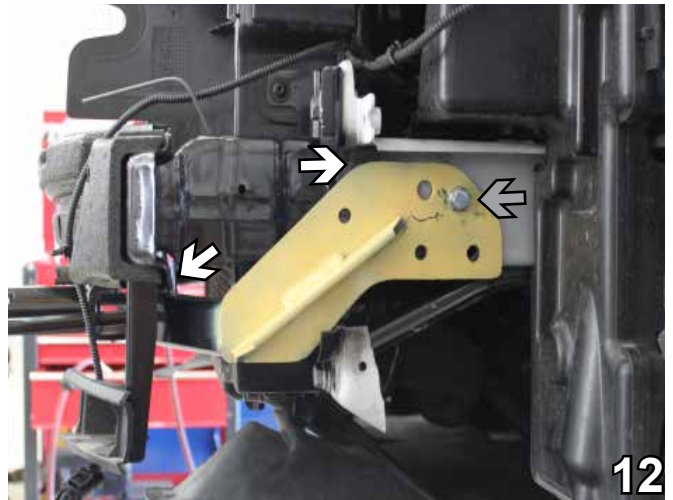

12. Place the baseplate into the channels we cut. It should be near the top of the gray frame rail and touching the back of the bumper's drop rail (white arrows). Then, use a drill with a 13/32" drill bit with the baseplate as a template, and drill the driver's side top back hole into the bumper. Use a 3/8"-16 x 1-1/4" hex bolt with a 3/8" lock washer and a 1/4"-20 x 1" x 1" nut plate and secure the farthest back hole on the drivers side (gray arrow). Tighten with Loctite Red. Repeat this on the passenger's side making sure the baseplate is level first.

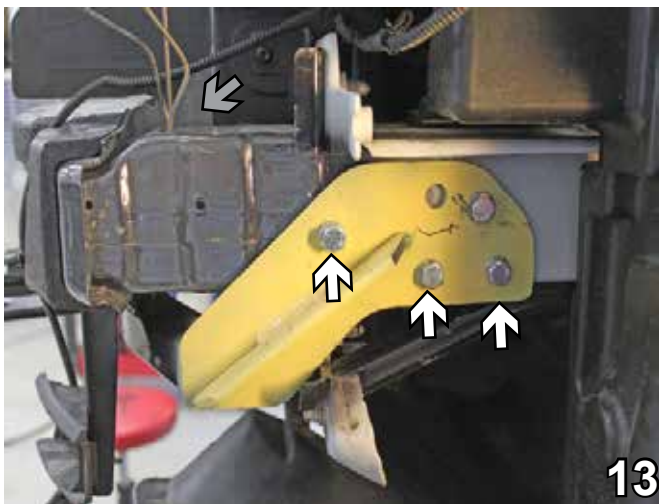

13. Use the 13/32" drill bit and drill out the remaining three (3) holes on each side. Secure each hole with a 3/8"-16 x 1-1/4" hex bolt (white arrows) with a 3/8" lock washer and a 1/4"-20 x 1" x 1" nut plate (gray arrow).

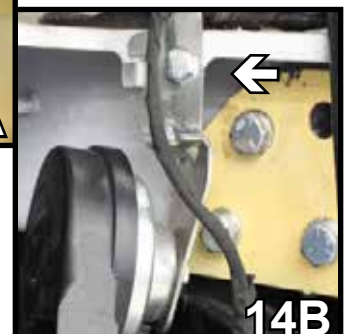

14. On the driver's side, reattach the horn with the existing hardware. On the passenger's side, use a 1/4" drill bit and drill through one (1) of the existing holes on the frame webbing (14A). Secure the passenger's side horn with a 1/4"-20 x 3/4" hex bolt with a 1/4" lock washer a 1/4" hex nut (14B). Tighten with Loctite Red.

BX3832
2011 Volkswagen Tiguan
Installation Instructions



15. **Optional:** To install a breakaway switch use a 1/4" drill bit to make a hole 1" from the driver's side inside fin on the top radiator mounting. Attach the breakaway bracket with a 1/4"-20 x 3/4" hex bolt and a 1/4" hex nylon nut (white arrow). Attach the breakaway switch to the bracket with a 1/4"-20 x 3/4" hex bolt with a 1/4" hex nylon nut (gray arrow). Tighten all bolts with Loctite Red.



16. Attach the permanent baseplate safety cables to the provided convenience link on the baseplate (white arrow). The photo above shows the recommended installation of the permanent baseplate safety cables to frame of the vehicle (gray arrow). If the vehicle has additional options, not shown above, which interfere with mounting the permanent baseplate safety cables, secure the cable to a solid piece of the vehicle's frame as described in the instructions included with the permanent baseplate safety cables.



17. Align the fascia to its original position. Trim the grill with a utility knife to allow access to the removable tabs on both sides.

Be sure that **ALL** electrical connections are plugged in properly and functioning **BEFORE** installing the fascia.

19. Reinstall the fascia using the existing bolts and push pins. Make sure all bolts have been tightened with Loctite Red and that all electrical and fluid lines have been reinstalled properly.



18. Use a 1/2" drill bit, and drill a hole in the back of the tail light. Put the wires through the holes and silicone around it. Reinstall the taillight. Do this on both sides.

BX3832
2011 Volkswagen Tiguan
Installation Instructions

Install the tow bar and safety cables according to the instructions provided in their packages. When demonstrating to customer, be sure to include all original content and packages. Do **NOT** substitute other devices if the tow bar pins and clips are misplaced.



**DEALER or INSTALLER:
Be certain the user receives the
instruction sheets for their products.**

Customer Service Commitment

Blue Ox is committed to providing you with exceptional customer care throughout your lifetime with our products. Our team is here to assist you with any questions you may have regarding the performance of your product. Simply call (402) 385-3051 and you can speak with our customer care team.

Additionally, please visit our website to see which rallies our Destination America team will be attending. For a nominal fee, our service technician will service your towing system to ensure it's in proper working condition. Also, as a commitment to our customers, should you visit our factory you can stay at our full service Blue Ox campground at no charge along with enjoying a factory tour.

Again, thank you for being our customer and for the confidence you have shown in the performance of our products. It is because of customers like you we enjoy the success we have today.

If the baseplate is in an accident, it must be replaced. DO NOT use it again! An accident can cause unseen damage and using it again could result in more damage or serious injury. DO NOT use the baseplate if it is damaged or missing parts.



© 2011 Blue Ox
One Mill Road, Industrial Park
Pender, Nebraska 68047
Phone: (402) 385-3051 • Fax: (402) 385-3360
www.blueox.com
7/25/11

General Information

1. Ensure that your product(s) are registered online at www.blueox.com. It is crucial to register your product(s) so that you may be alerted of product offerings, updates, upgrades, maintenance and safety bulletins, and/or recalls.
2. **It is the owner's responsibility to inspect all towing equipment for cracked welds, missing or worn parts and loose bolts before each towing trip.** Be sure to use Loctite® Red on all bolts and tighten to the recommended specifications.
3. **It is the owner's responsibility to hook up all towing equipment per manufacturer's instructions/recommendations.**
4. Remove the attachment tabs when not in use (if applicable).

Notice To Baseplate Installer

1. It is YOUR responsibility to watch for:

- Oil cooler and air conditioner lines
- Electrical wires and hoses
- Missing parts or attaching points on the frame

** If the baseplate is improperly installed and is against a wire or hose, it could cause fluid leaks or electrical shorts some time after the actual baseplate installation.

Permanent Baseplate Safety Cable Installation

Permanent baseplate safety cables are strongly recommended when towing a vehicle with a tow bar. The principle function of the permanent baseplate safety cables is to prevent the towed vehicle from breaking loose in the event the connection between the frame of the towed vehicle and the baseplate fails or becomes disconnected. The cables must be connected from the baseplate to the frame rail or cross member of the vehicle's frame. The illustrations below show the possible arrangements recommended by Blue Ox®. Each permanent baseplate safety cable must have an adequate weight rating for the towing system. The weight rating of the two (2) cables together will not qualify.

Do not mount the permanent baseplate safety cables against wires, hoses or brake lines.

These permanent baseplate safety cables should remain installed as long as the baseplate is installed on the vehicle. Permanent baseplate safety cables are to be used in conjunction with, and NOT a replacement for legally required safety cables attaching the towed vehicle to the towing vehicle.

OPTION #1

Permanent Baseplate Safety Cables to Cross Member or Frame of Towed Vehicle.

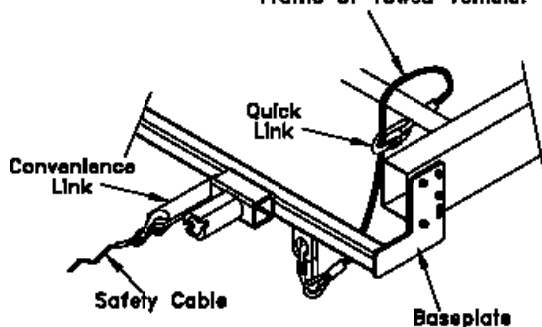

OPTION #2

Permanent Baseplate Safety Cables to Cross Member or Frame of Towed Vehicle.

