



## **BX3726 Installation Instructions 1993-94 Toyota T100 Pickup 4WD**

1. Read the General Instruction Sheet included with this base plate.
2. The baseplate bolts to the bottom of the frame rails just behind the front bumper. All mount bolts are supplied with the baseplate.
3. Remove the tow hook. Set the hook and its mount bolts aside, they will not be used in the installation.
4. Just behind the tow hook mount is another threaded hole. There are three corresponding threaded holes in the opposite frame rail. The baseplate mounts using these frame holes.
5. Hold the baseplate up under the frame with the attachment tabs down and facing forward. Align the holes in the side mounts with the holes in the frame. When holes align, apply Loctite and start all six bolts and lock washers. When all bolts are started, tighten completely.
6. The dimensional variations between otherwise identical cars can be considerable. While the location and size of the holes in the base plate were designed to allow for easy installation, it may be necessary to file a hole slightly to allow a bolt to clear.
7. Install the tow bar and safety cables according to the instructions included in their packages. **Note:** This vehicle requires a Class III (5000 lb) tow bar.
8. Do not substitute other devices if the tow bar pin and clip are lost.
9. DEALER OR INSTALLER: BE CERTAIN THE USER RECEIVES THE INSTRUCTION SHEET.

**Automatic**



### Tools Required

Loctite Red

17mm Socket

19mm Socket

### Parts List

Ref. No.	Qty.	Part No.	Description
1	1	61-4056	Weldment, Baseplate, BX3726
2	6	201-0411	12MM-1.25 x 40MM Bolt, Grd 8.8
3	6	203-0105	12MM Lock Washer
4	2	201-0979	#12-14 x 1" Self Drilling Screw, ZP
5	2	201-0192	10-32 X 1/2 Slot, RD. HD. Screw
6	2	203-0054	#10 Lock Washer
7	2	202-0047	#10-32 Hex Nut
8	2	101-5822	Adapter, 4 Way Connector
	2	229-0359	Quicklink, 3/8, ZP (Not Shown)
	2	226-0046	Baseplate Safety Cable, 36" CL III (Not Shown)

# BX3726

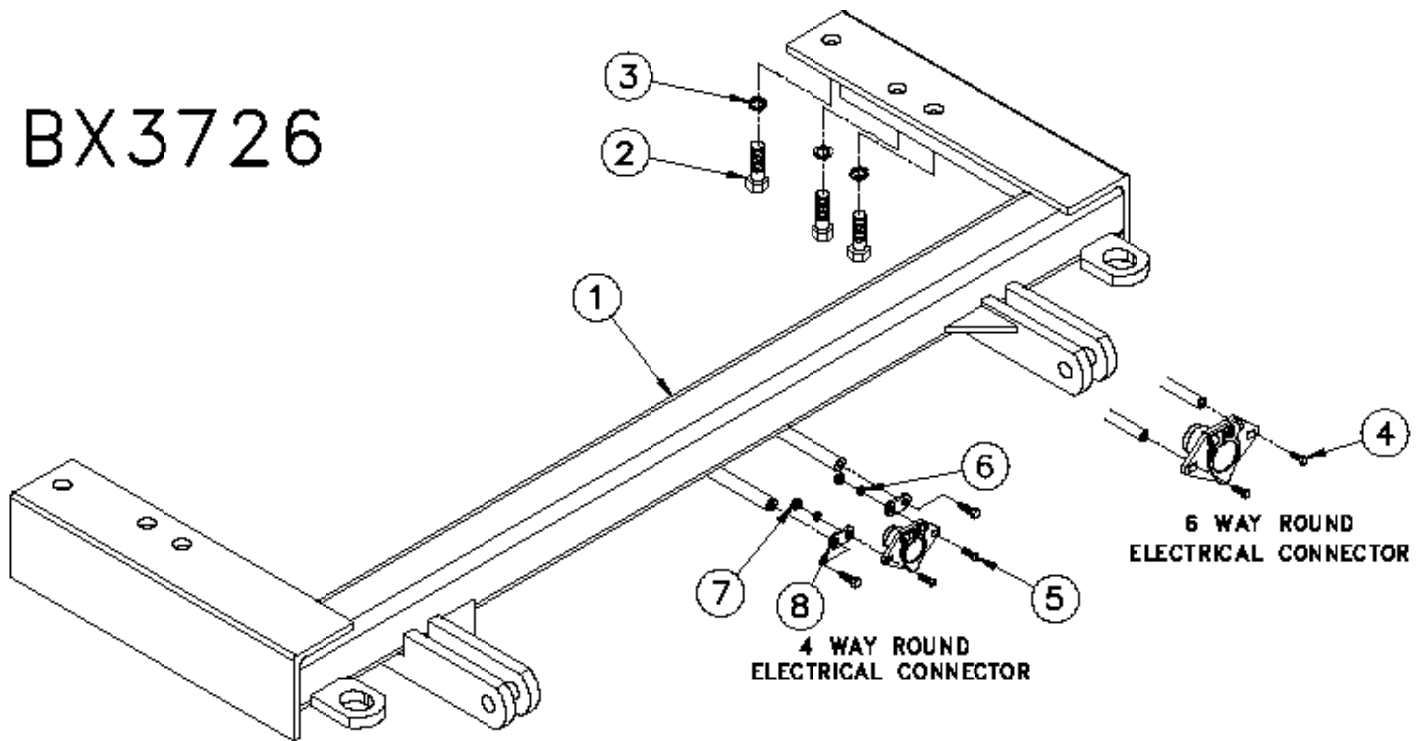

# Automatic

# General Information

1. Ensure that your product(s) are registered online at [www.blueox.com](http://www.blueox.com). It is crucial to register your product(s) so that you may be alerted of product offerings, updates, upgrades, maintenance and safety bulletins, and/or recalls.
2. **It is the owner's responsibility to inspect all towing equipment for cracked welds, missing or worn parts and loose bolts before each towing trip.** Be sure to use Loctite® Red on all bolts and tighten to the recommended specifications.
3. **It is the owner's responsibility to hook up all towing equipment per manufacturer's instructions/recommendations.**
4. Remove the attachment tabs when not in use (if applicable).

## Notice To Baseplate Installer

### 1. It is YOUR responsibility to watch for:

- Oil cooler and air conditioner lines
- Electrical wires and hoses
- Missing parts or attaching points on the frame

\*\* If the baseplate is improperly installed and is against a wire or hose, it could cause fluid leaks or electrical shorts some time after the actual baseplate installation.

## Permanent Baseplate Safety Cable Installation

Permanent baseplate safety cables are strongly recommended when towing a vehicle with a tow bar. The principle function of the permanent baseplate safety cables is to prevent the towed vehicle from breaking loose in the event the connection between the frame of the towed vehicle and the baseplate fails or becomes disconnected. The cables must be connected from the baseplate to the frame rail or cross member of the vehicle's frame. The illustrations below show the possible arrangements recommended by Blue Ox®. Each permanent baseplate safety cable must have an adequate weight rating for the towing system. The weight rating of the two (2) cables together will not qualify.

***Do not mount the permanent baseplate safety cables against wires, hoses or brake lines.***

These permanent baseplate safety cables should remain installed as long as the baseplate is installed on the vehicle. Permanent baseplate safety cables are to be used in conjunction with, and NOT a replacement for legally required safety cables attaching the towed vehicle to the towing vehicle.

### OPTION #1

Permanent Baseplate Safety Cables to Cross Member or Frame of Towed Vehicle.

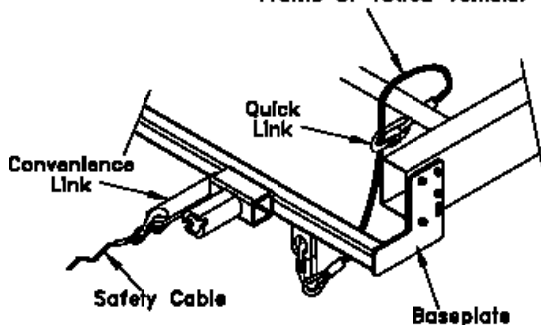

### OPTION #2

Permanent Baseplate Safety Cables to Cross Member or Frame of Towed Vehicle.

