



Strong As An Ox™

BX3517 Installation Instructions 2002 Suzuki Aerio SX

Serial No.

The front fascia, tie down brackets and fog lights are removed for baseplate installation. Tie down brackets will not be reinstalled. No holes to drill. The BX8869 is available for the vehicle. Attachment Tabs are 20 inches center to center and a height of 12 1/2 inches.



1. Remove the four metric bolts from the top side of fascia with the 10MM socket.



2. Just above front tire, remove Phillips screw from fascia's corner, both sides.



3. Just forward of front tire, remove one push pin, both sides.



4. Remove two Phillips screws, just forward of front tire, on bottom side of fascia.



5. Using the 10MM socket, remove four metric bolts from lower fascia tabs, pull fascia forward and set aside.



6. Remove two metric bolts, just under headlight assembly, on bumper bracket and one below metal bumper using the 12MM socket, both sides. Pull metal bumper forward and set aside.



Strong As An Ox™



7. Remove the three metric bolts from the windshield washer reservoir on the driver's side, with the 10MM socket. Unplug electrical connection, tubing and cap reservoir, set aside.



8. Remove one push pin from air baffle on passenger's side.



9. Using the hacksaw, make four cuts in webbing (see step 13 for top cut) and bend forward with the vise grips, both sides.



10. Measure and mark from the right side of center support, to the left 9 1/4" and 9 5/8" on lower air dam. Measure and mark from the left side of center support, to the right 9 1/4" and 9 5/8" on lower air dam.



11. Using the utility knife cut out a slot 3 1/2" back to marks in step 10. This will allow baseplate to slide into place.



12. Hold baseplate to align with existing hole on driver's side reservoir, hand tighten item 7. Align existing hole for air baffle, on passenger's side and clamp with vise grips.



Strong As An Ox™



13. Using the baseplate as a template, drill two upper holes and one lower hole with the 7/16" drill bit, both sides. Insert item 3 into frame end to align with drilled holes and tighten items 5 and 6, according to drawing on last page. **Be sure and use loctite on all bolts before tightening, refer to General Instruction Sheet for torque specs.**



14. Insert item 2 behind webbing to align with lower drilled hole and tighten items 5 and 6. **Be sure and use loctite on all bolts before tightening, refer to General Instruction Sheet for torque specs.**



15. Remove metric bolt installed in step 12 and reinstall washer reservoir using items 7 and 8 according to drawing on last page. **Be sure and use loctite on all bolts before tightening, refer to General Instruction Sheet for torque specs.**



16. Reinstall push pin in air baffle on passenger's side and metal bumper. Hold fascia in place and mark areas that need to be trimmed, trim accordingly using diagonal cutters. Install fascia and headlight assemblies. **Be sure all electrical connections are plugged in properly.**

17. The dimensional variations between otherwise identical cars can be considerable. While the location and size of the holes in the baseplate were designed to allow for easy installation, it may be necessary to file a hole slightly to allow a bolt to clear.

18. Install the tow bar and safety cables according to the instructions included in their packages.

19. Do **not** substitute other devices if the tow bar pin and clip are lost.

20. DEALER OR INSTALLER: BE CERTAIN THE USER RECEIVES THE INSTRUCTION SHEET.



Strong As An Ox™

Tools Required

10MM Socket
12MM Socket
Phillips Screw Driver
Parts List

Loctite
7/16" Drill Bit
Diagonal Cutters

9/16" Socket
Hack Saw
Vise Grips

Ref. No.	Qty.	Part No.	Description
1	1	61-5834	Weldment, Base Plate, BX3517
2	2	61-5208	3/8-16 Nut Plate
3	2	61-5843	Weldment. 3/8-16, Double Nut Plate, BX3517
4	4	102-6341	Spacer Plate, BX3517
5	6	201-0440	3/8-16 x 1 1/2 Bolt, Grd. 5, ZP
6	6	203-0010	3/8 Lock Washer, ZP
7	2	201-0655	6MM-1 x 30MM Hex Bolt, Grd. 8.8, ZP
8	5	203-0001	1/4 Flat Washer, ZP
9	2	62-3468	Attachment, Assembly, SF/ SB (R)
10	2	202-0047	#10-32 Hex Nut
11	2	203-0054	#10 Lock Washer
12	2	201-0192	#10-32 x 1/2 Slot, Rd. Hd. Screw
13	2	101-5822	Adapter, 4 Way Connector
14	2	201-0979	#12-14 x 1" Self Drilling Screw, ZP
	2	226-0046	Baseplate Safety Cable, 36" CL III (Not Shown)
	2	229-0359	Quicklink, 3/8, ZP (Not Shown)
	2	290-0437	Receiver, Cap Plug (BLK) (Not Shown)

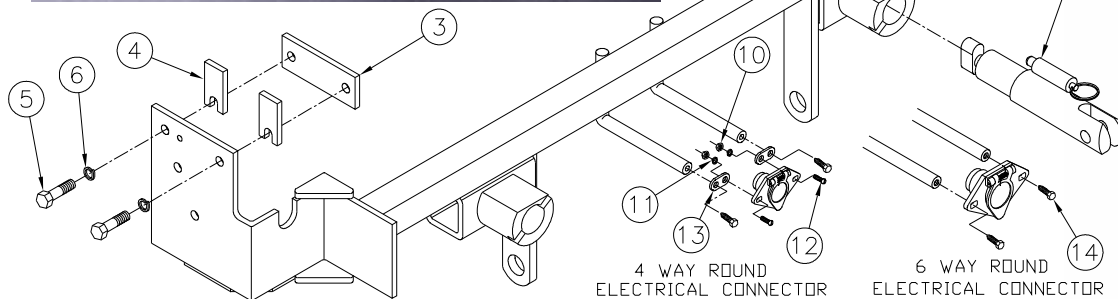

Location for the BX8869 on the driver's side tail light assembly.

IMPORTANT: Use only genuine factory replacement parts on your Base Plate. Do not substitute homemade or nontypical parts. If a bolt is lost or in need of replacement, for your safety and the preservation of your Base Plate, be sure to use a replacement bolt of the same grade (Usually Grade 5, refer to parts list). Repair parts may be ordered through your nearest **Blue Ox** dealer or distributor.

© 2002 Blue Ox Division, Automatic Equipment Mfg. Co. • One Mill Road, Industrial Park
Pender, Nebraska 68047 • Phone 402-385-3051 • Fax 402-385-3360 • www.aemfg.com

General Information

1. Ensure that your product(s) are registered online at www.blueox.com. It is crucial to register your product(s) so that you may be alerted of product offerings, updates, upgrades, maintenance and safety bulletins, and/or recalls.
2. **It is the owner's responsibility to inspect all towing equipment for cracked welds, missing or worn parts and loose bolts before each towing trip.** Be sure to use Loctite® Red on all bolts and tighten to the recommended specifications.
3. **It is the owner's responsibility to hook up all towing equipment per manufacturer's instructions/recommendations.**
4. Remove the attachment tabs when not in use (if applicable).

Notice To Baseplate Installer

1. It is YOUR responsibility to watch for:

- Oil cooler and air conditioner lines
- Electrical wires and hoses
- Missing parts or attaching points on the frame

** If the baseplate is improperly installed and is against a wire or hose, it could cause fluid leaks or electrical shorts some time after the actual baseplate installation.

Permanent Baseplate Safety Cable Installation

Permanent baseplate safety cables are strongly recommended when towing a vehicle with a tow bar. The principle function of the permanent baseplate safety cables is to prevent the towed vehicle from breaking loose in the event the connection between the frame of the towed vehicle and the baseplate fails or becomes disconnected. The cables must be connected from the baseplate to the frame rail or cross member of the vehicle's frame. The illustrations below show the possible arrangements recommended by Blue Ox®. Each permanent baseplate safety cable must have an adequate weight rating for the towing system. The weight rating of the two (2) cables together will not qualify.

Do not mount the permanent baseplate safety cables against wires, hoses or brake lines.

These permanent baseplate safety cables should remain installed as long as the baseplate is installed on the vehicle. Permanent baseplate safety cables are to be used in conjunction with, and NOT a replacement for legally required safety cables attaching the towed vehicle to the towing vehicle.

OPTION #1

Permanent Baseplate Safety Cables to Cross Member or Frame of Towed Vehicle.

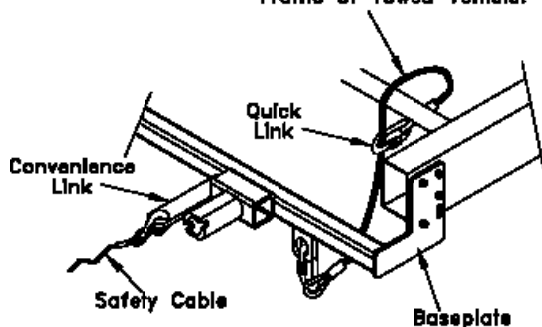

OPTION #2

Permanent Baseplate Safety Cables to Cross Member or Frame of Towed Vehicle.

