



BX3512 Installation Instructions 1999-01 Suzuki Esteem

Serial No.

The baseplate mounts to the back side of the metal bumper and to the cross frame below the radiator. The plastic bumper and rock guard need to be removed and four holes need to be drilled. The rock guard needs to be notched before it can be reinstalled.

1. Remove the six phillip head screws on the underside of the bumper facia in front of the tires. Remove the two 10mm screws and push pins that are on the underside of the bumper.
2. Remove the six (3 on each side) 10mm screws to drop the rock guards. Remove the three 10mm screws from the top of the lower vent area.
3. Remove the two Phillips head screws (one on each side) from the inside of the wheel well and in front of the tires. The screws will extend from the bumper to the front of the fender.
4. Remove the two 10mm bolts from above the grill area and one pushpin from behind the grill.
5. Remove the 2 push pins from underneath the head lights.
6. Gently pull the plastic bumper off.
7. Number each hole on the front of the metal bumper from one to twelve (from left to right). Drill a 1/2" hole in the center of the No. 8 hole. See Figure 1.
8. Insert a tape measure in the passenger side of the bumper and measure 12 5/8" over from the center of the hole drilled in Step 7. This will be in the No. 5 hole. Drill a second 1/2" hole.
9. Start a 1/2-13 x 1 1/4 bolt (Item 3) through the backing plate (Item 2) and into the threaded holes in the baseplate (as shown in the diagram on page 2). Apply Loctite and hand tighten.
10. Drill 1/2" holes for the outside braces, use the baseplate as a template. Feed the nut plate (Item 2) into the big hole next to the drilled holes and hand tighten a 1/2-13 x 1 1/2 Hex bolt (Item 4).
11. Drill the two holes for the center braces (3/8"). Feed the 3/8" wire nuts (Item 4) into the underside of the radiator support. Using the 3/8" bolts and washers (Item 7 and 9) thread into the wire nuts.
12. After each bolt has been started, torque nuts and bolts according to the Torque Guide Chart in the General Instruction Sheet.
13. Hold the rock guard up to its original position and mark areas needed to be notched so it can be replaced. Replace the bumper molding.
14. DEALER OR INSTALLER: BE CERTAIN THE USER RECEIVES THE INSTRUCTION SHEET.



Figure 1

Automatic

Tools Required

10MM Wrench	Flathead Screwdriver	Loctite	3/4" Wrench
3/8" Drill Bit	9/16" Wrench	1/2" Drill Bit	Tape Measure
Utility Knife			

Parts List

Ref. No.	Qty.	Part No.	Description
1	1	61-5333	Baseplate, BX3512
2	2	102-5744	Spacer Plate, BX3512
3	2	61-5338	1/2" Nut Plate with Wire
4	2	61-4978	3/8" Whiz Nut with Wire
5	4	203-0012	1/2" Lock Washer
6	2	201-0011	1/2-13 x 1 1/4" Hex Bolt
7	2	201-0440	3/8"-16 x 1 1/2" Hex Bolt
8	2	201-0051	1/2-13 x 1 1/2" Hex Bolt
9	2	203-0010	3/8" Lock Washer
10	2	201-0979	#12-14 x 1" Self Drilling Screw, ZP
11	2	202-0047	#10 Hex Nut
12	2	203-0054	#10 Lock Washer
13	2	201-0192	#10 - 32 x 1/2" Slotted Screw
14	2	101-5822	Adapter, Four Way Electrical Connector

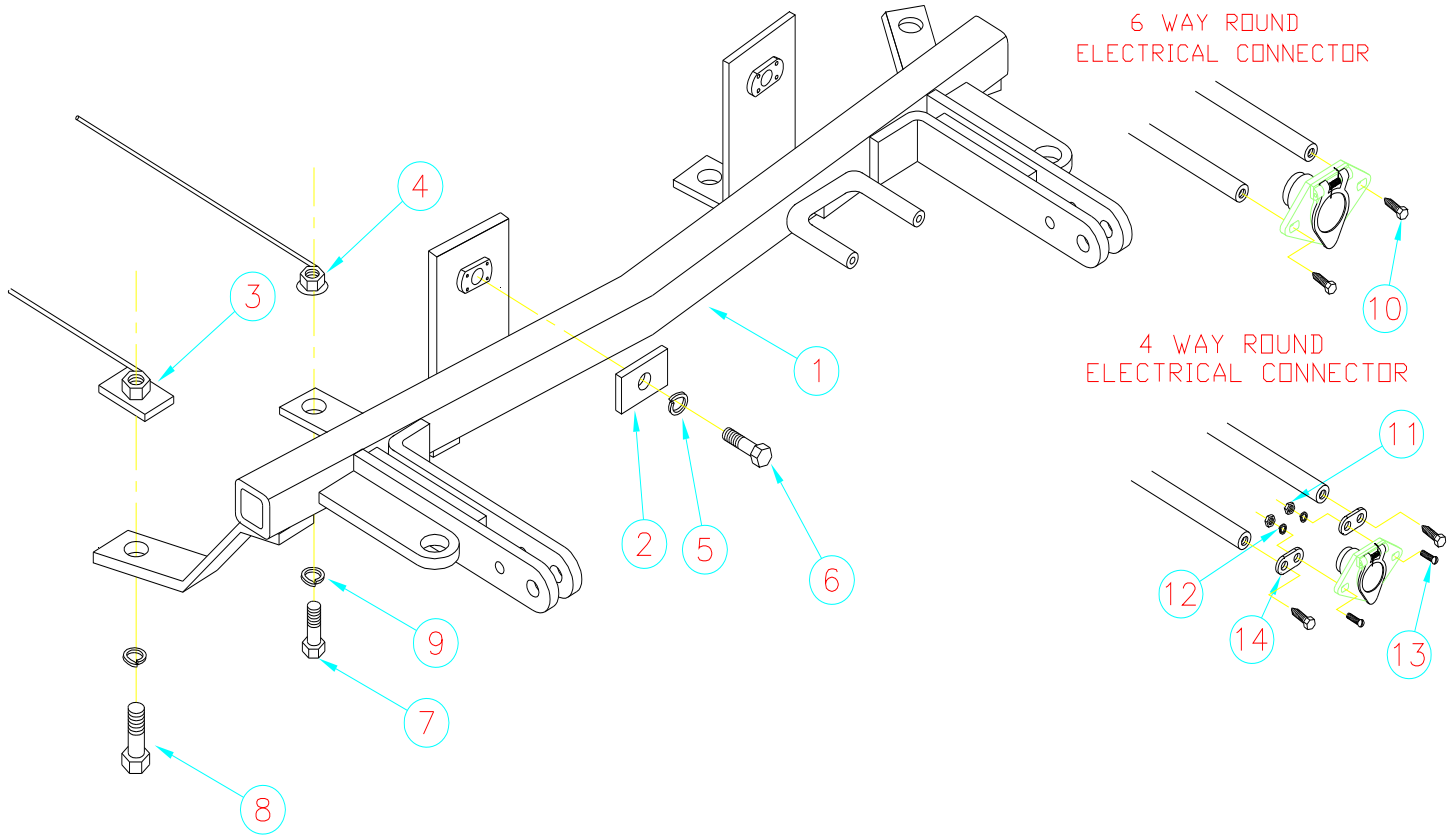

General Information

1. Ensure that your product(s) are registered online at www.blueox.com. It is crucial to register your product(s) so that you may be alerted of product offerings, updates, upgrades, maintenance and safety bulletins, and/or recalls.
2. **It is the owner's responsibility to inspect all towing equipment for cracked welds, missing or worn parts and loose bolts before each towing trip.** Be sure to use Loctite® Red on all bolts and tighten to the recommended specifications.
3. **It is the owner's responsibility to hook up all towing equipment per manufacturer's instructions/recommendations.**
4. Remove the attachment tabs when not in use (if applicable).

Notice To Baseplate Installer

1. It is YOUR responsibility to watch for:

- Oil cooler and air conditioner lines
- Electrical wires and hoses
- Missing parts or attaching points on the frame

** If the baseplate is improperly installed and is against a wire or hose, it could cause fluid leaks or electrical shorts some time after the actual baseplate installation.

Permanent Baseplate Safety Cable Installation

Permanent baseplate safety cables are strongly recommended when towing a vehicle with a tow bar. The principle function of the permanent baseplate safety cables is to prevent the towed vehicle from breaking loose in the event the connection between the frame of the towed vehicle and the baseplate fails or becomes disconnected. The cables must be connected from the baseplate to the frame rail or cross member of the vehicle's frame. The illustrations below show the possible arrangements recommended by Blue Ox®. Each permanent baseplate safety cable must have an adequate weight rating for the towing system. The weight rating of the two (2) cables together will not qualify.

Do not mount the permanent baseplate safety cables against wires, hoses or brake lines.

These permanent baseplate safety cables should remain installed as long as the baseplate is installed on the vehicle. Permanent baseplate safety cables are to be used in conjunction with, and NOT a replacement for legally required safety cables attaching the towed vehicle to the towing vehicle.

OPTION #1

Permanent Baseplate Safety Cables to Cross Member or Frame of Towed Vehicle.



OPTION #2

Permanent Baseplate Safety Cables to Cross Member or Frame of Towed Vehicle.

