



Strong As An Ox™

## BX3228 Installation Instructions 2004-07 Pontiac Grand Prix GT2

Serial No.

The front fascia, horn bracket and headlight assemblies are removed for baseplate installation. Drilling is required. The BX8869 is available for this vehicle. Attachment Tabs are 24 inches center to center and a height of 13 1/2 inches.



1. Remove the five push pins from the top side of fascia.



2. Just behind headlight assembly are two white clips. Pull clips up, unplug electrical and remove headlight assembly, both sides.



3. Remove one metric bolt (white arrow) and loosen one metric nut (black arrow) with the 10MM socket, both sides.



4. Forward of front tires are two metric bolts in wheel well and two metric bolts on the lower edge of fascia to remove with the 7MM socket, both sides.



5. Remove six push pins from the bottom edge of the fascia. Pull fascia forward and set aside.



6. Using the 10MM socket, remove the metric bolt from horn bracket, unplug and set aside.



Strong As An Ox<sup>™</sup>



7. Remove two metric bolts just forward of front tire, in wheel well with the 7MM socket, both sides.



8. Remove push pin from belly pan, both sides. Pull belly pan forward and set aside.

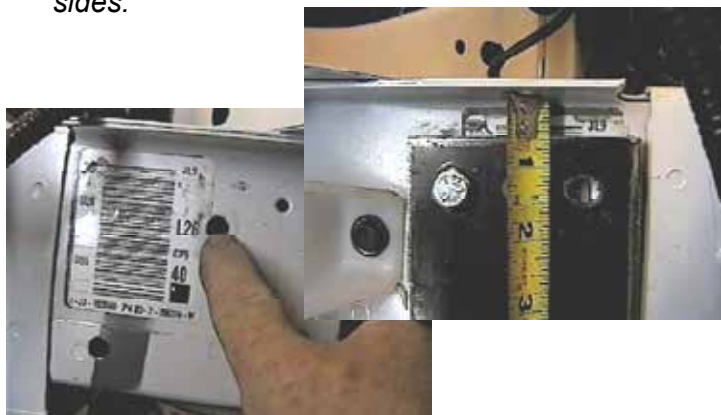

9. Using the 13/32" drill bit, drill out existing hole (showing driver's side), both sides. Slide baseplate ends to align with existing hole. Insert 3/8" nut plate into opening to align with existing hole, install the 3/8" bolt and lock washer according to drawing on last page and tighten. Try to maintain approximately 9/16" spacing between the top of the end plate and ribbing. **Be sure and use loctite on all bolts before tightening. Tighten all bolts according to torque chart in General Instruction sheet.**



10. Using the baseplate as a template, drill the remaining holes with the 13/32" drill bit on both sides while keeping baseplate level. Install the three 3/8" bolts, lock washers and hex nuts on both sides. Tighten all bolts. **Be sure and use loctite on all bolts before tightening. Tighten all bolts according to torque chart in General Instruction sheet.**

11. Reinstall horn and bracket using the existing bolt to it original position. It will be necessary to straighten alignment pin on horn bracket.





Strong As An Ox<sup>™</sup>



**12.** Hold belly pan to original position, trim away area where baseplate will set and reinstall.



*Location for the BX8869 on the driver's side.*

- 13.** Reinstall fascia. Be sure all electrical connections are plugged in properly for lighting system.
- 14.** The dimensional variations between otherwise identical cars can be considerable. While the location and size of the holes in the baseplate were designed to allow for easy installation, it may be necessary to file a hole slightly to allow a bolt to clear.
- 15.** Install the tow bar and safety cables according to the instructions included in their packages.
- 16.** Do **not** substitute other devices if the tow bar pin and clip are lost.
- 17. DEALER OR INSTALLER: BE CERTAIN THE USER RECEIVES THE INSTRUCTION SHEET.**





## Tools Required

9/16" Socket  
7MM Socket

Loctite  
10MM Socket

Utility Knife  
13/32" Drill Bit

## Parts List

Ref. No.	Qty.	Part No.	Description
1	1	61-5920	Weldment, Base Plate, BX3228
2	8	61-5208	3/8-16 Nut Plate
3	8	201-0440	3/8-16 x 1 1/2 Bolt, Grd, 5, ZP
4	8	203-0010	3/8 Lock Washer, ZP
5	2	201-0979	#12-14 x 1" Self Drilling Screw, ZP
6	2	101-5822	Adapter, 4 Way Connector
7	2	201-0192	#10-32 x 1/2 Slot, Rd. Hd. Screw
8	2	203-0054	#10 Lock Washer
9	2	202-0047	#10-32 Hex Nut
10	2	62-3469	Attachment, Assembly, SF/ LB (R)
E	1		Existing bolt for horn bracket on passenger's side
2		226-0046	Baseplate Safety Cable, 36" CL III (Not Shown)
2		229-0359	Quicklink, 3/8, ZP (Not Shown)
2		290-0437	Receiver, Cap Plug (BLK) (Not Shown)

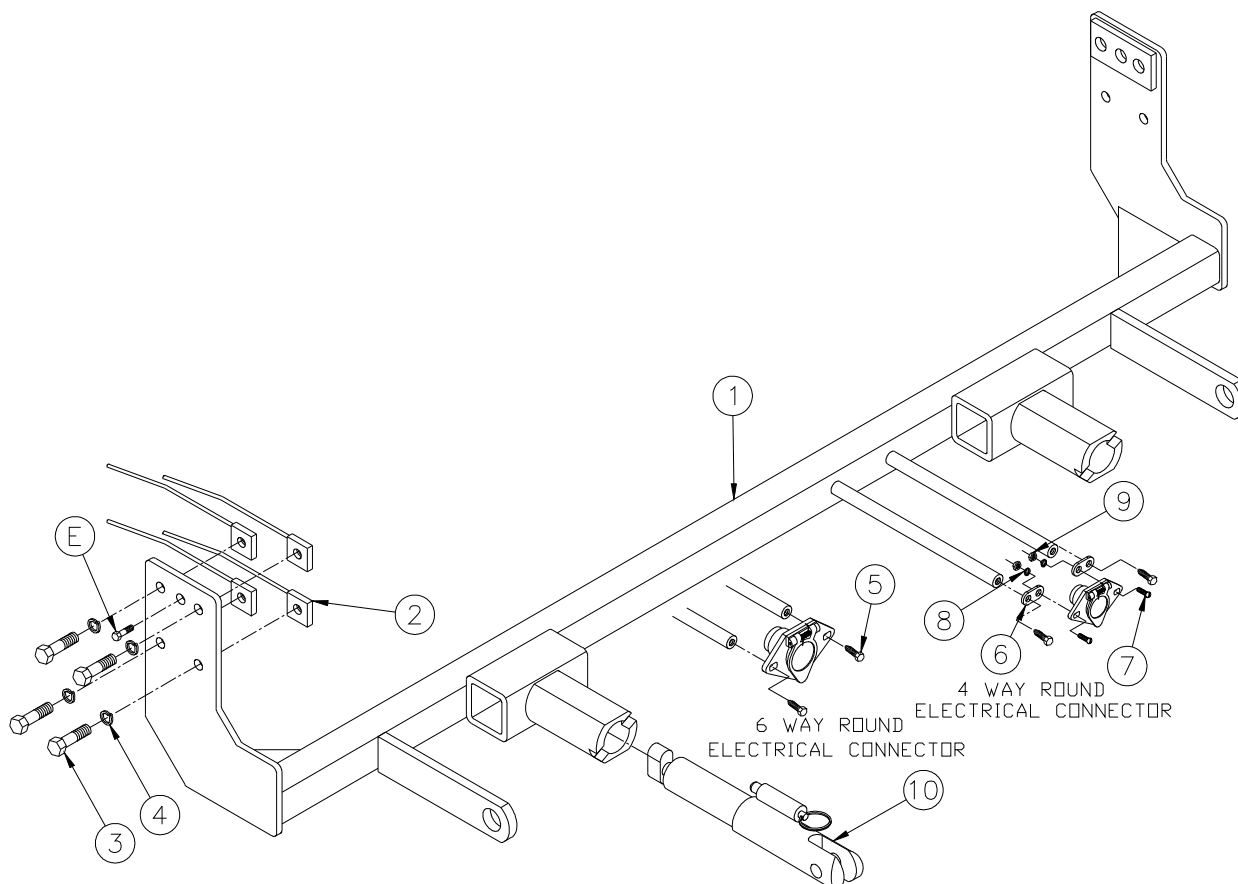

**IMPORTANT:** Use only genuine factory replacement parts on your Base Plate. Do not substitute homemade or nontypical parts. If a bolt is lost or in need of replacement, for your safety and the preservation of your Base Plate, be sure to use a replacement bolt of the same grade (Usually Grade 5, refer to parts list). Repair parts may be ordered through your nearest **Blue Ox** dealer or distributor.

## General Information

1. Ensure that your product(s) are registered online at [www.blueox.com](http://www.blueox.com). It is crucial to register your product(s) so that you may be alerted of product offerings, updates, upgrades, maintenance and safety bulletins, and/or recalls.
2. **It is the owner's responsibility to inspect all towing equipment for cracked welds, missing or worn parts and loose bolts before each towing trip.** Be sure to use Loctite® Red on all bolts and tighten to the recommended specifications.
3. **It is the owner's responsibility to hook up all towing equipment per manufacturer's instructions/ recommendations.**
4. Remove the attachment tabs when not in use (if applicable).

## Notice To Baseplate Installer

1. **It is YOUR responsibility to watch for:**

- Oil cooler and air conditioner lines
- Electrical wires and hoses
- Missing parts or attaching points on the frame

**\*\* If the baseplate is improperly installed and is against a wire or hose, it could cause fluid leaks or electrical shorts some time after the actual baseplate installation.**

## Permanent Baseplate Safety Cable Installation

Permanent baseplate safety cables are strongly recommended when towing a vehicle with a tow bar. The principle function of the permanent baseplate safety cables is to prevent the towed vehicle from breaking loose in the event the connection between the frame of the towed vehicle and the baseplate fails or becomes disconnected. The cables must be connected from the baseplate to the frame rail or cross member of the vehicle's frame. The illustrations below show the possible arrangements recommended by Blue Ox®. Each permanent baseplate safety cable must have an adequate weight rating for the towing system. The weight rating of the two (2) cables together will not qualify.

***Do not mount the permanent baseplate safety cables against wires, hoses or brake lines.***

These permanent baseplate safety cables should remain installed as long as the baseplate is installed on the vehicle. Permanent baseplate safety cables are to be used in conjunction with, and NOT a replacement for legally required safety cables attaching the towed vehicle to the towing vehicle.

### OPTION #1

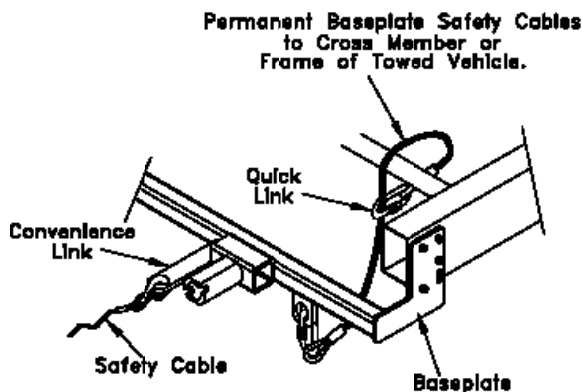

### OPTION #2

