



Strong As An Ox™

BX3227 Installation Instructions 2003 Pontiac Grand Am (Incl. GT)

Serial No.

The front fascia, horn bracket, headlight assemblies and windshield washer reservoir are removed for baseplate installation. Drilling is required. The BX8869 is available for this vehicle. Attachment Tabs are 22 inches center to center and a height of 14 inches.



1. Remove the five push pins from the top side of fascia.



2. Just behind headlight assembly are two clips, pull clips up, unplug electrical and remove headlight assembly, both sides.

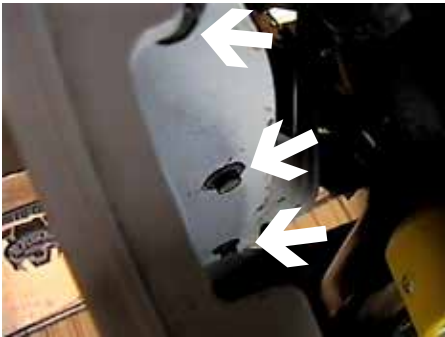

3. Remove three metric bolts using the 10MM socket, just behind headlights on fascia corner, both sides.



4. Forward of front tires, in wheel well, are three christmas tree push pins to remove, both sides.



5. Remove three metric bolts from the bottom side of the fascia, just forward of front tire, with the 10MM socket both sides.



6. Find the two tabs that extend from upper fascia opening back to the bottom of metal bumper and remove two push pins



Strong As An Ox™



7. Using the 10MM socket, remove the metric bolt from horn bracket, unplug and set aside.



8. Remove four metric bolts from wind shield washer reservoir, unplug hoses and electrical and set aside.

9. Slide baseplate on to frame to align with frame knob and reservoir bolt location on driver's side, clamp in place with vise grips. Before drilling holes, place fascia in its original position to make sure that baseplate comes through the grill openings, adjust as needed. Drill all holes with the 13/32" drill bit while assuring that the baseplate is level. Insert item 2 into frame to align with drilled holes and tighten items 4, 5 and 6 according to drawing on last page. **Be sure and use loctite on all bolts before tightening. Tighten all bolts according to torque chart in the General Instruction sheet.**

10. Reinstall horn and bracket, windshield washer reservoir, and fascia. Use item 12 to replace upper reservoir and horn bracket metric bolts. Be sure all electrical lines and hoses are plugged in properly.

11. The dimensional variations between otherwise identical cars can be considerable. While the location and size of the holes in the baseplate were designed to allow for easy installation, it may be necessary to file a hole slightly to allow a bolt to clear.

12. Install the tow bar and safety cables according to the instructions included in their packages.

13. Do **not** substitute other devices if the tow bar pin and clip are lost.

14. **DEALER OR INSTALLER: BE CERTAIN THE USER RECEIVES THE INSTRUCTION SHEET.**





Strong As An Ox™

Tools Required

9/16" Socket
7MM Socket

Loctite
10MM Socket

Vise Grips
13/32" Drill Bit

Parts List

Ref. No.	Qty.	Part No.	Description
1	1	61-5919	Weldment, Base Plate, BX3227
2	10	61-5208	3/8-16 Nut Plate
3	2	62-3468	Attachment Tab, Assembly, SF/ SB (R)
4	2	201-0368	3/8-16 x 1 1/4 Bolt, Grd. 5, ZP
5	8	201-0440	3/8-16 x 1 1/2 Bolt, Grd, 5, ZP
6	10	203-0010	3/8 Lock Washer, ZP
7	2	201-0979	#12-14 x 1" Self Drilling Screw, ZP
8	2	101-5822	Adapter, 4 Way Connector
9	2	201-0192	#10-32 x 1/2 Slot, Rd. Hd. Screw
10	2	203-0054	#10 Lock Washer
11	2	202-0047	#10-32 Hex Nut
	2	201-0655	6MM-1 x 30MM Hex Bolt, Grd. 8.8(Not shown, replacement for horn bracket and washer reservoir)
	2	226-0046	Baseplate Safety Cable, 36" CL III (Not Shown)
	2	229-0359	Quicklink, 3/8, ZP (Not Shown)
	2	290-0437	Receiver, Cap Plug (BLK) (Not Shown)

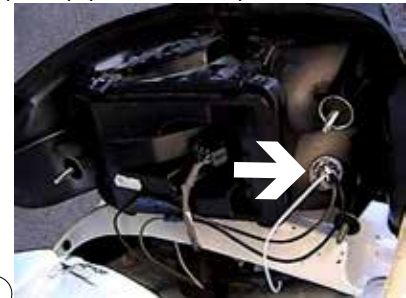
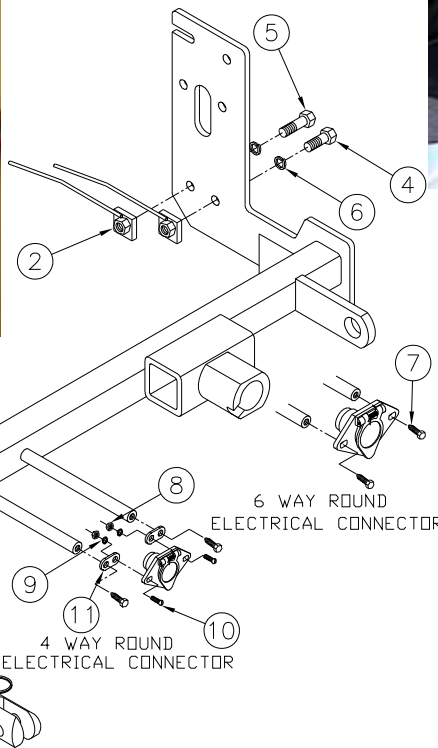

Location for the BX8869 on the passenger's side.

IMPORTANT: Use only genuine factory replacement parts on your Base Plate. Do not substitute homemade or nontypical parts. If a bolt is lost or in need of replacement, for your safety and the preservation of your Base Plate, be sure to use a replacement bolt of the same grade (Usually Grade 5, refer to parts list). Repair parts may be ordered through your nearest **Blue Ox** dealer or distributor.

General Information

1. Ensure that your product(s) are registered online at www.blueox.com. It is crucial to register your product(s) so that you may be alerted of product offerings, updates, upgrades, maintenance and safety bulletins, and/or recalls.
2. **It is the owner's responsibility to inspect all towing equipment for cracked welds, missing or worn parts and loose bolts before each towing trip.** Be sure to use Loctite® Red on all bolts and tighten to the recommended specifications.
3. **It is the owner's responsibility to hook up all towing equipment per manufacturer's instructions/recommendations.**
4. Remove the attachment tabs when not in use (if applicable).

Notice To Baseplate Installer

1. It is YOUR responsibility to watch for:

- Oil cooler and air conditioner lines
- Electrical wires and hoses
- Missing parts or attaching points on the frame

** If the baseplate is improperly installed and is against a wire or hose, it could cause fluid leaks or electrical shorts some time after the actual baseplate installation.

Permanent Baseplate Safety Cable Installation

Permanent baseplate safety cables are strongly recommended when towing a vehicle with a tow bar. The principle function of the permanent baseplate safety cables is to prevent the towed vehicle from breaking loose in the event the connection between the frame of the towed vehicle and the baseplate fails or becomes disconnected. The cables must be connected from the baseplate to the frame rail or cross member of the vehicle's frame. The illustrations below show the possible arrangements recommended by Blue Ox®. Each permanent baseplate safety cable must have an adequate weight rating for the towing system. The weight rating of the two (2) cables together will not qualify.

Do not mount the permanent baseplate safety cables against wires, hoses or brake lines.

These permanent baseplate safety cables should remain installed as long as the baseplate is installed on the vehicle. Permanent baseplate safety cables are to be used in conjunction with, and NOT a replacement for legally required safety cables attaching the towed vehicle to the towing vehicle.

OPTION #1

Permanent Baseplate Safety Cables to Cross Member or Frame of Towed Vehicle.

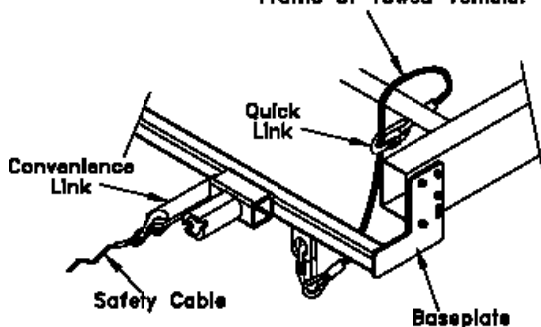

OPTION #2

Permanent Baseplate Safety Cables to Cross Member or Frame of Towed Vehicle.

