



BX2704 Installation Instructions

1998-02 KIA Sportage EX (2WD/4WD, 4 Door)

Installation of this baseplate requires drilling two 3/8 inch holes. Turn signals, grill, headlights and bumper molding need to be removed to install the baseplate.

1. Open the hood and notice that behind each turn signal assembly is a release handle. Pull the handle and remove the turn signals from their holding positions. Be sure to disconnect the electrical wiring from turn signals.
2. Remove the seven top push pins with phillips screw heads on the black plastic cover of grill and hood release. The center grill can now be removed. Pull the top plastic push pins. On the right hand lower side of the KIA logo is a phillips screw, remove. Reach behind the center grill and release (push in) the four clips molded to the grill. Set grill aside.
3. Remove the four-10mm Hex head bolts holding each headlight and set them aside. Unplug the electrical connectors and set aside.
4. Notice the plastic molded piece just above the bumper molding. Remove the three-10mm Hex head bolts (one on the top and two on the bottom). It is necessary to push down on the bumper to have access to the lower bolts.
5. Remove the eight plastic phillip head screw/pins in the upper plastic of the grill opening of bumper molding. Next remove the two-10mm Hex head bolts on the inside of the bumper molding just in front of the front tires. There are three longer plastic phillips head screws/pins in the upper plastic of the grill opening, remove them. On the bottom of the bumper molding remove the two shorter plastic screws/pins. The bumper can now be removed. Lift up on the top of the bumper molding to pull off.
6. Clamp the baseplate to the two brackets in front of the tubular cross frame protecting the radiator. Use the baseplate as a template and drill the 3/8" holes in the sides of the brackets. Use the 3/8" x 1" bolts, lock washer and nuts. Be sure the baseplate is squarely positioned on the brackets while doing this step.

The dimensional variations between otherwise identical cars can be considerable. While the location and size of the holes in the baseplate were designed to allow for easy installation, it may be necessary to file a hole slightly.

7. Hold the two braces up so the bends go inboard. Use the 3/8" x 1 1/2" bolts and hold each brace so they extend straight back to the frame bracket extended down from the main frame. The braces should be placed above the stabilizer bars. Mark and drill the back holes for the braces NOTE: Braces will not set flush against the frame bracket. They will pull into the frame when tightened. Once all bolt holes have been drilled and the bolts started, tighten and torque bolts according to the chart in the General Instruction Sheet.
8. Replace the bumper molding, headlights and turn signals reversing steps 1 through 5.
9. Install the tow bar and safety cables according to the instructions included in their packages. Do not substitute other devices if the tow bar pin and clip are lost.
10. DEALER OR INSTALLER: BE CERTAIN THE USER RECEIVES THE INSTRUCTION SHEET.

Automatic

Tools Required

10MM Wrench
10MM Socket
Phillips Screw Driver

Loctite
Long Socket Extension

3/8" Drill Bit

Parts List

Ref. No.	Qty.	Part No.	Description
1	1	61-5326	Weldment, Baseplate
2	2	102-5719	Brace, BX2704
3	6	201-0443	3/8"-16 x 1" Hex Bolt, Grade 5
4	2	201-0440	3/8"-16 x 1 1/2" Hex Bolt, Grade 5
5	8	203-0010	3/8" Lock Washer
6	6	202-0003	3/8" Hex Nut
7	2	61-4902	3/8" Wire Nut
8	2	201-0655	6mm-1 x 30mm Hex Bolt, Grade 5 (not shown)
9	2	203-0008	1/4 Lock Washer (not shown)
10	2	201-0979	#12-14 x 1" Self Drilling Screw, ZP (not shown)
11	2	202-0047	#10-32 Hex Nut (not shown)
12	2	203-0054	#10 Lock Washer (not shown)
13	2	201-0192	#10-32 x 1/2" Slotted Screw (not shown)
14	2	101-5822	Adapter, 4 Way Connector (not Shown)

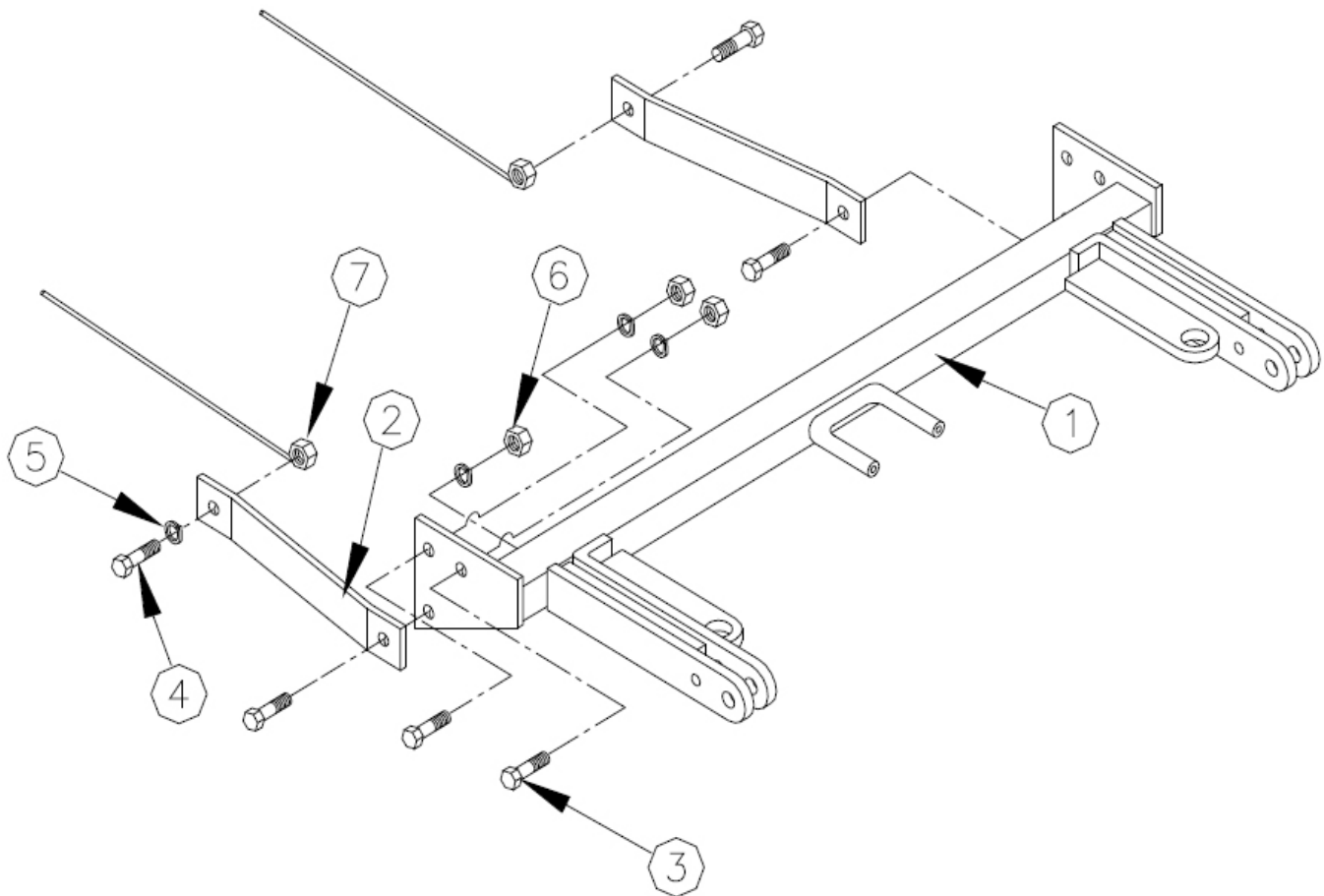

General Information

1. Ensure that your product(s) are registered online at www.blueox.com. It is crucial to register your product(s) so that you may be alerted of product offerings, updates, upgrades, maintenance and safety bulletins, and/or recalls.
2. **It is the owner's responsibility to inspect all towing equipment for cracked welds, missing or worn parts and loose bolts before each towing trip.** Be sure to use Loctite® Red on all bolts and tighten to the recommended specifications.
3. **It is the owner's responsibility to hook up all towing equipment per manufacturer's instructions/ recommendations.**
4. Remove the attachment tabs when not in use (if applicable).

Notice To Baseplate Installer

1. **It is YOUR responsibility to watch for:**

- Oil cooler and air conditioner lines
- Electrical wires and hoses
- Missing parts or attaching points on the frame

**** If the baseplate is improperly installed and is against a wire or hose, it could cause fluid leaks or electrical shorts some time after the actual baseplate installation.**

Permanent Baseplate Safety Cable Installation

Permanent baseplate safety cables are strongly recommended when towing a vehicle with a tow bar. The principle function of the permanent baseplate safety cables is to prevent the towed vehicle from breaking loose in the event the connection between the frame of the towed vehicle and the baseplate fails or becomes disconnected. The cables must be connected from the baseplate to the frame rail or cross member of the vehicle's frame. The illustrations below show the possible arrangements recommended by Blue Ox®. Each permanent baseplate safety cable must have an adequate weight rating for the towing system. The weight rating of the two (2) cables together will not qualify.

Do not mount the permanent baseplate safety cables against wires, hoses or brake lines.

These permanent baseplate safety cables should remain installed as long as the baseplate is installed on the vehicle. Permanent baseplate safety cables are to be used in conjunction with, and NOT a replacement for legally required safety cables attaching the towed vehicle to the towing vehicle.

OPTION #1

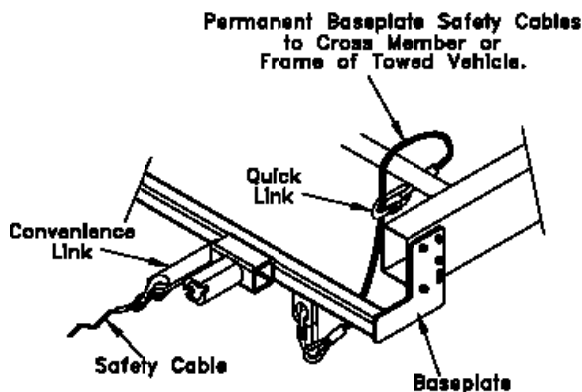

OPTION #2

