



**Installation Instructions BX2515
Mazda MPV 2000**

Serial No.

The front bumper fascia, blinkers and tow hook brackets are removed for baseplate installation. Holes need to be drilled and the grill needs to be trimmed. BE CERTAIN USER RECEIVES INSTRUCTION SHEET.



Figure 1

1. Open the hood and remove the Phillips screws and push pins from top of the bumper fascia. Figure 1 and 2.

2. Remove the Phillips push pins holding the blinker assembly and pull each assembly straight forward from vehicle. Figure 3. Disconnect assembly and set aside.



Figure 5



Figure 2

3. Remove the push pins that are underneath the blinker assembly (each side). Figure 4.

4. Remove the Phillip screw and push pins directly forward of the tire in fender wells. Figure 5.



Figure 6

5. Remove Phillips head push pins and Hex bolts from bottom of bumper fascia. Figure 6. Remove fascia and set aside.



Figure 3

6. Loosen the top four bolts and remove the bottom three bolts from each tow hook bracket. Figure 7 Hold the baseplate straight up sandwiched between the frame and the tow hook brackets aligned with the bottom three holes of the tow brackets. Use the hardware shown in drawing on last page and fasten baseplate to frame. Figure 8. Tighten bolts according to Torque Chart in the General Instruction Sheet.



Figure 7



Figure 4

7. Drill remaining hole (both sides). Use hardware shown from last page and tighten remaining 3/8" bolts. Figure 8.



Figure 8

8. The center grille needs to be trimmed to allow for the tabs. Hold fascia in place to mark and trim grille. Once this is done replace fascia and blinkers. Figure 9.

Automatic

Tools Required



10MM Wrench
3/8" Drill Bit
Phillips Screw Driver

9/16" Wrench
14MM Wrench

Loctite Blue
Utility Knife

Figure 9

Parts List

Ref. No.	Qty.	Part No.	Description
1	1	61-5472	Weldment, Baseplate, BX2515
2	2	61-4092	3/8 Square Nut with Wire
3	6	201-0495	10mm-1.25 x 45mm Hex Bolt, ZP
4	2	201-0440	3/8-16 x 1 1/2 Hex Bolt, Grade 5
5	6	203-0104	10mm Lock Washer
6	2	203-0010	3/8 Lock Washer
7	2	201-0979	#12-14 x 1" Self Drilling Screw, ZP
8	2	203-0054	#10 Lock washer
9	2	101-5822	Adapter, 4 way Connector
10	2	201-0192	#10-32 x 1/2 Slot, Rd. Hd Screw
11	2	202-0047	#10-32 Hex Nut
12	2	62-3468	Assembly, Removable Tabs, SF/SB, ZP
	2	226-0046	Baseplate Safety Cable, 36" CL III (Not Shown)
	2	229-0359	Quicklink, 3/8, ZP (Not Shown)
	2	290-0437	Receiver, Cap Plug (BLK) (Not Shown)

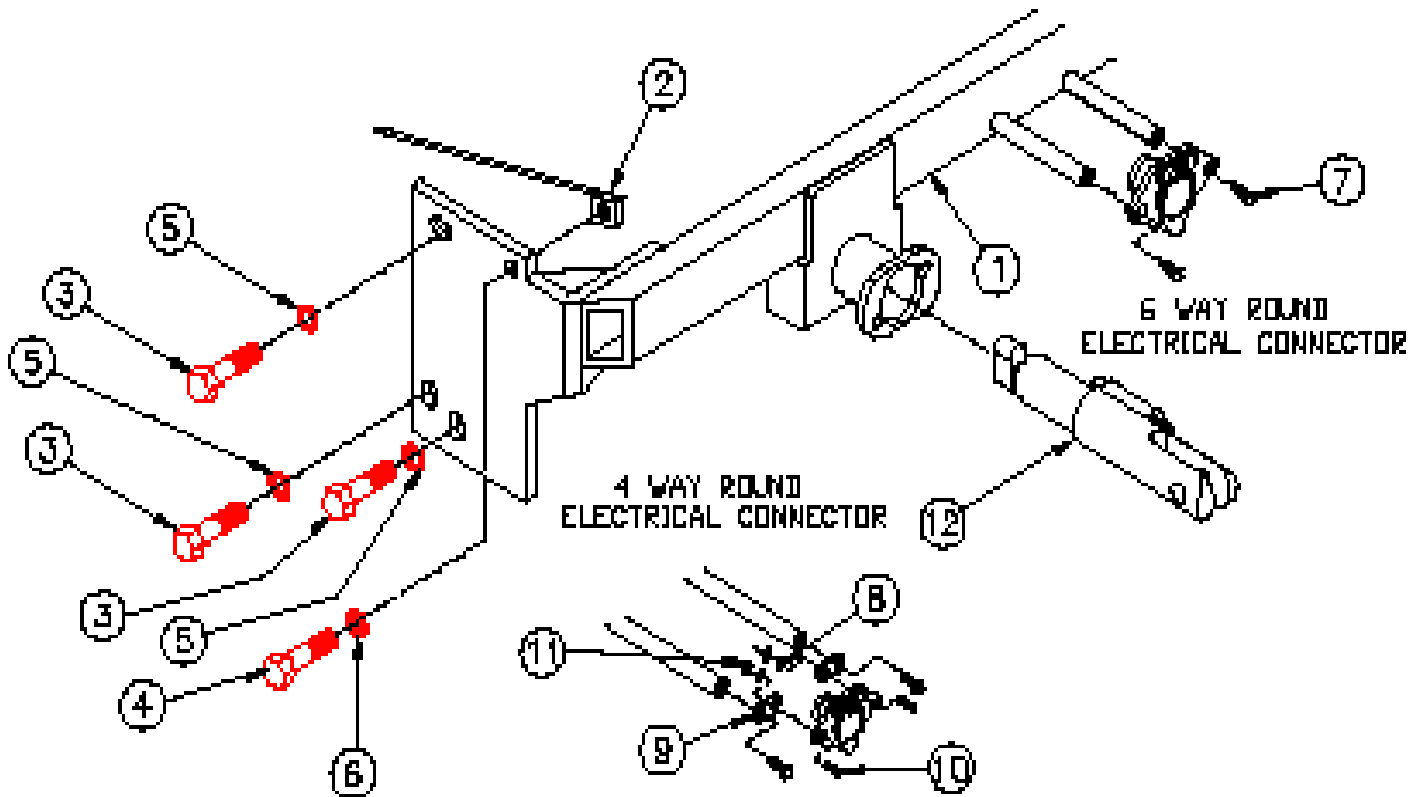

General Information

1. Ensure that your product(s) are registered online at www.blueox.com. It is crucial to register your product(s) so that you may be alerted of product offerings, updates, upgrades, maintenance and safety bulletins, and/or recalls.
2. **It is the owner's responsibility to inspect all towing equipment for cracked welds, missing or worn parts and loose bolts before each towing trip.** Be sure to use Loctite® Red on all bolts and tighten to the recommended specifications.
3. **It is the owner's responsibility to hook up all towing equipment per manufacturer's instructions/recommendations.**
4. Remove the attachment tabs when not in use (if applicable).

Notice To Baseplate Installer

1. It is YOUR responsibility to watch for:

- Oil cooler and air conditioner lines
- Electrical wires and hoses
- Missing parts or attaching points on the frame

** If the baseplate is improperly installed and is against a wire or hose, it could cause fluid leaks or electrical shorts some time after the actual baseplate installation.

Permanent Baseplate Safety Cable Installation

Permanent baseplate safety cables are strongly recommended when towing a vehicle with a tow bar. The principle function of the permanent baseplate safety cables is to prevent the towed vehicle from breaking loose in the event the connection between the frame of the towed vehicle and the baseplate fails or becomes disconnected. The cables must be connected from the baseplate to the frame rail or cross member of the vehicle's frame. The illustrations below show the possible arrangements recommended by Blue Ox®. Each permanent baseplate safety cable must have an adequate weight rating for the towing system. The weight rating of the two (2) cables together will not qualify.

Do not mount the permanent baseplate safety cables against wires, hoses or brake lines.

These permanent baseplate safety cables should remain installed as long as the baseplate is installed on the vehicle. Permanent baseplate safety cables are to be used in conjunction with, and NOT a replacement for legally required safety cables attaching the towed vehicle to the towing vehicle.

OPTION #1

Permanent Baseplate Safety Cables to Cross Member or Frame of Towed Vehicle.

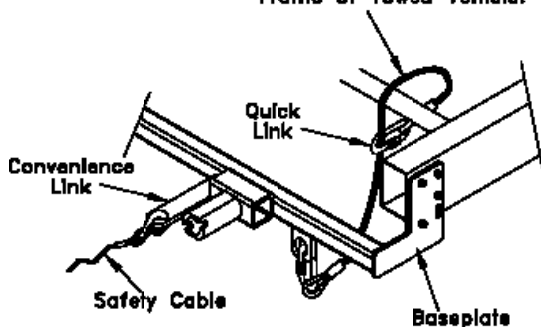

OPTION #2

Permanent Baseplate Safety Cables to Cross Member or Frame of Towed Vehicle.

