



## Installation Instruction BX2403

### Isuzu Rodeo 1998-2002

### Isuzu Amigo 1998-01 4WD

### Honda Passport 1998-02

The steel belly pan will need to be removed for installation of the baseplate. The baseplate is bolted between the tow hooks and uses the front bolt holes used by the steel belly pan. The main weldment will be exposed after installation.

1. There are four bolts that hold the steel belly pan. First remove the two back bolts with a 14mm wrench. Then loosen the front two bolts, slide the belly pan back and remove. Remove the two front bolts completely.
2. Position the baseplate between the two tow hooks, there are existing holes that match to the baseplates bolt holes. Use the 3/8 x 1 1/4" bolts, 3/8" lock washer and nut (Items 3, 5 and 6) on the back holes. Use the 3/8 x 1 1/2" bolts (Item 2) for the front holes that extend through the baseplate tube. Use Loctite Blue on each bolt to ensure they do not loosen while the car is being towed.
3. The back braces of the baseplate will match to the holes used by the steel belly pan. Hold the baseplate up to the metal frame then replace the steel belly pan. Use the 10mm - 1.25 x 30mm bolts with 10mm lock washer (Items 4 and 7) for the front holes. Use the original bolts for the back of the belly pan. Tighten all bolts.
4. The dimensional variations between otherwise identical cars can be considerable. While the location and size of the holes in the baseplate were designed to allow for easy installation, it may be necessary to ream a hole slightly to allow a bolt to clear.
5. Install the tow bar and safety cables according to the instructions included in the pack6. Do not substitute other devices if the tow bar pin and clip are lost.
7. DEALER OR INSTALLER: BE CERTAIN THE USER RECEIVES THE INSTRUCTION SHEET.

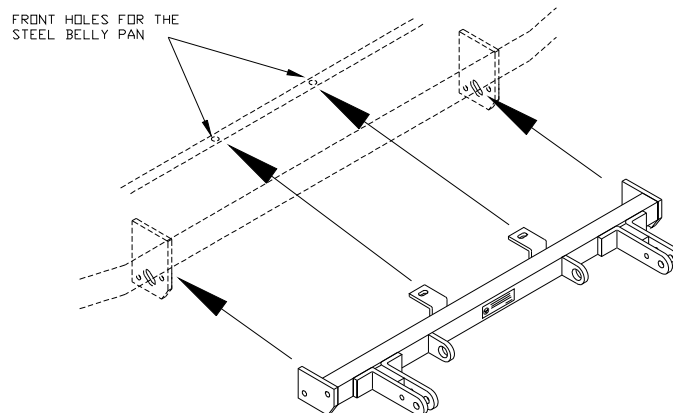

# Automatic

## Tools Required

14MM Wrench  
9/16" Wrench

14MM Socket  
9/16" Socket

Loctite Blue

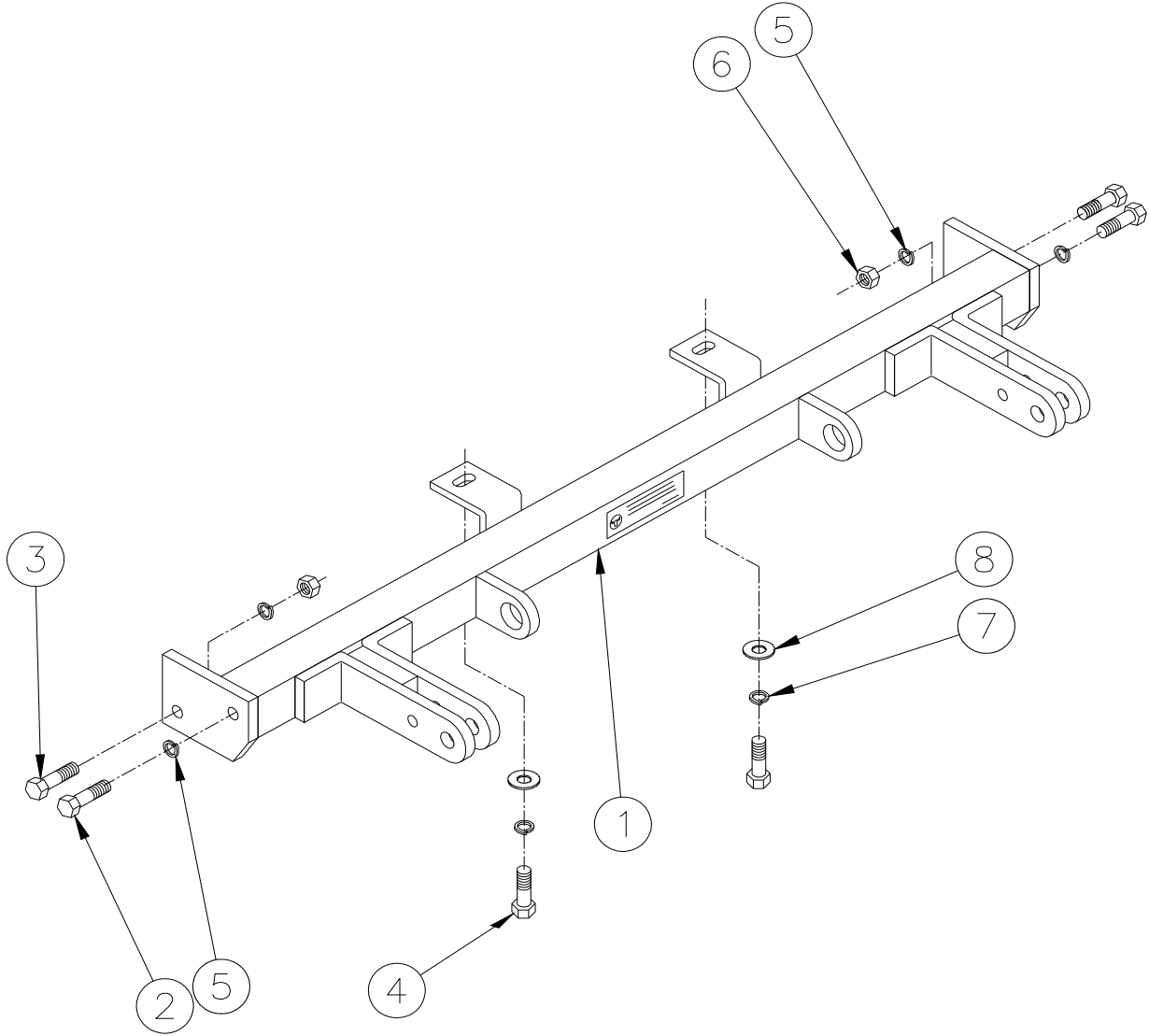

## Parts List

Ref. No.	Qty.	Part No.	Description
1.	1	61-5193	Weldment Baseplate BX2403
2.	2	201-0440	3/8-16 x 1 1/2 Hex Bolt, Grade 5
3.	2	201-0368	3/8-16 x 1 1/4 Hex Bolt, Grade 5
4.	2	201-0422	10MM-1.25 x 30MM Hex Bolt, Grade 8.8
5.	4	203-0010	3/8 Lock Washer
6.	2	202-0003	3/8 - 16 Hex Nut
7.	2	203-0104	10MM Lock Washer
8.	2	203-0103	10MM Flat Washer
	2	226-0046	Baseplate Safety Cable, 36" CL III (Not Shown)
	4	229-0359	Quicklink, 3/8, ZP (Not Shown)

# General Information

1. Ensure that your product(s) are registered online at [www.blueox.com](http://www.blueox.com). It is crucial to register your product(s) so that you may be alerted of product offerings, updates, upgrades, maintenance and safety bulletins, and/or recalls.
2. **It is the owner's responsibility to inspect all towing equipment for cracked welds, missing or worn parts and loose bolts before each towing trip.** Be sure to use Loctite® Red on all bolts and tighten to the recommended specifications.
3. **It is the owner's responsibility to hook up all towing equipment per manufacturer's instructions/recommendations.**
4. Remove the attachment tabs when not in use (if applicable).

## Notice To Baseplate Installer

### 1. It is YOUR responsibility to watch for:

- Oil cooler and air conditioner lines
- Electrical wires and hoses
- Missing parts or attaching points on the frame

\*\* If the baseplate is improperly installed and is against a wire or hose, it could cause fluid leaks or electrical shorts some time after the actual baseplate installation.

## Permanent Baseplate Safety Cable Installation

Permanent baseplate safety cables are strongly recommended when towing a vehicle with a tow bar. The principle function of the permanent baseplate safety cables is to prevent the towed vehicle from breaking loose in the event the connection between the frame of the towed vehicle and the baseplate fails or becomes disconnected. The cables must be connected from the baseplate to the frame rail or cross member of the vehicle's frame. The illustrations below show the possible arrangements recommended by Blue Ox®. Each permanent baseplate safety cable must have an adequate weight rating for the towing system. The weight rating of the two (2) cables together will not qualify.

***Do not mount the permanent baseplate safety cables against wires, hoses or brake lines.***

These permanent baseplate safety cables should remain installed as long as the baseplate is installed on the vehicle. Permanent baseplate safety cables are to be used in conjunction with, and NOT a replacement for legally required safety cables attaching the towed vehicle to the towing vehicle.

### OPTION #1

Permanent Baseplate Safety Cables to Cross Member or Frame of Towed Vehicle.



### OPTION #2

Permanent Baseplate Safety Cables to Cross Member or Frame of Towed Vehicle.

