



Installation Instructions BX2310 Hyundai Tiburon 2000-01

Serial No.

The front bumper fascia and turn lights are removed for baseplate installation. Holes need to be drilled.
DEALER OR INSTALLER: BE CERTAIN THE USER RECEIVES THE INSTRUCTION SHEET.



Figure 1

1. Remove the lower screw from the bottom of the bumper fascia. Figure 1.



Figure 5

2. Looking up to the back side of the front grill, remove the Phillips screw and 10mm Hex bolt just above the Phillips screw. Figure 2 and 3.



Figure 2

3. Remove the push pins and screw forward of the front tires. Figure 4.



Figure 6

4. Open the hood and remove the screw on top of the headlight assembly. Figure 5. Pull the assembly out and remove the Hex nut holding the bumper fascia. Figure 6.



Figure 3

5. Remove the push pins from the top of the bumper fascia, remove the top molding and pull fascia from the vehicle. Figure 7.



Figure 7

6. Remove the Hex bolts from the sides of the frame and the Hex bolt from the lower cross member (drivers side). Bolt the baseplate to the frame and cross member using same bolts. Figures 8.



Figure 4



Figure 8

Automatic



Figure 9

7. Drill a 3/8" hole for the passengers side brace and use 3/8" hardware to fasten to frame. Tighten all bolts according to the chart in the General Instruction Sheet. Figure 9. The 3/8" nut plate can be inserted through the large opening in the cross member. Figure 10.

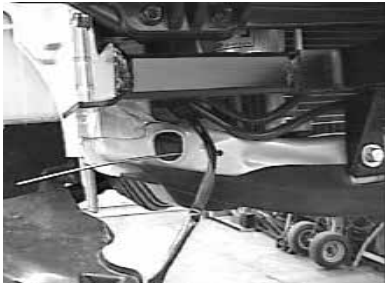

Figure 10

8. Replace the bumper facia and head lights. The 10mm bolt that is removed in step 2 will not be replaced.

Tools Required

8MM Wrench

9/16" Wrench

Loctite 3/8" Drill Bit

14MM Wrench

Needle Nose Pliers

Phillips Screw Driver



Parts List

Ref. No.	Qty.	Part No.	Description
1	1	61-5469	Weldment, Baseplate, BX2310
2	2	61-5208	3/8 Nut Plate 1/4 x 1 x 1 With 14 Inch Wire
3	1	201-0440	3/8-16 x 1 1/2 Hex Bolt Grd. 5 ZP
4	1	203-0010	3/8 Lock Washer, ZP
5	1	201-0446	8MM-1.25 x 30MM Hex Bolt Grd. 5, ZP
6	1	203-0102	8MM Lock Washer, ZP
7	2	201-0979	#12-14 x 1" Self Drilling Screw, ZP
8	2	201-0192	#10-32 x 1/2 Slot, Rd. Hd. Screw
9	2	202-0047	#10-32 Hex Nut
10	2	203-0054	#10 Lock Washer
11	2	101-5822	Adapter, 4 Way Connector
E	4		Existing Bolts, Side Frame

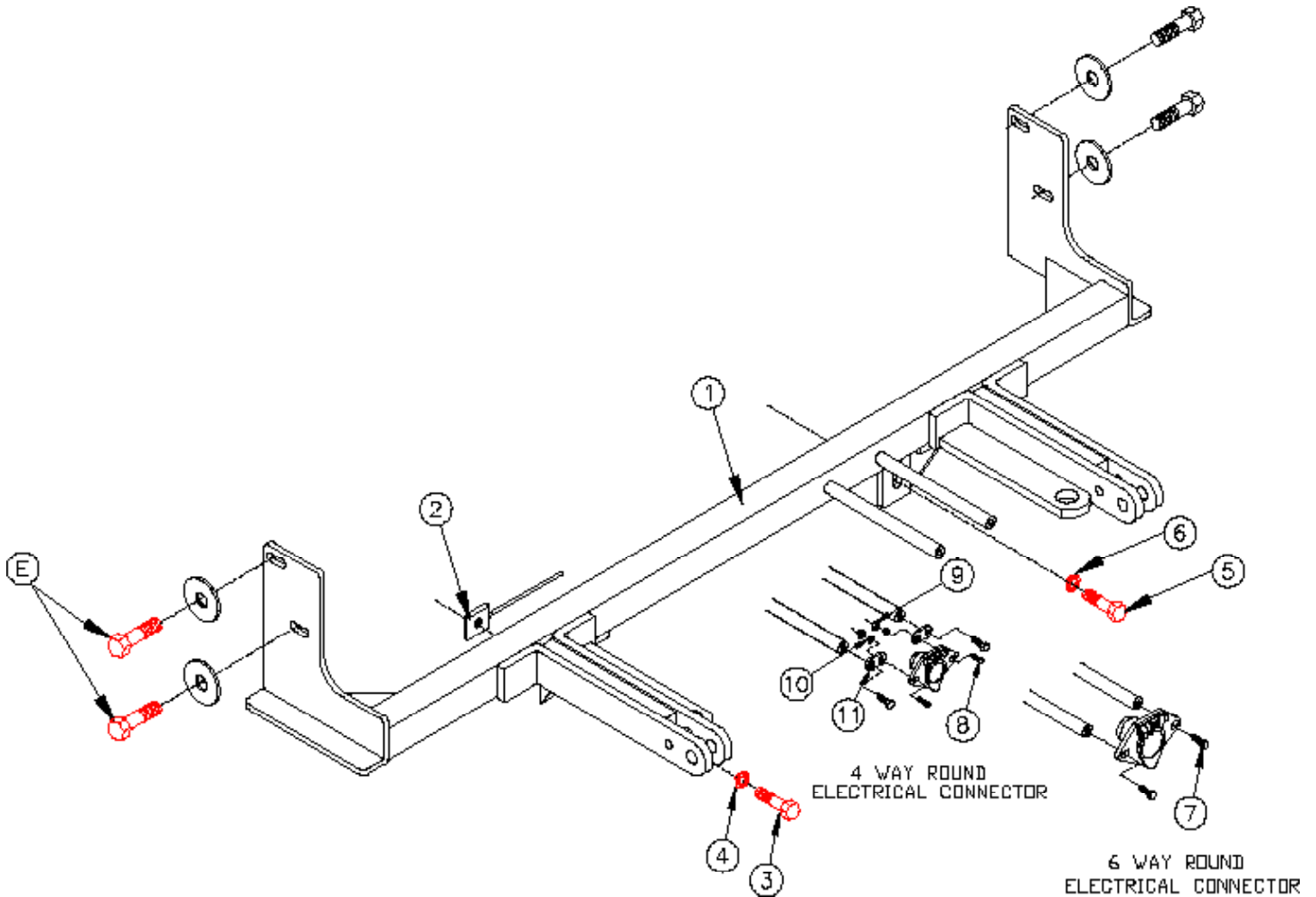

General Information

1. Ensure that your product(s) are registered online at www.blueox.com. It is crucial to register your product(s) so that you may be alerted of product offerings, updates, upgrades, maintenance and safety bulletins, and/or recalls.
2. **It is the owner's responsibility to inspect all towing equipment for cracked welds, missing or worn parts and loose bolts before each towing trip.** Be sure to use Loctite® Red on all bolts and tighten to the recommended specifications.
3. **It is the owner's responsibility to hook up all towing equipment per manufacturer's instructions/recommendations.**
4. Remove the attachment tabs when not in use (if applicable).

Notice To Baseplate Installer

1. It is YOUR responsibility to watch for:

- Oil cooler and air conditioner lines
- Electrical wires and hoses
- Missing parts or attaching points on the frame

** If the baseplate is improperly installed and is against a wire or hose, it could cause fluid leaks or electrical shorts some time after the actual baseplate installation.

Permanent Baseplate Safety Cable Installation

Permanent baseplate safety cables are strongly recommended when towing a vehicle with a tow bar. The principle function of the permanent baseplate safety cables is to prevent the towed vehicle from breaking loose in the event the connection between the frame of the towed vehicle and the baseplate fails or becomes disconnected. The cables must be connected from the baseplate to the frame rail or cross member of the vehicle's frame. The illustrations below show the possible arrangements recommended by Blue Ox®. Each permanent baseplate safety cable must have an adequate weight rating for the towing system. The weight rating of the two (2) cables together will not qualify.

Do not mount the permanent baseplate safety cables against wires, hoses or brake lines.

These permanent baseplate safety cables should remain installed as long as the baseplate is installed on the vehicle. Permanent baseplate safety cables are to be used in conjunction with, and NOT a replacement for legally required safety cables attaching the towed vehicle to the towing vehicle.

OPTION #1

Permanent Baseplate Safety Cables to Cross Member or Frame of Towed Vehicle.

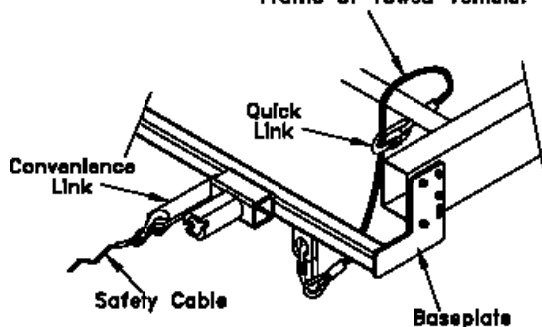

OPTION #2

Permanent Baseplate Safety Cables to Cross Member or Frame of Towed Vehicle.

