



BX2153 Installation Instructions 2000-07 Ford Taurus (Not High Output)

Serial No.

The front bumper fascia and headlights are removed for baseplate installation. Holes need to be drilled.
DEALER OR INSTALLER: BE CERTAIN THE USER RECEIVES THE INSTRUCTION SHEET.



Figure 1

1. Open hood and remove push pins from the top of the bumper fascia and center grill. Figure 1.



Figure 5

2. Remove the two pins holding each headlight assembly. Figure 2.



Figure 2

3. Remove the small Hex head screw holding the inside of the head light assemblies. Figure 3. Pull headlights out, disconnect wiring and set aside.

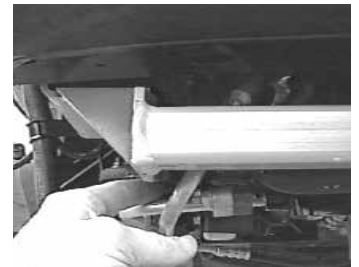

Figure 6

4. Remove the headlights, and remove the two Hex bolts behind them. Figure 4.



Figure 3

5. Remove the lower push pins and screws holding the bottom of the fascia and the plastic forward of the tires in the fender well. Pull molding out and remove the Hex screw connecting the fenders and fascia. Figure 5. Pull fascia from vehicle.



Figure 7

6. Place baseplate up to the frame behind the bumper. Passenger side first, being careful of the hoses below bumper, mark all holes and drill 3/8" holes. Figure 6 and 7.



Figure 4

7. Insert the wire nut plates through the slotted hole on the side of the frame. Figure 8. Position wire nut plates to each hole, apply Loctite to the 3/8" bolts with lock washer and thread into nut plates. Once the bolts have all been started, tighten according to chart in the General instruction sheet.



Figure 8

Automatic



Figure 9

8. Replace bumper fascia and headlights. The attachment tabs will fit through the grill without having to be trimmed. Figure 9.

Tools Required

- | | | | |
|-----------------------|--------------|--------------|----------------|
| 12MM Wrench | 9/16" Wrench | Loctite Blue | 3/8" Drill Bit |
| 14MM Wrench | 8MM Wrench | 7/16" Wrench | 7/32" Socket |
| Phillips Screw Driver | | | |

Parts List

Ref. No.	Qty.	Part No.	Description
1	1	61-5468	Weldment, Base Plate, BX2153
2	8	201-0440	3/8-16 x 1 1/2 Hex Bolt Grd. 5 ZP
3	8	203-0010	3/8 Lock Washer, ZP
4	8	61-5208	3/8 Nut Plate 1/4 x 1 x 1 With 14 Inch Wire
5	2	201-0979	#12-14 x 1" Self Drilling Screw, ZP
6	2	202-0047	#10-32 Hex Nut
7	2	203-0054	#10 Lock Washer
8	2	201-0192	#10-32 x 1/2 Solt, RD. Screw
9	2	101-5822	Adapter, 4 Way Connector
	2	226-0046	Baseplate Safety Cable, 36" CL III (Not Shown)
	4	229-0359	Quicklink, 3/8, ZP (Not Shown)

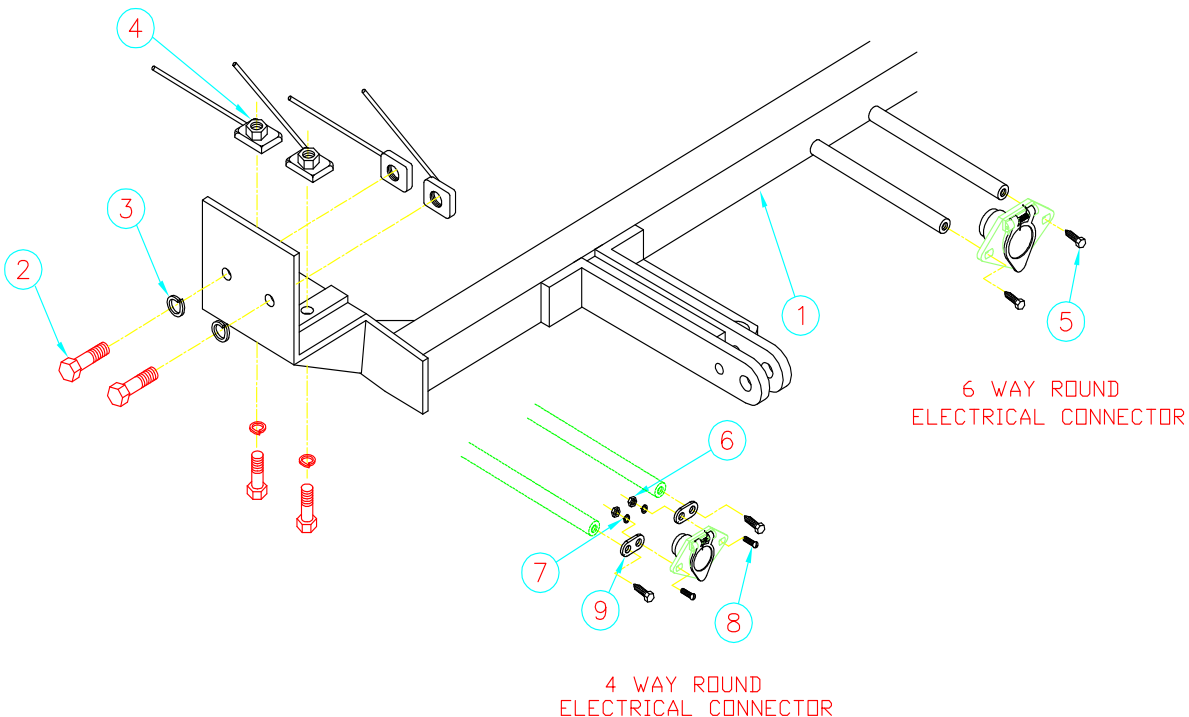

General Information

1. Ensure that your product(s) are registered online at www.blueox.com. It is crucial to register your product(s) so that you may be alerted of product offerings, updates, upgrades, maintenance and safety bulletins, and/or recalls.
2. **It is the owner's responsibility to inspect all towing equipment for cracked welds, missing or worn parts and loose bolts before each towing trip.** Be sure to use Loctite® Red on all bolts and tighten to the recommended specifications.
3. **It is the owner's responsibility to hook up all towing equipment per manufacturer's instructions/recommendations.**
4. Remove the attachment tabs when not in use (if applicable).

Notice To Baseplate Installer

1. It is YOUR responsibility to watch for:

- Oil cooler and air conditioner lines
- Electrical wires and hoses
- Missing parts or attaching points on the frame

** If the baseplate is improperly installed and is against a wire or hose, it could cause fluid leaks or electrical shorts some time after the actual baseplate installation.

Permanent Baseplate Safety Cable Installation

Permanent baseplate safety cables are strongly recommended when towing a vehicle with a tow bar. The principle function of the permanent baseplate safety cables is to prevent the towed vehicle from breaking loose in the event the connection between the frame of the towed vehicle and the baseplate fails or becomes disconnected. The cables must be connected from the baseplate to the frame rail or cross member of the vehicle's frame. The illustrations below show the possible arrangements recommended by Blue Ox®. Each permanent baseplate safety cable must have an adequate weight rating for the towing system. The weight rating of the two (2) cables together will not qualify.

Do not mount the permanent baseplate safety cables against wires, hoses or brake lines.

These permanent baseplate safety cables should remain installed as long as the baseplate is installed on the vehicle. Permanent baseplate safety cables are to be used in conjunction with, and NOT a replacement for legally required safety cables attaching the towed vehicle to the towing vehicle.

OPTION #1

Permanent Baseplate Safety Cables to Cross Member or Frame of Towed Vehicle.



OPTION #2

Permanent Baseplate Safety Cables to Cross Member or Frame of Towed Vehicle.

