



Strong As An Ox™

BX2148 Installation Instructions 1998-2003 Ford Windstar

The fascia, headlights and front bracket need to be removed. Half inch holes need to be drilled. Slight trimming may be necessary to install the baseplate.

1. Open the hood and remove the five push rivets from the top of the plastic fascia. Looking down on the headlights, notice two black metal pieces with holes in them that hold each light assembly. These pieces are located on the back side of the light on each end. Pull the pieces out to release the headlights. Once the lights have been pulled out disconnect the wiring and set aside.
2. Remove the three phillips screws directly in front of the front tires, both sides. Also remove the three screws on the outside bottom of the fascia. On the front, bottom of the plastic fascia are five Phillips head screws behind the rivets which need to be removed.
3. Pull the plastic fender well molding back that is in front of the tires. Remove the two Hex nuts (11MM) that hold each side of the fascia to the fenders.
4. The fascia can now be removed. Notice the plastic from the bumper fascia that extends underneath the frame is exposed after the head lights are removed. Be sure when replacing the fascia that it slides underneath that frame piece.
5. The foam piece that extends across the front of metal bumper needs to be removed next. Remove the two outside nuts, one 11MM and one 8MM, and the two inside bolts on each side of the radiator (Some models may have rivets). Pull foam piece off and set aside. This piece was taken off so the two bolt plates can be placed in the metal bumper.

While the location and size of the holes in the baseplate were designed to allow for easy installation, it may be necessary to file a hole slightly.

6. Hold the baseplate up to the metal bumper, positioning the outside bent plates over the existing holes on the side of each frame (just behind the ripples). Hold the baseplate up so the middle braces are against the bottom of the metal bumper. Apply loctite and tighten the outside bolts according to the Torque Chart in the General Instruction Sheet.
7. Now drill the middle braces of the baseplate. Use the hardware provided (Items 2, 6, and 8) as shown in drawing on page 2. Use Loctite on each bolt and tighten. NOTE: On some models there will be a space between the middle braces and the bottom of the bumper. Use the 1/2" flat washers as spacers for this situation.
8. Reinstall foam to metal bumper with plastic rivets. Hold the fascia up to its original location and mark areas that need to be trimmed. Use the Pine Tree Clips (Item 10) in place of the plastic pins removed in Step 1 and reinstall fascia.

9. Install the tow bar and safety cables according to the instructions included in their packages. Do not substitute other devices if the tow bar pin and clip are lost.
10. **DEALER OR INSTALLER: BE CERTAIN THE USER RECEIVES THE INSTRUCTION SHEET.**

Tools Required

11MM Socket
17/32" Drill Bit
Loctite

Utility Knife
Drill
Plastic Rivet Gun

3/4" Socket
18MM Socket
Phillips Screwdriver (Short)

Parts List

Ref. No.	Qty.	Part No.	Description
1	1	61-5382	Baseplate, BX2148
2	2	61-5267	1/2" Bolt Plate with Wire, Large
3	2	61-5383	3/8" Bolt Plate with Wire, Small
4	2	61-5208	3/8" Nut Plate with Wire, Small
5	2	201-0368	3/8"-16 x 1 1/4 Hex Bolt. Grade 8
6	2	202-0005	1/2"-13 Hex Nut
7	2	202-0003	3/8"-16 Hex Nut
8	2	203-0012	1/2 Lock Washer
9	2	203-0010	3/8" Lock Washer
10	8	290-0331	Pine tree clips (Not Shown)
11	8	203-0005	1/2 Flat, Washer, ZP (if needed)
12	4	229-0536	6.3MM Plastic Rivet (Not Shown)
	2	226-0046	Baseplate Safety Cable, 36" CL III (Not Shown)
	4	229-0359	Quicklink, 3/8, ZP (Not Shown)

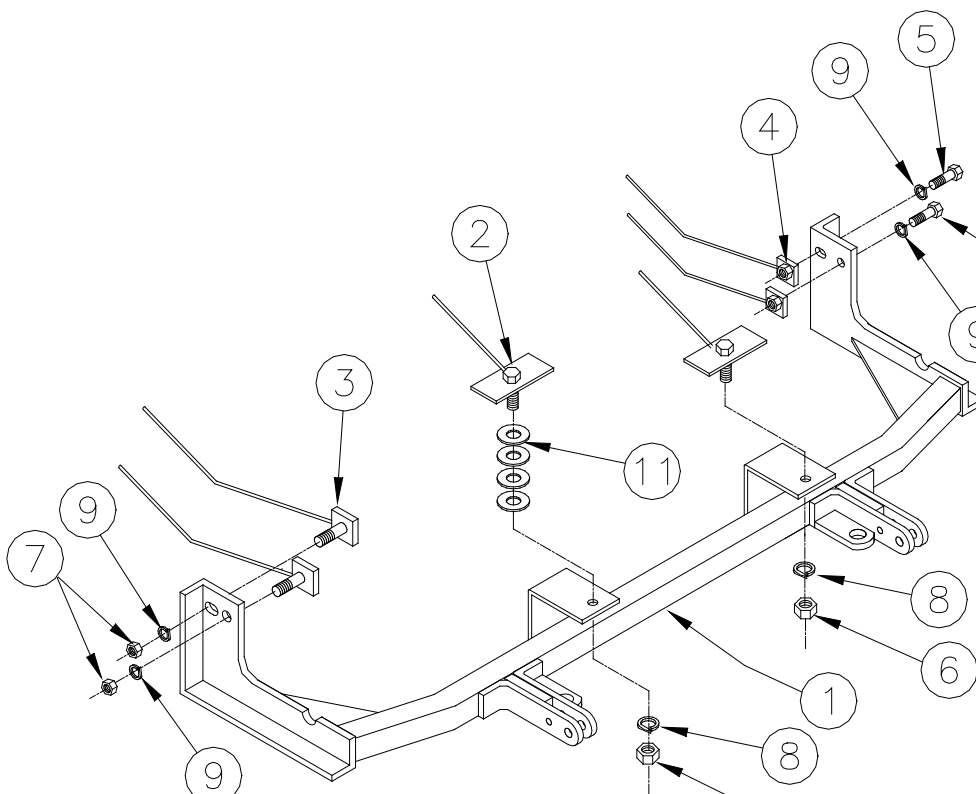

Location for the BX8869 on the driver's side.

General Information

1. Ensure that your product(s) are registered online at www.blueox.com. It is crucial to register your product(s) so that you may be alerted of product offerings, updates, upgrades, maintenance and safety bulletins, and/or recalls.
2. **It is the owner's responsibility to inspect all towing equipment for cracked welds, missing or worn parts and loose bolts before each towing trip.** Be sure to use Loctite® Red on all bolts and tighten to the recommended specifications.
3. **It is the owner's responsibility to hook up all towing equipment per manufacturer's instructions/recommendations.**
4. Remove the attachment tabs when not in use (if applicable).

Notice To Baseplate Installer

1. It is YOUR responsibility to watch for:

- Oil cooler and air conditioner lines
- Electrical wires and hoses
- Missing parts or attaching points on the frame

** If the baseplate is improperly installed and is against a wire or hose, it could cause fluid leaks or electrical shorts some time after the actual baseplate installation.

Permanent Baseplate Safety Cable Installation

Permanent baseplate safety cables are strongly recommended when towing a vehicle with a tow bar. The principle function of the permanent baseplate safety cables is to prevent the towed vehicle from breaking loose in the event the connection between the frame of the towed vehicle and the baseplate fails or becomes disconnected. The cables must be connected from the baseplate to the frame rail or cross member of the vehicle's frame. The illustrations below show the possible arrangements recommended by Blue Ox®. Each permanent baseplate safety cable must have an adequate weight rating for the towing system. The weight rating of the two (2) cables together will not qualify.

Do not mount the permanent baseplate safety cables against wires, hoses or brake lines.

These permanent baseplate safety cables should remain installed as long as the baseplate is installed on the vehicle. Permanent baseplate safety cables are to be used in conjunction with, and NOT a replacement for legally required safety cables attaching the towed vehicle to the towing vehicle.

OPTION #1

Permanent Baseplate Safety Cables to Cross Member or Frame of Towed Vehicle.

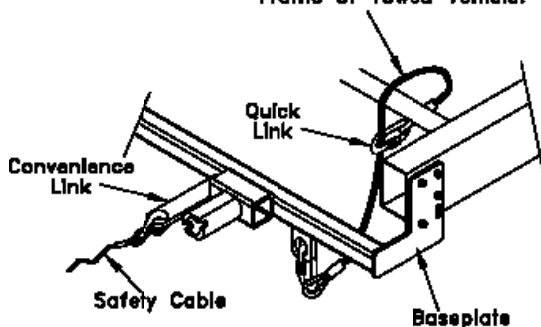

OPTION #2

Permanent Baseplate Safety Cables to Cross Member or Frame of Towed Vehicle.

