



BX1940 Installation Instructions 2000-02 Plymouth Neon 2000-02 Dodge Neon

Serial No.

The baseplate mounts to the metal bumper and to the lower cross frame of the vehicle. Drilling is required. The attachment tabs are 24 inches center to center and a height of 19 inches.

1. Remove the three 10MM nuts holding the plastic fascia to the fender moldings.
2. Remove the center piece (with logo) by removing the four 7MM Hex head bolts holding the piece.
3. Remove the two 10MM Hex head screws from behind the fascia area where the center grill was removed. Remove the two (each side) Torx 25 bolts from in front of the tire.
4. Remove the five 8MM Hex head screws from the bottom of the plastic fascia.
5. The bottom of the rock guard has two 1/2" holes, use a long extension and remove the 10MM Hex head bolts holding the bumper. **Some models may have two metric bolts to remove from tabs on the bottom of metal bumper.** Pull fascia forward from car and set aside.
6. Hold baseplate up to the lower cross frame "channel" and the bottom of the metal bumper. Refer to the picture. Center the baseplate according to the metal bumper. Double check measurements and clamp in place with vise grips.
7. Mark and drill the two holes for the bottom of the metal bumper with the 17/32" drill bit. After the holes are drilled, place the 1/2" bolt plates (item 2) through the back of the bumper and loosely bolt baseplate to the bumper using 1/2" hardware. **2002 Models** will use items 3, 4, and 5 according to drawing on last page. **Be sure and use loctite on all bolts before tightening. Tighten all bolts according to General Instruction sheet.**
8. Hold the lower braces to the bottom of the cross frame "channel", mark and drill through both sides. Place the tube spacer between the channel and bolt (3/8 x 4 Hex Bolt) pieces together using the 3/8" lock washer and hex nut. **Be sure and use loctite on all bolts before tightening. Tighten all bolts according to General Instruction sheet.**
9. Replace the bumper fascia.
10. Install the tow bar and safety cables according to the instructions included in their packages. Do not substitute other devices if the tow bar pin and clip are lost.
11. The dimensional variations between otherwise identical cars can be considerable. While the location and size of the holes in the baseplate were designed to allow for easy installation, it may be necessary to file a hole slightly to allow a bolt to clear.
12. **DEALER OR INSTALLER: BE CERTAIN THE USER RECEIVES THE INSTRUCTION SHEET.**





Strong As An Ox™

Tools Required

7MM Socket
18MM Socket
17/32" Drill Bit
3/4" Socket

8MM Socket
Loctite
Hack Saw
Utility Knife

10MM Socket
13/32" Drill Bit
9/16" Socket
Torx-25

Parts List

Ref. No.	Qty.	Part No.	Description
1	1	61-5339	Weldment, Base Plate, BX1940
2	2	61-5340	1/2-13 x 1 1/4 Bolt Plate
3	2	61-5788	1/2-13 Nut Plate with 18" Wire
4	2	203-0012	1/2 Lock Washer, ZP
5	2	201-0051	1/2-13 x 1 1/2 Hex Bolt, Grd. 5, ZP
6	2	201-0618	3/8-16 x 4 Hex Bolt, Grd. 5, ZP
7	2	203-0010	3/8 Lock Washer, ZP
8	2	202-0003	3/8-16 Hex Nut, ZP
9	2	202-0005	1/2-13 Hex Nut, ZP
10	2	104-0546	Spacer, BX1940
11	2	201-0979	#12-14 x 1" Self Drilling Screw, ZP
12	2	101-5822	Adapter, 4 Way Connector
13	2	202-0047	#10-32 Hex Nut, ZP
14	2	203-0054	#10 Lock Washer
15	2	201-0192	#10-32 x 1/2 Slot, Rd. Hd. Screw

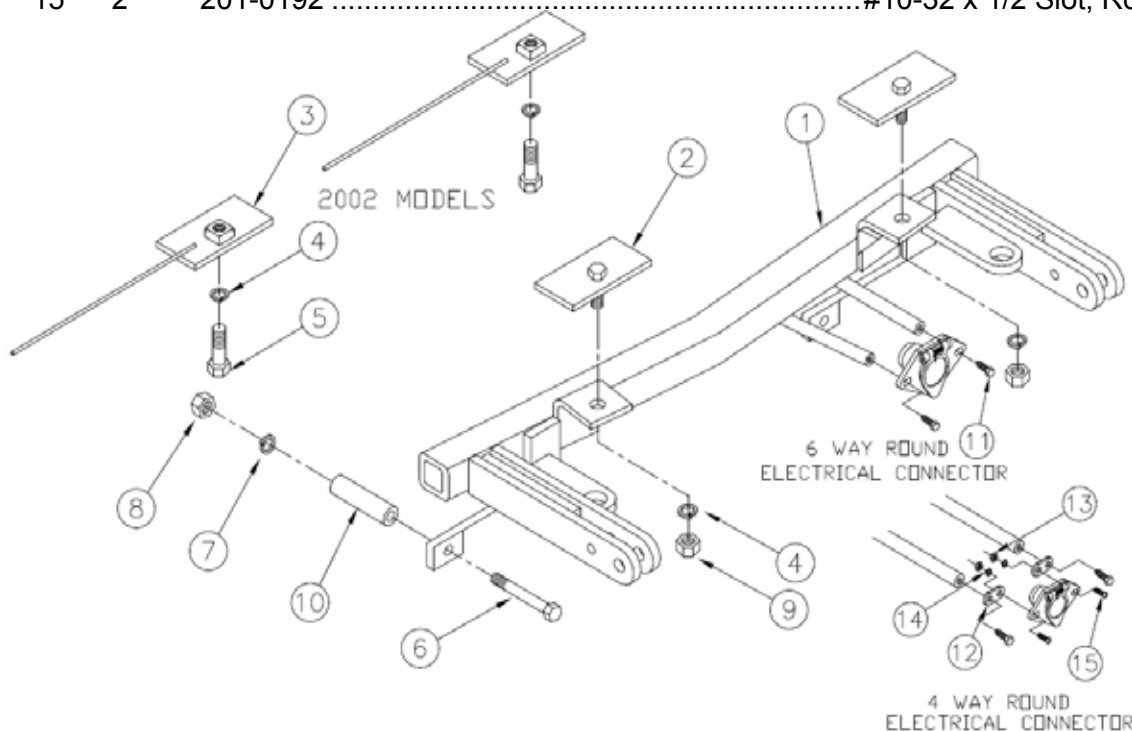

IMPORTANT: Use only genuine factory replacement parts on your Base Plate. Do not substitute homemade or nontypical parts. If a bolt is lost or in need of replacement, for your safety and the preservation of your Base Plate, be sure to use a replacement bolt of the same grade (Usually Grade 5, refer to parts list). Repair parts may be ordered through your nearest **Blue Ox** dealer or distributor.

General Information

1. Ensure that your product(s) are registered online at www.blueox.com. It is crucial to register your product(s) so that you may be alerted of product offerings, updates, upgrades, maintenance and safety bulletins, and/or recalls.
2. **It is the owner's responsibility to inspect all towing equipment for cracked welds, missing or worn parts and loose bolts before each towing trip.** Be sure to use Loctite® Red on all bolts and tighten to the recommended specifications.
3. **It is the owner's responsibility to hook up all towing equipment per manufacturer's instructions/recommendations.**
4. Remove the attachment tabs when not in use (if applicable).

Notice To Baseplate Installer

1. It is YOUR responsibility to watch for:

- Oil cooler and air conditioner lines
- Electrical wires and hoses
- Missing parts or attaching points on the frame

** If the baseplate is improperly installed and is against a wire or hose, it could cause fluid leaks or electrical shorts some time after the actual baseplate installation.

Permanent Baseplate Safety Cable Installation

Permanent baseplate safety cables are strongly recommended when towing a vehicle with a tow bar. The principle function of the permanent baseplate safety cables is to prevent the towed vehicle from breaking loose in the event the connection between the frame of the towed vehicle and the baseplate fails or becomes disconnected. The cables must be connected from the baseplate to the frame rail or cross member of the vehicle's frame. The illustrations below show the possible arrangements recommended by Blue Ox®. Each permanent baseplate safety cable must have an adequate weight rating for the towing system. The weight rating of the two (2) cables together will not qualify.

Do not mount the permanent baseplate safety cables against wires, hoses or brake lines.

These permanent baseplate safety cables should remain installed as long as the baseplate is installed on the vehicle. Permanent baseplate safety cables are to be used in conjunction with, and NOT a replacement for legally required safety cables attaching the towed vehicle to the towing vehicle.

OPTION #1

Permanent Baseplate Safety Cables to Cross Member or Frame of Towed Vehicle.



OPTION #2

Permanent Baseplate Safety Cables to Cross Member or Frame of Towed Vehicle.

