



**BX1615 Installation Instructions**  
**1994-97 Chevrolet S-10 2WD Pickup**  
**1995-96 Chevrolet S-10 Blazer 2WD**  
**1994-97 GMC Sonoma 2WD Pickup**  
**1995-96 GMC S-15 Jimmy 2WD**  
**1995-98 Isuzu Hombre 2WD**

Installation of this baseplate requires cutting openings in the plastic bumper to allow for attachment tab clearance. Two holes will also need to be drilled in the frame.

1. Read the General Instruction Sheet included with this baseplate.
2. The baseplate mounts to the inside and bottom of the frame just behind the bumper. The tow bar attachment tabs protrude through the plastic bumper approximately even with the bottom of the license plate bracket. Access openings will have to be cut in the bumper plastic and two holes will have to be drilled in the frame.
3. Two rectangular openings will need to be cut in the plastic lower section of the bumper. The rectangles should be 1 1/2" wide and 1 3/4" tall. The bottom of the rectangle should be 2 1/4" above the bottom edge of the plastic and centered 12" either side of the center of the bumper.
4. Use one of the 1/2" bolts and one of the 7/16" bolts to check nuts to make sure they start easily. If necessary, use a tap to clean the threads.
5. On the bottom of the frame, just ahead of the sway bar mount is 9/16" diameter hole. Note the location of this hole as the rear most hole on the baseplate will use this hole. Note also that there is a large slot on the outside of the frame near this hole. The slot will allow access for the nut wire for that bolt. On the inside of the frame there is a 1/2" hole near a triangular hole in the frame. This hole corresponds to the slot on the vertical mount of the baseplate. Access for the nut plate is through a slot in the frame near the hole. The third hole on each side is drilled in the bottom of the frame. Access for the nut wire is through the open front of the frame tube.
6. Bend a nut wire and position it so you can start a bolt through the 9/16" hole in the frame. Do this for both sides. With an assistant, hold the baseplate up and start the tow bar attachment tabs through the holes in the bumper plastic. Slide the tabs through and align the rear holes in the baseplate with 9/16" holes in the frame. Apply Loctite and start a 1/2" bolt and lock washer in each side to hold the baseplate in position. The rectangles in the plastic may need to be enlarged at this time to get the baseplate into proper position.
7. Slide a 7/16" nut plate into the frame and start the two 7/16" bolts and lock washers. Apply Loctite. When the bolts are all started, tighten the four bolts installed in the last two steps.
8. Using the baseplate as a guide, drill a 17/32" hole through the bottom of the frame and use the last two 1/2" bolts, lock washers, and nut wires to finish the installation. Don't forget to use Loctite.
9. The dimensional variations between otherwise identical cars can be considerable. While the location and size of the holes in the base plate were designed to allow for easy installation, it may be necessary to file a hole slightly to allow a bolt to clear.
10. Install the tow bar and safety cables according to the instructions included in their packages.

**Automatic**

Page 1 of 2 292-1553 Rev. B 1/3/11

11. Do not substitute other devices if the tow bar pin and clip are lost.

12. **DEALER OR INSTALLER:** BE CERTAIN THE USER RECEIVES THE INSTRUCTION SHEET.

**IMPORTANT:** Since the tow bar attachment tabs are higher than normal for a Blue Ox baseplate on this particular installation, the recommended ball height for towing this vehicle is 20" instead of the normally recommended 18".

### Tools Required

Utility Knife	3/4" Socket	5/8" Socket
Tape Measure	Drill	17/32" Drill Bit
Loctite Blue		

### Parts List

Ref. No.	Qty.	Part No.	Description
1	1	61-4242	Weldment, Baseplate, BX1615
2	2	61-4243	Weldment, 7/16" Nut Plate
3	4	61-4029	Weldment, 1/2" Nut Wire
4	4	201-0051	1/2-13 x 1 1/2 Hex Bolt, Grd. 5
5	2	201-0451	7/16-14 x 1 1/4 Hex Bolt, Grd 5
6	2	203-0011	7/16 Lock Washer
7	4	203-0012	1/2 Lock Washer
	2	226-0046	Baseplate Safety Cable, 36" CL III (Not Shown)
	4	229-0359	Quicklink, 3/8, ZP (Not Shown)

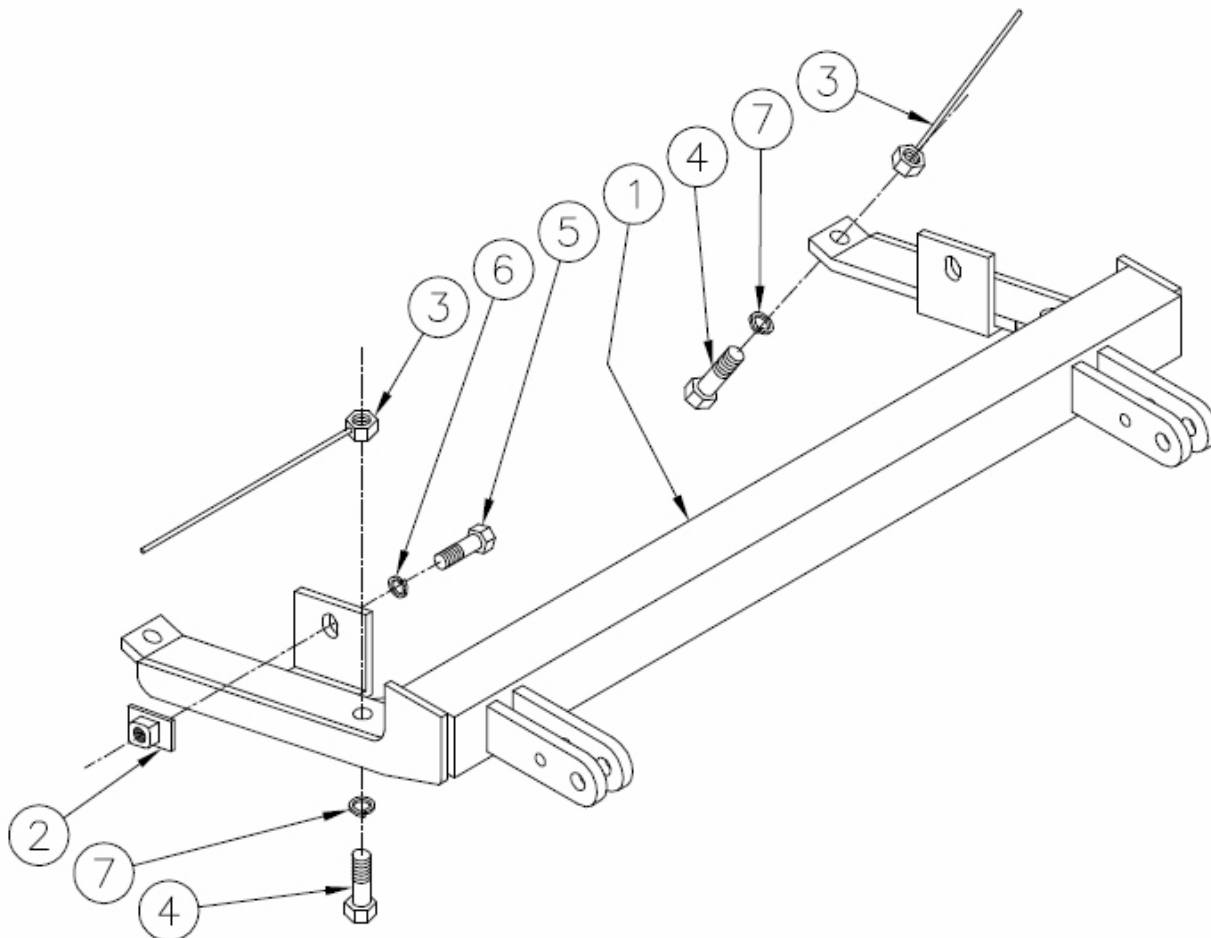

# General Information

1. Ensure that your product(s) are registered online at [www.blueox.com](http://www.blueox.com). It is crucial to register your product(s) so that you may be alerted of product offerings, updates, upgrades, maintenance and safety bulletins, and/or recalls.
2. **It is the owner's responsibility to inspect all towing equipment for cracked welds, missing or worn parts and loose bolts before each towing trip.** Be sure to use Loctite® Red on all bolts and tighten to the recommended specifications.
3. **It is the owner's responsibility to hook up all towing equipment per manufacturer's instructions/recommendations.**
4. Remove the attachment tabs when not in use (if applicable).

## Notice To Baseplate Installer

### 1. It is YOUR responsibility to watch for:

- Oil cooler and air conditioner lines
- Electrical wires and hoses
- Missing parts or attaching points on the frame

\*\* If the baseplate is improperly installed and is against a wire or hose, it could cause fluid leaks or electrical shorts some time after the actual baseplate installation.

## Permanent Baseplate Safety Cable Installation

Permanent baseplate safety cables are strongly recommended when towing a vehicle with a tow bar. The principle function of the permanent baseplate safety cables is to prevent the towed vehicle from breaking loose in the event the connection between the frame of the towed vehicle and the baseplate fails or becomes disconnected. The cables must be connected from the baseplate to the frame rail or cross member of the vehicle's frame. The illustrations below show the possible arrangements recommended by Blue Ox®. Each permanent baseplate safety cable must have an adequate weight rating for the towing system. The weight rating of the two (2) cables together will not qualify.

***Do not mount the permanent baseplate safety cables against wires, hoses or brake lines.***

These permanent baseplate safety cables should remain installed as long as the baseplate is installed on the vehicle. Permanent baseplate safety cables are to be used in conjunction with, and NOT a replacement for legally required safety cables attaching the towed vehicle to the towing vehicle.

### OPTION #1

Permanent Baseplate Safety Cables to Cross Member or Frame of Towed Vehicle.



### OPTION #2

Permanent Baseplate Safety Cables to Cross Member or Frame of Towed Vehicle.

