



Strong As An Ox™

BX1122 Installation Instructions 2005-07 Jeep Liberty

Serial No.

The upper grill and front fascia are removed for baseplate installation. Drilling is required. The BX8869 is available for the vehicle. Attachment Tabs are 20 inches center to center and a height of 19 inches.



1. Using the 20 torx socket, remove the two metric bolts from the top edge of grill. **NOTE: Some models may not have the torx metric bolts on the top edge of grill.**



2. Lift tab just above headlight assembly and pull that portion of the grill forward to release tab, both sides.



3. Lift the two tabs on the top edge of grill between headlights and pull grill center forward to release tabs.



4. Pull the top of grill forward and up, set grill aside. Remove the metric bolt just below the headlight assembly with the 10MM socket, both sides.



5. Remove the two christmas tree push pins just forward of the front tire, on wheel well, bolt sides. **Note: Some 2005 models may have rivets in place of the christmas tree. Remove with side cutters.**



6. Remove christmas tree push pin from lower edge of wheel well just forward of front tire, both sides (view of passenger's side).



Strong As An Ox™

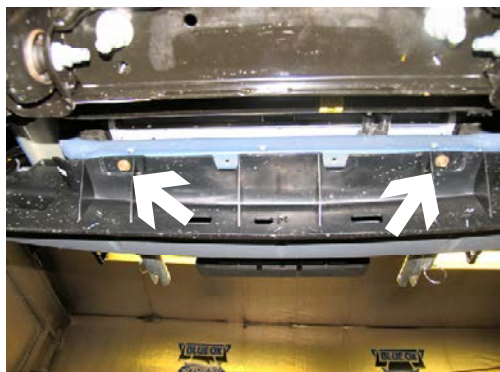

7. Using the 10MM socket, remove the two metric bolts from the bottom edge of fascia just below radiator support.



8. Release tab on the inside of wheel well and pull fascia corner to the side, both sides.



9. Push the two tabs down with the flat screw driver, pull fascia forward, unplug electrical connections, if applicable and set aside.



10. Remove the metric bolt from hub with the 10MM socket and set hub aside, both sides.



11. Align baseplate with the two existing holes in the bottom of frame, insert backing plate and nut plates into opening on the end of frame rail to align with these existing holes, both sides. Some vehicles may need to have these existing holes reamed to acquire proper fit. Tighten the 3/8" hex bolts, flat and lock washers with the 9/16" socket, both sides. **Be sure and use Loctite Red on all bolts before tightening. Tighten all bolts according to Torque Chart in the General Instruction Sheet. Note: Some models may have tow hooks that will need to be removed and will not be reinstalled.**





Strong As An Ox™



12. Using the baseplate as a template, drill a hole into the frame with the 13/32" drill bit, both sides. Insert nut plate into opening on the back side of frame support to align with drilled hole, tighten the 3/8" hex bolt and lock washer with the 9/16" socket, both sides. **Be sure to use Loctite Red on all bolts before tightening. Tighten all bolts according to Torque Chart in General Instruction Sheet.**



13. Reinstall hubs on the front of metal bumper with the existing bolts and 10MM socket.

14. Reinstall fascia and grill. Replace the plastic rivets provided that were remove in step 5. **Be sure that all electrical components are plugged in properly.**

15. The dimensional variations between otherwise identical cars can be considerable. While the location and size of the holes in the baseplate were designed to allow for easy installation, it may be necessary to file a hole slightly to allow a bolt to clear.

16. Install the tow bar and safety cables according to the instructions included in their packages.

17. Do not substitute other devices if the tow bar pin and clip are lost.

18. DEALER OR INSTALLER: BE CERTAIN THE USER RECEIVES THE INSTRUCTION SHEET.





Tools Required

10MM Socket
Flat Screw Driver

9/16" Socket
Loctite Red

20 Torx Socket
Diagonal Cutters

Parts List

Ref. No.	Qty.	Part No.	Description
1	6	61-5208	3/8-16 Nut Plate, with 14" Wire
2	1	61-6075	Weldment, Base Plate, BX1122
3	2	62-3468	Attachment, Assembly, SF/ SB (R)
4	2	102-6572	Backing Plate, BX1122
5	2	201-0192	#10-32 x 1/2 Slot, Rd. Hd. Screw
6	2	201-0440	3/8-16 x 1 1/2 Hex Bolt, Grd. 5, ZP
7	4	201-0444	3/8-16 x 2 Hex Bolt, Grd. 5, ZP
8	2	201-0979	1#12-14 x 1" Self Drilling Screw, ZP
9	2	202-0047	#10-32 Hex Nut
10	4	203-0003	3/8" Flat Washer, ZP
11	6	203-0010	3/8" Lock Washer, ZP
12	2	203-0054	#10 Lock Washer
13	1	299-0685	Electrical Bracket, ZP
	2	226-0046	Baseplate Safety Cable, 36" CL III (Not Shown)
	4	229-0359	Quicklink, 3/8, ZP (Not Shown)
	6	229-0536	6.3MM Plastic Rivet (Not Shown)
	2	290-0437	Receiver, Cap Plug (BLK) (Not Shown)

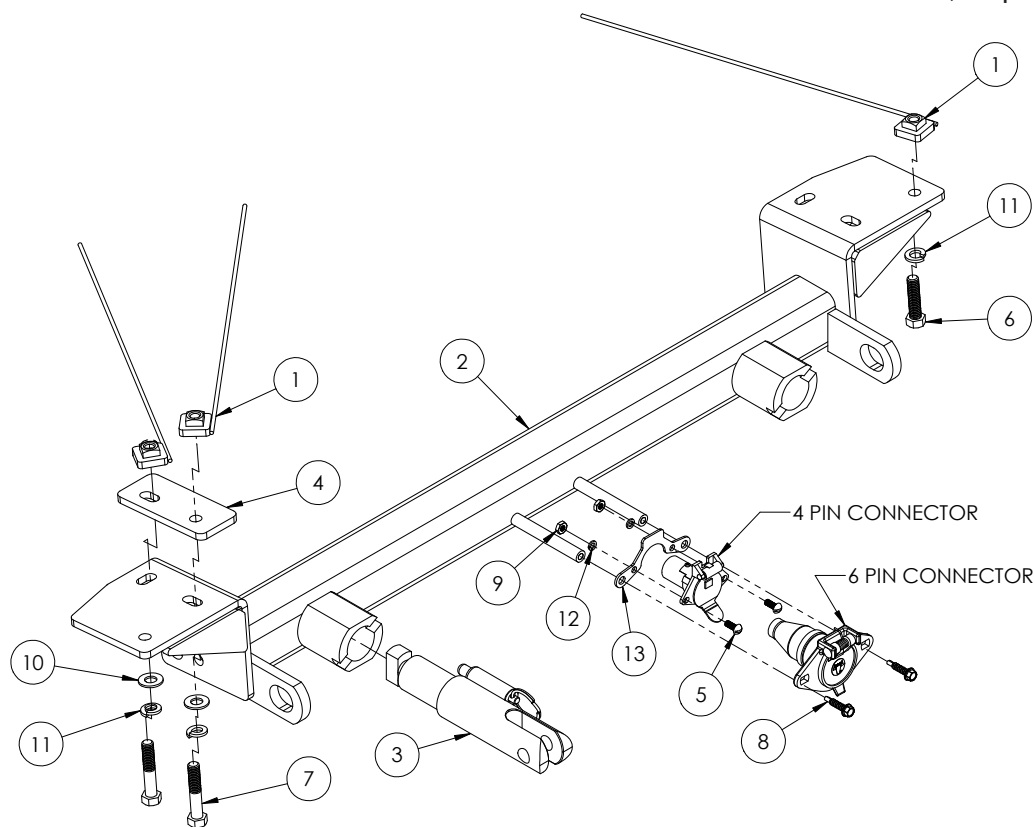

*Location for the
BX8869 on driver's side
tail light assembly.*

IMPORTANT: Use only genuine factory replacement parts on your Base Plate. Do not substitute homemade or nontypical parts. If a bolt is lost or in need of replacement, for your safety and the preservation of your Base Plate, be sure to use a replacement bolt of the same grade (Usually Grade 5, refer to parts list). Repair parts may be ordered through your nearest **Blue Ox** dealer or distributor.

General Information

1. Ensure that your product(s) are registered online at www.blueox.com. It is crucial to register your product(s) so that you may be alerted of product offerings, updates, upgrades, maintenance and safety bulletins, and/or recalls.
2. **It is the owner's responsibility to inspect all towing equipment for cracked welds, missing or worn parts and loose bolts before each towing trip.** Be sure to use Loctite® Red on all bolts and tighten to the recommended specifications.
3. **It is the owner's responsibility to hook up all towing equipment per manufacturer's instructions/ recommendations.**
4. Remove the attachment tabs when not in use (if applicable).

Notice To Baseplate Installer

1. **It is YOUR responsibility to watch for:**

- Oil cooler and air conditioner lines
- Electrical wires and hoses
- Missing parts or attaching points on the frame

**** If the baseplate is improperly installed and is against a wire or hose, it could cause fluid leaks or electrical shorts some time after the actual baseplate installation.**

Permanent Baseplate Safety Cable Installation

Permanent baseplate safety cables are strongly recommended when towing a vehicle with a tow bar. The principle function of the permanent baseplate safety cables is to prevent the towed vehicle from breaking loose in the event the connection between the frame of the towed vehicle and the baseplate fails or becomes disconnected. The cables must be connected from the baseplate to the frame rail or cross member of the vehicle's frame. The illustrations below show the possible arrangements recommended by Blue Ox®. Each permanent baseplate safety cable must have an adequate weight rating for the towing system. The weight rating of the two (2) cables together will not qualify.

Do not mount the permanent baseplate safety cables against wires, hoses or brake lines.

These permanent baseplate safety cables should remain installed as long as the baseplate is installed on the vehicle. Permanent baseplate safety cables are to be used in conjunction with, and NOT a replacement for legally required safety cables attaching the towed vehicle to the towing vehicle.

Option #1

(Baseplates with Convenience Link Tabs)

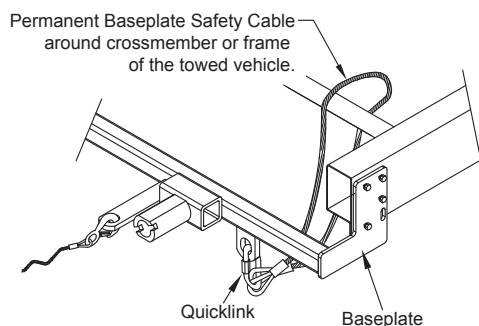

Option #2

(Baseplates with out Convenience Link Tabs)

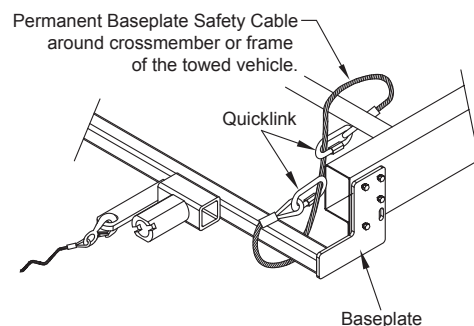

BLUE OX ORIGINAL PURCHASERS THREE YEAR LIMITED WARRANTY

Automatic Equipment Manufacturing Company ("Automatic") warrants to the original (first) retail purchaser that this product, manufactured by Automatic, shall be free from defect in material and workmanship under normal use and service for a period of three years from the date of delivery.

During said three-year period, Automatic will repair or replace any parts that have been returned by the original purchaser, to the factory, transportation prepaid, and in Automatic's sole and absolute opinion found to be defective.

Limitations on Warranty Coverage:

Coverage under this warranty will be valid only if the customer warranty card is returned by the original purchaser within 30 days of purchase.

Coverage under this warranty will be effective only when a copy of the original invoice, showing date and place of purchase, accompanies any claim for warranty. This warranty is NON TRANSFERABLE.

This limited warranty will not cover, in any way or form, any alleged damages caused by incorrect or improper installation, improper use, modification or neglect of product, failure to properly service and maintain, misuse, act of God, accident or failure of the user to follow guidelines contained in the instructional material provided by Automatic.

This warranty does not cover normal wear and tear, paint or rust.

Warrantor assumes no responsibility to the owner for loss of use of product, loss of time, inconvenience or any other damage consequential or otherwise. Including, but not limited to mileage, expense of transporting of product, return shipping expense, mechanics travel time, telephone, road service, towing, and rental during repairs, travel, lodging, loss or damage to personal property or loss of earnings.

REPAIR OR REPLACEMENT AS SET FORTH IN THIS LIMITED WARRANTY IS THE SOLE EXCLUSIVE REMEDY OF THE PURCHASER. AUTOMATIC SHALL NOT BE LIABLE FOR ANY INCIDENTAL OR CONSEQUENTIAL DAMAGES FOR BREACH OF ANY EXPRESS OR IMPLIED WARRANTY ON THIS PRODUCT. EXCEPT TO THE EXTENT PROHIBITED BY APPLICABLE LAW, ANY IMPLIED WARRANTY OF MERCHANTABILITY OR FITNESS FOR A PARTICULAR PURPOSE ON THIS PRODUCT IS LIMITED IN LENGTH TO THE DURATION OF THIS WARRANTY.

Please visit <http://blueox.com/warranty/> to register your warranty

