



Installation Instructions BX1006 Acura TL 1999-2001 (R)

Serial No.

The plastic fascia and metal bumper need to be removed for installation of the baseplate. The inner grill molding needs to be trimmed. All holes need to be drilled.

1. Open the hood and remove the top push pins which are between the headlights.
2. Remove the hex head screws which are directly in front of the front tires fastening the ends of the bumper fascia into each fender.
3. Remove the hex bolts and plastic push pins on the bottom of the bumper fascia. Now remove the bumper fascia from the vehicle
4. The metal bumper can be removed next. Remove the hex head bolt at the center of the bumper. On each end of the bumper are three bolts (two on the top and one on the bottom) which need to be removed also. Pull the bumper from the car.
5. Place the baseplate on a flat surface and set the metal bumper on the baseplate so the back of the bumper is positioned against the front of the braces on the receiver tube. Clamp the two pieces together so they are centered. Mark and drill the four holes for the braces. Use the 3/8" bolts and lock washers with the 3/8" wire nut plates to fasten the two pieces together. Insert the wire nut plates through each side of the bumper. Apply Loctite to each bolt but do not tighten.
6. The inner plastic surrounding the radiator needs to be trimmed before the bumper and baseplate can be placed back onto the car. Hold the bumper and baseplate up to its original position and mark the area which needs to be trimmed.
7. Bolt the bumper back onto the car positioning the side plates (of the baseplate) on the outside of the cars frame. Once the metal bumper is replaced and the baseplate is correctly positioned, torque bolts according to the chart in the General Instruction Sheet.
8. The three holes for each side of the baseplate need to be drilled next. The bottom hole in the front on each side will not be used. Use 3/8" hardware for each bolt as shown in the drawing on page 2. The 3/8" wire nut for the top back hole can be inserted in the open area on the bottom of the frame. Once all bolts and nuts have been started, tighten and torque accordingly.
9. Replace the fascia to the vehicle.
10. Install the tow bar and safety cables according to the instructions included in their packages.
11. DEALER OR INSTALLER: BE CERTAIN THE USER RECEIVES THE INSTRUCTION SHEET.



Automatic

Tools Required

8MM Wrench
9/16" Wrench
3/8" Drill Bit

10MM Wrench
9/16" Socket
Center Punch

12MM Wrench
Phillips Screw Driver
Utility Knife

Parts List

Ref. No.	Qty.	Part No.	Description
1	1	61-5470	Weldment, Baseplate BX1006
2	2	61-5208	3/8" Wire Nut Plate
3	6	61-4978	3/8" Wire Nut
4	10	201-0368	3/8"-16 x 1 1/4" Hex Bolt, Grade 5
5	10	203-0010	3/8" Lock Washer
6	4	203-0003	3/8" Flat Washer
7	2	202-0003	3/8" Hex Nut, ZP
8	2	201-0979	#12-14 x 1" Self Drilling Screw, ZP
9	2	202-0047	#10-32 Hex Nut
10	2	203-0054	#10 Lock Washer
11	2	201-0192	#10-32 x 1/2" Slot, Round Head Screw
12	2	101-5822	Adapter, 4 Way Connector
13	2	62-3470	Att Tab Assy, Rem, LF/LB, 1 Hole (Not Shown)
	2	226-0046	Baseplate Safety Cable, 36" CL III (Not Shown)
	2	229-0359	Quicklink, 3/8, ZP (Not Shown)
	2	290-0437	Receiver, Cap Plug (BLK) (Not Shown)

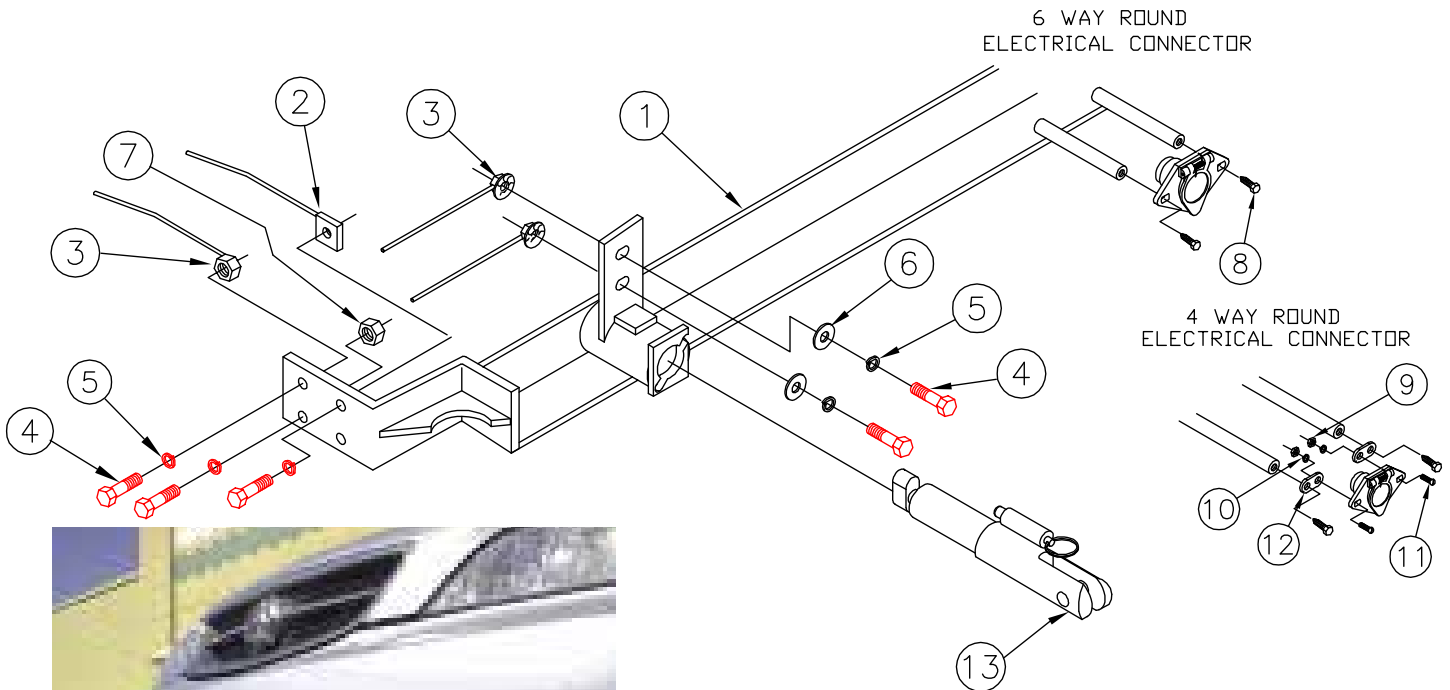

BOLTS, WASHERS, NUTS AND NUT PLATES ARE SHOWN ON PASSENGER SIDE ONLY. THE BOLT BAG PROVIDES HARDWARE FOR BOTH SIDES.

General Information

1. Ensure that your product(s) are registered online at www.blueox.com. It is crucial to register your product(s) so that you may be alerted of product offerings, updates, upgrades, maintenance and safety bulletins, and/or recalls.
2. **It is the owner's responsibility to inspect all towing equipment for cracked welds, missing or worn parts and loose bolts before each towing trip.** Be sure to use Loctite® Red on all bolts and tighten to the recommended specifications.
3. **It is the owner's responsibility to hook up all towing equipment per manufacturer's instructions/recommendations.**
4. Remove the attachment tabs when not in use (if applicable).

Notice To Baseplate Installer

1. It is YOUR responsibility to watch for:

- Oil cooler and air conditioner lines
- Electrical wires and hoses
- Missing parts or attaching points on the frame

** If the baseplate is improperly installed and is against a wire or hose, it could cause fluid leaks or electrical shorts some time after the actual baseplate installation.

Permanent Baseplate Safety Cable Installation

Permanent baseplate safety cables are strongly recommended when towing a vehicle with a tow bar. The principle function of the permanent baseplate safety cables is to prevent the towed vehicle from breaking loose in the event the connection between the frame of the towed vehicle and the baseplate fails or becomes disconnected. The cables must be connected from the baseplate to the frame rail or cross member of the vehicle's frame. The illustrations below show the possible arrangements recommended by Blue Ox®. Each permanent baseplate safety cable must have an adequate weight rating for the towing system. The weight rating of the two (2) cables together will not qualify.

Do not mount the permanent baseplate safety cables against wires, hoses or brake lines.

These permanent baseplate safety cables should remain installed as long as the baseplate is installed on the vehicle. Permanent baseplate safety cables are to be used in conjunction with, and NOT a replacement for legally required safety cables attaching the towed vehicle to the towing vehicle.

OPTION #1

Permanent Baseplate Safety Cables to Cross Member or Frame of Towed Vehicle.



OPTION #2

Permanent Baseplate Safety Cables to Cross Member or Frame of Towed Vehicle.

