

BLUE OX[®]

Baseplates

BX1005

1997-99 Acura CL

Installation Instructions

Serial Number

Please read BOTH these Installation Instructions and the General Instructions before attempting to install or operate this equipment.

- Blue Ox[®] towing products and accessories are intended to be installed by Blue Ox[®]. Dealers who are familiar with our products and have the equipment necessary and knowledge to do "fit work". When necessary Blue Ox[®] Dealers can be found at www.blueox.us or by contacting our 24/7 Customer Care Department at (402) 385-3051 or toll free (888) 425-5382.
- Many Blue Ox[®] Baseplates are designed to use existing holes and hardware to mount the baseplate to the towed vehicle. Even though bolts are there, do not assume they are adequate for baseplate mounting. Always use hardware supplied in the hardware kit and existing hardware specified in the Baseplate Installation Instructions.

Attachment Tab Height: 12"
Attachment Tab Width: 24"

Bolt Torque Specifications
Torque in Foot-Pounds per Metric Bolts

Bolt Size	Grade 8.8	Grade 10.9
6MM	6	8
8MM	16	22
10MM	31	40
12MM	54	70
14MM	89	117

Confirm the towability and pre-towing procedures for your vehicle with the owner's manual or contact the vehicle's manufacturer for specific towing procedures. You can also contact REMCO for additional information at 1(800)228-2481.

Bolt Torque Specifications
Torque in Foot-Pounds per Inch Bolts

Bolt Size	Grade 5	Grade 8
1/4"	10	14
5/16"	19	29
3/8"	33	47
7/16"	54	78
1/2"	78	119
5/8"	154	230

WARNING

Failure to read and follow these instructions could result in separation of the towed vehicle from the tow bar, causing property damage, loss of towed vehicle, personal injury or death.

BX1005 1997 -'99 Acura CL Installation Instructions

Parts List

Ref. No.	Qty.	Part #	Description
1	1	61-5005	Weldment, Baseplate, BX1005
2	1	101-5711	Weldment, DS Brace, BX1005
3	1	101-5712	Weldment, PS Brace, BX1005
4	6		Existing Flat Washer
5	6	203-0131	14MM Lock Washer
6	6		Existing Flat Washer
7	4	201-0446	8MM-1.25 x 30MM, Hex Bolt, Grade 8.8
8	4	203-0102	8MM Lock Washer
9	4	203-0107	8MM Flat Washer
10	4	201-0572	1/2-13 x 1 1/4" Hex Bolt, Grade 8
11	4	203-0012	1/2" Lock Washer
12	4	202-0005	1/2-13 Hex Nut

Tools Required

Metric Wrench Set
Phillips Screwdriver
1/2" Wrench
LOCTITE Red

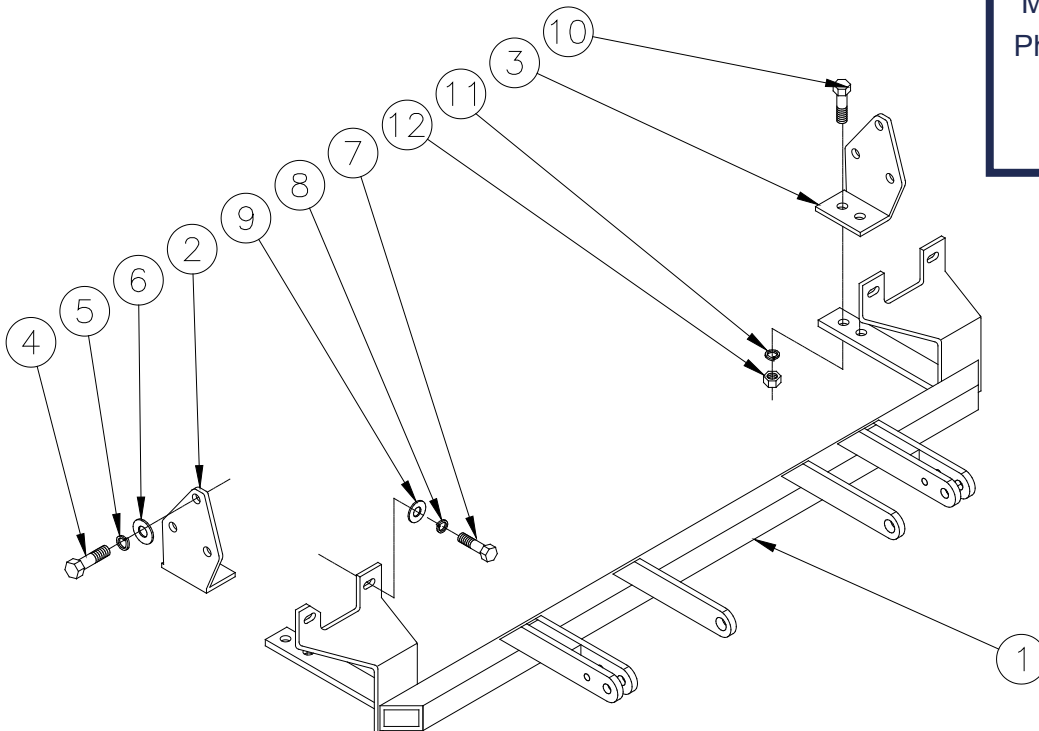

Important:

Use only genuine factory replacement parts on your baseplate. Do NOT substitute homemade or non-typical parts. If a bolt is lost or in need of replacement, for your safety and the preservation of your baseplate, be sure to use a replacement bolt of the same grade (In most cases it will be Grade 5, please reference the parts list above). Replacement parts may be ordered through your nearest Blue Ox® Dealer or Distributor, or call our 24/7 Customer Care Team at (402)385-3051.

BX1005
1997 -'99 Acura CL
Installation Instructions

Standard Tab Spacing Guidelines:

To use certain adapters or a RangeFinder II tow bar in conjunction with standard tab baseplates an additional 5/16" hole must be drilled in the attachment tabs. The Ambassador tow bar will require an adapter for attachment tabs that are not 24" wide. The Adventurer tow bar will require an adapter for attachment tabs that are less than 24" wide. The Acclaim tow bar will not fold and store without the use of an adapter on vehicles with attachment tabs less than 24" wide. The BX88151 adapter cannot be used with this baseplate.

Instructions:

The front fascia is removed and replaced. Drilling is required. Trimming of belly pan is required.

The dimensional variations between otherwise identical vehicles can be considerable. While the baseplate was designed for easy installation, it may be necessary to tailor the baseplate slightly to compensate for auto manufacturer's tolerances. These minor adjustments may include filing a hole slightly, bending electrical rods, and/ or bending end plates.

Installation Instructions

1. Read the Baseplate General Instructions Sheet included with this baseplate.
2. The front bumper molding must be removed for access to the frame.
3. Remove the signal lights on both sides and the signal lights from the socket and detach all wiring. Also remove the plastic top radiator grille cover.
4. Remove the plastic under cover from the vehicle. Save all attachment parts as they will be required for reinstallation.
5. To remove the bumper molding, begin by removing the four Phillips screws holding it to the frame. Also remove the two Phillips screws and the bolts. Set these aside for reinstallation.
6. Remove the tie down brackets located underneath the engine on the insides of the frame by removing the three 14MM bolts existing in the frame. Save all six bolts as they will be required for reinstallation. The two tie down brackets can be discarded at this point. Four 8MM bolts will replace them for the baseplate installation.
7. Remove the lower two bolts on each side from the front bumper bracket plates. The bumper will be attached to the brackets. Remove the bumper by rotating the bottom forward and pulling down and away off of the clips on either side of the vehicle. The four bolts can be discarded at this point. Four 8MM bolts will replace them for the baseplate installation.
8. Set the bumper down and begin separation of the inner and outer bumper by removing eleven plastic rivets, taking care not to destroy them. NOTE: there are two sizes of plastic rivets, these are the larger sized rivets. Carefully separate by rotating the inner bumper from the bottom and pulling out.

BX1005
1997 -'99 Acura CL
Installation Instructions

9. Install the Side Brackets, items 2 and 3, please see the parts list on page 2.
10. Lay the baseplate center tube assembly into the outer bumper shell, then set the inner bumper over the baseplate center tube assembly aligning existing holes with those in the baseplates front bumper brackets.
11. Reinstall the eleven plastic rivets connecting the inner and the outer bumper.
12. Place the bumper up to the vehicle taking care to align the holes in the bumper brackets with those in the vehicle frame. Resetting the outside braces extending from the center tube assembly on the tie down brackets may be helpful. Adjust the center tube assembly so that the front bumper brackets are seated over their brackets. Slide the bumper upward and toward the vehicle, taking care that they are seated over there brackets.
13. When the bumper is properly seated install the 8MM bolts, 8MM washers and 1/2-13 hex nuts through the front bumper brackets into the vehicle frame.
14. Install the two 1/2-13 x 1 1/4" hex bolts, 1/2" lock washers, and 1/2-13 hex nuts, attaching the tie down brackets and the braces coming off the center tube assembly. Install with 1/2" hex nuts on top of the tie down bracket
15. The bottom plastic cover will need to be notched before replacing.
16. Reinstall the bumper molding, plastic under cover and the signal lights.

Install the tow bar and safety cables according to the instructions included in their packages.

Do not substitute other devices if the tow bar pin and clip are lost.

DEALER OR INSTALLER: BE CERTAIN THE USER RECEIVES THE INSTRUCTION SHEETS.

Customer Service Commitment

Blue Ox® is focused on providing exemplary customer service, as observed in our mission statement and guiding principles. In accordance with this objective, Blue Ox® is proud to provide services such as repairs and general maintenance of Blue Ox® products at over 150 RV Rallies. Look for our Destination America or Blue Ox® Racing service crews at the next rally or race that you attend. If you were not present, you will find an informative, personalized note explaining any services that may have been performed to your Blue Ox® products.

Blue Ox® also offers educational seminars at rallies and through our Parks and Resort teams. In addition, Blue Ox® customers visiting our factory may take advantage of the well-equipped Blue Ox® RV park at no charge to you, our valued and appreciated customer.



© 2005 Blue Ox
One Mill Road, Industrial Park
Pender, Nebraska 68047
Phone: (402) 385-3051
Toll Free: (888) 425-5382
Fax: (402) 385-3360
www.blueox.us
292-2245